

The Long Family of Clements Township, Annapolis County, Nova Scotia

Prepared by H. Douglas Goff
7748 Wellington Rd. 22
Guelph, ON N1H 6J2
goff.doug at gmail.com
<http://www.gofffamilyhistory.ca>

Nov. 23, 2019

My grandmother was Hazel (Wright) Goff, a granddaughter of William Oliver Wright and Beulah Elizabeth Long (#8), the daughter of Peter. Hence Peter Long is my 3g grandfather. I have to begin by giving credit to Beulah Jane Wright, River John, NS, my 1st cousin, for doing a considerable amount of original research on this family. I have expanded with the major sources listed below.

I hope this report will be useful to help younger generations connect their parents and grandparents to the original family. *Please note that corrections or additions are always welcome!*

Index, page 65.

Major Sources

1. Long, Ruth Alicia and Edna Long Davis. 1987. Langley - Long, Massachusetts - Nova Scotia, 1630 - 1987. Private Printing. Needham, Mass. This annotated family history has a wealth of information and stories on the family of William Bennet Long and his son William "Harris" Long.
2. Hegerich, Bob. 2019. The family of William B. Long.
<https://www.bobhegerich.com/getperson.php?personID=I35745&tree=Main>
3. Calnek, W. A. and A. W. Savary, 1897, History of the County of Annapolis, and 1913, Supplement, William Briggs Ltd., Toronto. Reprinted by Mika Studio, Belleville, ON 1972.
4. Nova Scotia Historical Vital Statistics (NSHVS) – birth, marriage and death data.
<http://www.novascotiagenealogy.com>
5. Nova Scotia census data <http://www.bac-lac.gc.ca/eng/census/Pages/census.aspx>
6. United States b,m,d and census data. <http://www.familysearch.org>
7. Clementsvale Cemetery records -
<http://www.rootsweb.ancestry.com/~nsannapo/cemeteries/clementsvale.html>

Long Family of Annapolis County, NS

First Generation

1. Jacob Lange.

John Jacob Long from Prussia was named as the father of Peter in the Chute genealogy.

Jacob Long was listed as a tax paying resident of Clements Township under the 1791 Capitation Tax Act (Calnek pages 251, 252), and is in the 1827 census of Clements, Methodist, family of four males and two females. Jacob Long and Peter Long are the only two Long's in the 1827 census for Clements Township.

Lois Jenkins, historian, of Clementsvale, confirmed that Jacob Peter Lange, originally of Waldeck, Germany, received a land grant on the Hessian Line for his service to the British. He subsequently anglicized his name to Long, and was the father of Peter Long. Waldeck, a former principality in present-day Hesse and Lower Saxony, maintained a militia for foreign service and supported King George III with 1200 soldiers during the American Revolution. Waldeck soldiers served alongside those from Hessen-Kassel, together they were known as the Hessians. Altogether there were some 30,000 Germans fighting in the American Revolution, most in the colonies but some deployed in Canada.

From Calnek and Savery, History of Annapolis County, 1897, "Two settlements, the Waldeck Line and the Hessian Line (now Clementsvale), were originally begun by the disbanded Waldecker and Hessian soldiers, who sought refuge here at the close of the Revolutionary War, after the peace of 1783. These settlements are formed on lines parallel to each other and two miles apart, their direction being nearly east—west, and are still, in part, cultivated by their descendants, who are now scarcely distinguishable by the other inhabitants by language or custom. Inter-marriages with the settlers of British origin have been constant and common."

From Lois Jenkins, "Jacob Peter Long, or Lange as his name appears in a 1784 muster roll, was one of the disbanded German soldiers; he belonged to a Waldeck regiment. His early role in the story of Clements is perhaps a unique one. Since he was married when he arrived, he was entitled to 150 acres of land. (The allotment was to be 100 acres per man, plus 50 acres each for wife and children.) He was initially granted a 100-acre lot in the Hessian Line. He made a petition (called a memorial) to Governor Sir John Wentworth in 1799 concerning the additional 50 acres: The Memorial of Jacob Long, Humbly sheweth That your memorialist served during the late war in America as a rifleman in Colonel Worms [sic] Battalion of jaegers and at the peace of 1783 came with his family to this province to settle and to obtain His Majesty's gracious bounty in land: That your memorialist was informed that he was intitled to one hundred and fifty acres of land, of which he first drew one hundred, viz. No.31 in the Hessian line in the Township of Clements; but this in the early settlement of the country being out of the way, your memorialist settled in the town plot of Digby, pursuing his trade as a carpenter and there had assigned him other land in the Township of Digby by the agents, viz. No.5 in the letter B which contained about fifty acres making up your memorialists complement as a disbanded soldier with a family; That your memorialist, as soon as his circumstances would permit, settled upon his first lot in the Hessian line where he has continued to this day, and has made improvements according to the utmost of his ability, to put that lot in good order, That your memorialist is now desirous of settling his lot No.5 letter B in Digby, but finds it reported vacant by the Commissioners, and also find many applicants . . . who lay claim to it; That your memorialist not being named in any grant of land in the Township of Digby is hereby in Danger of losing his land, and therefore humbly prays that your Excellency & Honour will be pleased to confirm his title, if in your wisdom you shall think the same right; and your memorialist as in Duty Bound will ever pray [Signed] Peter Long Digby 1st Oct 1799. It appears as though Long may not have succeeded in acquiring title to his Digby lot, as he was still living on the Hessian Line when his application to operate a "house of entertainment – license free – in the Hessian Line, Clements" was presented to the Annapolis County Court in April 1802. These "houses of entertainment" were actually stage-coach stops along the route from Annapolis to Digby and beyond." There was a Hessian Line & a Waldeck Line, along which lots were initially

Long Family of Annapolis County, NS

granted to soldiers from the various German regiments. However, within 10 years the majority of them had left the area.”

Child:

- 2 i. **Peter Long** (1786-11 Jan 1858)

Second Generation

Family of Jacob Peter Lange (1)

2. Peter Long (*Jacob Peter Lange*¹). Born in 1786 in Annapolis Co., NS. Peter died in Clementsvale, Annapolis Co., NS, on 11 Jan 1858; he was 72.

There were several Long loyalists from U.S. to New Brunswick and Nova Scotia. Peter's father was a disbanded German soldier who had fought for the British in the American revolution. Lewis Mortimer Long, Peter's grandson, referred to his lineage as son of John Henry, of Peter, of John Jacob of Prussia. The family origin was stated as "German" in early census records. Peter Long received a land grant in Clements (200 acres, Sheet 21, Crown Land Information Centre) between the grants of Jonathan Milner Sr. (500 acres) and Benjamin Potter (200 acres). Peter is in the 1827 census of Clements, Methodist, four sons and three daughters (5 males and 4 females).

In 1807 when Peter was 21, he first married **Martha Langley**¹, daughter of **John Jr. Langely** (-1822) & **Beulah Winchester** (bef 1756-). Born in 1788. Martha died in Clementsvale, Annapolis Co., NS, on 21 Feb 1835; she was 47.

Martha, daughter of John and Beulah Langley was a first cousin of Martha, daughter of Aquilla and Mary Langley. One Martha married Peter Long, the father, and the other married William Bennett Long, the son.

¹ Martha Langley's family settled in Annapolis County from the New England States, hence her ancestry includes many of the founding families of Massachusetts Bay Colony in the early 1600s. For the ancestry of Martha, as I have recorded it, please see my report at: <http://www.gofffamilyhistory.ca/LongLangleyAncestryAnnapolisNovaScotia.pdf>

Long Family of Annapolis County, NS

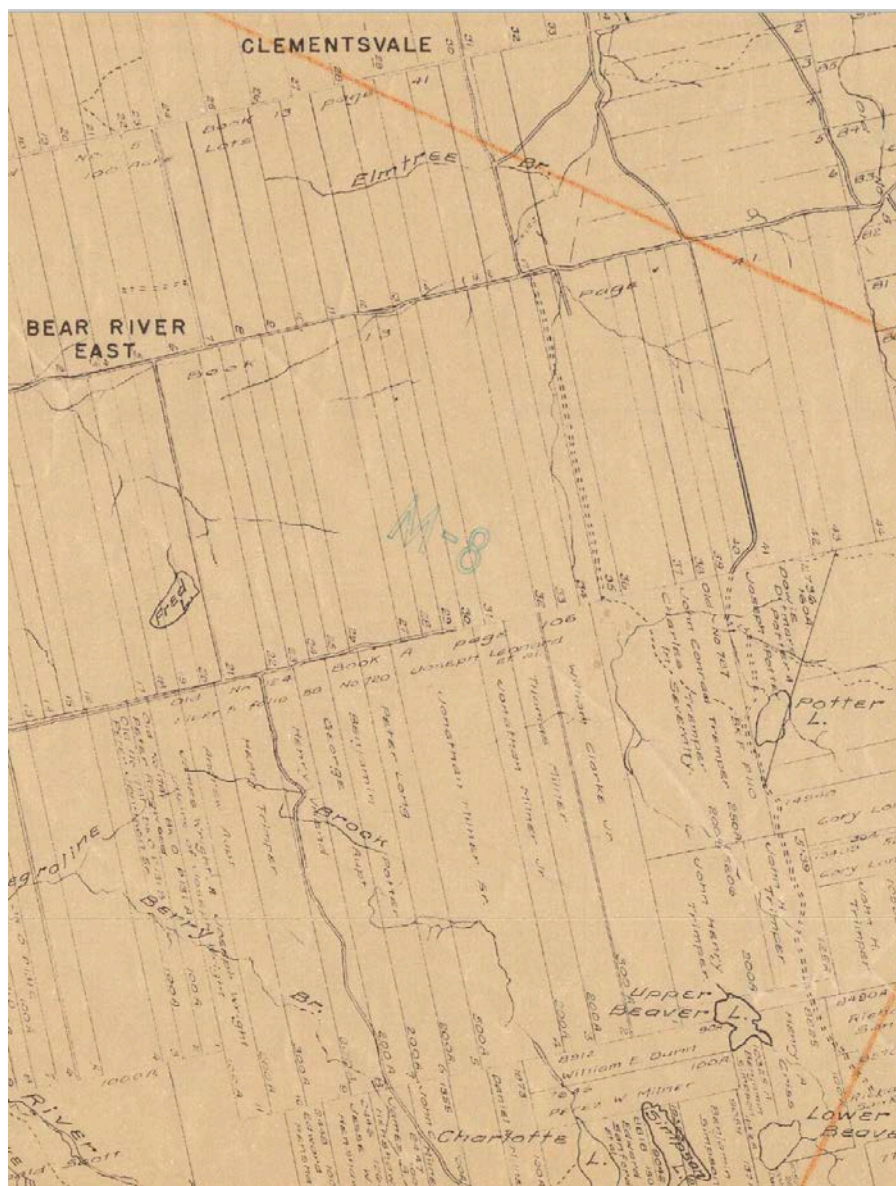

Crown Land Information Management Centre, Sheet 21, <http://novascotia.ca/natr/land/grantmap.asp>

They had the following children:

- 3 i. **Jacob** (1807-1 Apr 1887)
- 4 ii. **William Bennett** (19 Aug 1811-12 Oct 1894)
- 5 iii. **Margaret Ann** (1818-21 Oct 1869)
- 6 iv. **Ephraim Daniels** (4 May 1819-19 Oct 1874)
- 7 v. **Lydia Jane** (14 Aug 1820-11 Aug 1908)
- vi. **George Dexter**. Born in 1823. George Dexter died in Hillsburg (Bear River), N.S., on 18 Aug 1855; he was 32.
- 8 vii. **Beulah Elizabeth** (7 Nov 1825-21 Dec 1902)
- 9 viii. **John Henry** (1826-1900)

Long Family of Annapolis County, NS

- ix. **Joel.**
- x. **Fletcher.**
- xi. **Henry F.** Born in 1834. At the age of 4, Henry F. was baptized on 31 Dec 1838. Henry F. died on 16 Nov 1863; he was 29. Buried in Clementsvale Cemetery (“aged 29 years”). Baptized Dec. 31, 1838, Annapolis Records, however mother died in 1835.

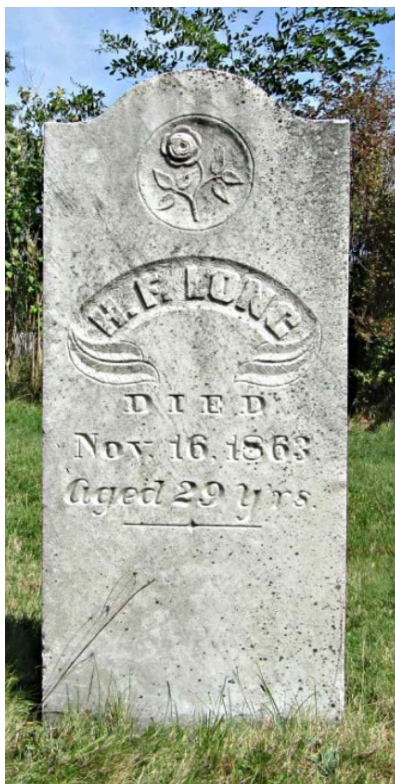

On 13 Jun 1841 when Peter was 55, he second married **Elizabeth (Brotha) Orde** in Clements, Annapolis Co., NS.

Third Generation

----- Family of Peter Long (2) & Martha Langley

3. Jacob Long (*Peter², Jacob Peter Lange¹*). Born in 1807. Jacob died on 1 Apr 1887; he was 80. Buried in Clementsvale Cemetery.

Jacob may be a son or a brother of Peter. There was 21 years difference, so could be either. In his marriage in 1825,

Long Family of Annapolis County, NS

he was named as “Jacob Jr.”, although this is not seen in any other records. The Long genealogy (Long and Davis, 1987) records this Jacob but without confirmation of relationship to Peter. However, they also list a Jacob as a son of Peter, with no further information.

1871 census Hessian Line Long Jacob 63 Rachel 48 Zuraah (F) 35 Alden 10 Jane 6.

1881 census Hessian Line Long Jacob 71 Rachel A. 63 Zarie (F) 47 Aldin R. 20 Jane E. 16.

Jacob Long Jr., farmer of Clements (1807-Apr. 1, 1887), md. Feb. 3, 1822 Ann M. Trimper (1803-Aug. 2, 1856). Children: Martha, 1830-1912, md. Henry Brown*; Izaruh Elizabeth, bapt. Nov. 4 1834; William Dennison, bapt. Oct. 17, 1836; Rebecca Lucinda, bapt. Nov. 18, 1839, d. Apr. 28, 1936, md. Charles Trimper (Set. 12, 1842-Nov. 11, 1921), for years the Clementsvale postmistress; Jacob Allen, b. 15 Feb 1843, d. Nov. 16, 1863, age 29.³¹ The names of Anna Catherine and Hannah Maria Faith came from Beulah Wright.

*Martha was the grandmother of Wellington (“Wellie”) Brown of Spring Hill, Annapolis Co., a well-known sports guide in the area. He had a large cooking pot which he claimed the first Long’s brought with them from Holland, which may fit in with Chute’s listing of John Jacob Long as being from Prussia, and census records of family origins as German. Wellie remembers his grandmother Martha had a brother John who had gone to the United States. He remembered his Uncle’s visits to his N.S. home.³¹

Marriage (1) 3 Feb 1825, by banns, by Rev. John Millidge of Annapolis, Jacob Long, Junior of the Parish of Clements, and Ann Trimper of the Parish of Clements; witnesses: John Trimper and Charles Trimper (Annapolis, St. Luke's Parish, Register of Marriages, page 49, no. 147)

Marriage (2) 18 Jan 1860, by Rev. James Taylor, Wesleyan, Jacob Long of Hessian Line, widower, and Rachel Ann Simmons, widow. (Annapolis Royal, St. George and St. Andrews United Parish Register)

Rachel, Alden and Jane are a second family. Alden is named as son of Jacob and Ann (NSHVS), but he was born in 1860, so must be Rachel Ann Simmons rather than Ann Trimper.



Long Family of Annapolis County, NS

On 3 Feb 1825 when Jacob was 18, he first married **Anne M. Trimper**, daughter of **John Conrad Trimper** (1787-1871) & **Elche Milner** (ca 1784-). Born in 1804. Anne M. died in Clementsvale, Annapolis Co., NS, on 3 Aug 1856; she was 52.

Marriage witnesses, John Trimper and Charles Trimper, St. Edwards Church, Clementsport.³¹
Ann M., wife of Jacob Long, d Aug 2, 1856 aged 53 (Clementsvale Cemetery)

They had the following children:

- i. **Anna Catherine**. Born in 1827. Anna Catherine died on 20 Nov 1869; she was 42.
- 10 ii. **Martha** (1830-5 Jul 1918)
- iii. **Hannah Maria Faith** (Died as Infant). Born in 1831. Hannah Maria Faith died in 1831; she was <1.
- iv. **Zuriah Elizabeth**. Born in 1834.
- 11 v. **William Dennison** (12 Aug 1836-28 Aug 1914)
- vi. **Rebecca Lucinda**. Born on 18 Nov 1840. Rebecca Lucinda died in Clementsvale, Annapolis Co., NS, on 28 Apr 1930; she was 89.

Meredith Glidden (b. 1881), Somerville, Mass., daughter (informant).

On 9 May 1866 when Rebecca Lucinda was 25, she married **Charles Wallace Trimper**, son of **John Henry Trimper** (20 Jun 1824-) & **7. Lydia Jane Long** (14 Aug 1820-11 Aug 1908), in Clements, Annapolis Co., NS. Born on 12 Sep 1842. Charles Wallace died on 11 Nov 1921; he was 79.

1891 census Clementsvale Trimper Charles 48 Rebecca 51 Ezbon 13 Meredies 10.
Charles W. Trimper, Sep 12, 1842-Nov 11, 1921; Rebekah L. (Long) Trimper, Nov 18, 1839-Apr 26, 1930; Ezbon L. Trimper, June 28, 1877-Mar 15, 1892 (Clementsvale Cemetery)

- vii. **Jacob Allen**. Born on 15 Feb 1843. Jacob Allen died on 16 Nov 1863; he was 20.

On 18 Jan 1860 when Jacob was 53, he second married **Rachel Ann Simmons** in Annapolis Royal, NS. Born 1819. 1891 census Bear River Long Alden 30 Martha 27 Oscar 7 Lottie 5 Ann (widow) 72.

They had the following children:

- 12 i. **Alden E.** (14 Sep 1858-)
- ii. **Amaret "Jane"**. Born in 1864 in Clementsvale, Annapolis Co., NS. Amaret "Jane" died on 8 Nov 1885; she was 21. Buried in Clementsvale Cemetery.

d/o Jacob and Annie (NSHVS)

On 14 Nov 1883 when Amaret "Jane" was 19, she married **James Wallace Berry** in Hillsburg (Bear River), N.S. Born on 6 Jul 1861. James Wallace died in St Anthony, Annapolis Co., NS, on 13 Feb 1951; he was 89.

s/o Jesse Berry annd Charlotte Ritchie
William Cummings, son-in-law.

4. William Bennett Long (*Peter², Jacob Peter Lange¹*). Born on 19 Aug 1811 in Bear River East, N.S. William Bennett died in Bear River East, N.S., on 12 Oct 1894; he was 83. Buried in Clementsvale Cemetery. Occupation: Wheelwright.

Long Family of Annapolis County, NS

1871 census Hessian Line Long William 59 Elizabeth 39 Preastley 20 Roby 18 Altha 16 Jacob 14 Corey 13 Martha 11 Fletcher 9 Jane 7 Joel 5 Emmerson 4 Warren 2 John 3/12.

1881 census Hessian Line Long William 69 Rebecca E. 50 Fletcher 19 Martha 17 Lovell 15 Emmerson 14 Warren 12 Bennet 10 Manning 7.

Ruth Alicia Long and Edna Long Davis relate a family story that William Bennett Long may have been adopted by Peter and Martha Long as a result of being orphaned from a ship wreck, and that his surname may have been Atkinson or Atkins. There is no documented proof of this legend, although it was retold by several of the older family members.³¹

William Bennett first married **Martha Langley**, daughter of **Acquila Langley & Mary Chute**. Born on 9 Nov 1819. Martha died abt 1846; she was 26.

Martha, daughter of John and Beulah Langley was a first cousin of Martha, daughter of Aquilla and Mary Langley. One Martha married Peter Long, the father, and the other married William Bennett Long, the son.³¹

They had the following children:

- | | | |
|-----------|------|---|
| 13 | i. | James "Milledge" (ca 1841-15 Mar 1887) |
| | ii. | Ezekiel Chipman (Died as Child). Born ca 1841 in Bear River East, N.S. Ezekiel Chipman died in The Mill Pond, Bear River East, N.S., abt 1845; he was 4. |
| 14 | iii. | Mary Lavinia (8 Mar 1842-6 Nov 1922) |
| 15 | iv. | William "Harris" (12 Apr 1844-15 May 1918) |
| 16 | v. | Charles Augustus (8 Apr 1846-25 Feb 1943) |



Long Family of Annapolis County, NS

On 22 Dec 1849 when William Bennett was 38, he second married **Rebecca Elizabeth (Betsy) Berry**. Born on 24 Mar 1838. Rebecca Elizabeth (Betsy) died in Clementsvale, Annapolis Co., NS, on 28 Mar 1910; she was 72.

They had the following children:

- 17** i. **Priestley** (6 Dec 1851-25 Nov 1920)
- 18** ii. **Thomas Roby** (3 Jul 1852-23 Jul 1884)
- iii. **Charlotte** (Died as Child). Born on 29 Aug 1853. Charlotte died on 29 Jul 1857; she was 3.
- 19** iv. **Althea Ann** (22 Apr 1855-26 Jun 1894)
- 20** v. **Jacob Whitman** (17 Sep 1856-11 Nov 1934)
- 21** vi. **Corey O'Dell** (22 Apr 1858-24 May 1935)
- 22** vii. **Martha B.** (12 Dec 1859-13 Aug 1909)
- 23** viii. **Henry "Fletcher"** (8 Dec 1860-2 Oct 1929)
- ix. **Jennie Emma**. Born on 29 Jul 1862. Jennie Emma died in Lynn, Essex Co., Mass., on 9 Apr 1913; she was 50. Buried in Pine Grove Cemetery, Lynn, MA.

On 20 Feb 1884 when Jennie Emma was 21, she married **Demont Lee Stockbridge** in Cambridge, Middlesex, Mass. Born on 25 Jul 1865 in Swan Island, Maine. Demont Lee died in Lynn, Essex Co., Mass., in 1938; he was 72.

- 24** x. **Joel Daniel** (27 Sep 1865-2 Jun 1948)
- xi. **Joseph "Warren"**. Born on 21 Nov 1868 in Clementsvale, Annapolis Co., NS. Joseph "Warren" died in 1889; he was 20.
- 25** xii. **Daniel "Emerson"** (19 Feb 1869-8 Sep 1945)
- 26** xiii. **John Bennett ("Ben")** (31 Dec 1871-10 Jan 1927)
- 27** xiv. **Wesley "Manning"** (15 May 1874-6 Apr 1961)

5. Margaret Ann Long (*Peter², Jacob Peter Lange¹*). Born in 1818. Margaret Ann died in Bear River, NS, on 21 Oct 1869; she was 51.

Marriage bond signed by Peter Long and John Long. John Long and Wm. Dukeshire were marriage witnesses. Peter Long named as father on death registration (NSHVS).

On 5 Nov 1838 when Margaret Ann was 20, she married **William Henshaw**.

They had the following children:

- i. **Ida A.** Born in 1846 in Bear River East, N.S. Ida A. died in Boston, Mass, on 20 Jul 1909; she was 63.
- Mrs. James E. Caldwell.
- ii. **Ruby Ester**. Born on 5 Mar 1848. Ruby Ester died in Springfield, Anna. Co., N.S., on 1 Mar 1920; she was 71.

Parents named as William and Margaret Ann (Long). Irving Mason, son-in-law.

On 13 Jun 1869 when Ruby Ester was 21, she married **James Edward Wentzell** in Hillsburg (Bear River), N.S.

6. Ephraim Daniels Long (*Peter², Jacob Peter Lange¹*). Born on 4 May 1819. Ephraim Daniels died in Clementsvale, Annapolis Co., NS, on 19 Oct 1874; he was 55.

Marriage witnesses George Dexter Long, Jacob Long, George Hines, Esther Wright. George Dexter and Jacob are

Long Family of Annapolis County, NS

brothers of Ephraim.

1871 census Hessian Line, Annapolis Co., Long Ephraim 51 Jane E 51 George 19 Sarah 16 Effie 13 Ella 11 Catherine 9 Gilbert 6.

Some of the details of this family comes from ³¹

On 3 Feb 1845 when Ephraim Daniels was 25, he married **Jane Elizabeth Hines**. Jane Elizabeth died in Clementsvale, Annapolis Co., NS. Born in 1820.

They had the following children:

- 28** i. **Melinda** (1845-30 Dec 1912)
- 29** ii. **Janette** (5 Mar 1847-23 Mar 1930)
- 30** iii. **Joshua Freeman** (1850-4 Dec 1913)
- 31** iv. **George Hines** (20 Jan 1852-30 May 1920)
- 32** v. **Sarah** (1855-1925)
- 33** vi. **Effie** (1858-)
- 34** vii. **Ella S.** (3 Jun 1860-10 Nov 1937)
- viii. **Kate**. Born in 1862 in Clementsvale, Annapolis Co., NS.
- ix. **Gilbert**. Born in 1865 in Clementsvale, Annapolis Co., NS. Gilbert died in 1884; he was 19.

7. Lydia Jane Long (*Peter², Jacob Peter Lange¹*). Born on 14 Aug 1820. Lydia Jane died in Clementsvale, Annapolis Co., NS, on 11 Aug 1908; she was 87.

On 2 Dec 1841 when Lydia Jane was 21, she married **John Henry Trimper**, son of **John Conrad Trimper** (1787-1871) & **Elche Milner** (ca 1784-). Born on 20 Jun 1824.

They had the following children:

- i. **Charles Wallace**. Born on 12 Sep 1842. Charles Wallace died on 11 Nov 1921; he was 79.

1891 census Clementsvale Trimper Charles 48 Rebecca 51 Ezbon 13 Meredies 10.
Charles W. Trimper, Sep 12, 1842-Nov 11, 1921; Rebekah L. (Long) Trimper, Nov 18, 1839-Apr 26, 1930; Ezbon L. Trimper, June 28, 1877-Mar 15, 1892 (Clementsvale Cemetery)

On 9 May 1866 when Charles Wallace was 23, he married **Rebecca Lucinda Long**, daughter of **3. Jacob Long** (1807-1 Apr 1887) & **Anne M. Trimper** (1804-3 Aug 1856), in Clements, Annapolis Co., NS. Born on 18 Nov 1840. Rebecca Lucinda died in Clementsvale, Annapolis Co., NS, on 28 Apr 1930; she was 89.

- ii. Meredith Glidden (b. 1881), Somerville, Mass., daughter (informant).
- 35** ii. **John Edward** (14 Apr 1843-7 Jul 1916)
- iii. **George "Fletcher"**. Born on 27 Jan 1854. George "Fletcher" died in Clementsvale, Annapolis Co., NS, on 24 Dec 1915; he was 61.

1891 census Clementsvale Trimper Fletcher 37 Mary 33 Agnes 12 Henry 10.
In 1901, Fletcher was living with brother Thomas. Mary, Agnes and Henry were not with him.

On 3 May 1877 when George "Fletcher" was 23, he married **Mary Magdeline Milner**,

Long Family of Annapolis County, NS

- daughter of **Joshua Milner** (21 May 1816-1899) & **Sarah Hines** (ca 1831-1900). Born ca 1858 in Clementsvale, Annapolis Co., NS.
- 36 iv. **Hallett Ray** (7 Mar 1858-10 Jul 1914)
37 v. **Thomas Henry** (14 Mar 1862-Aug 1939)

8. Beulah Elizabeth Long (*Peter², Jacob Peter Lange¹*). Born on 7 Nov 1825 in Clementsvale, Annapolis Co., NS. Beulah Elizabeth died in Clementsvale, Annapolis Co., NS, on 21 Dec 1902; she was 77.

Beulah and her sister, Lydia Jane Trimper, both widows, shared a home in Clementsvale, where they each had a grandchild to raise. Beulah brought up her grandson Clarence Wright, who later must have rejoined his family in the USA. Lydia's son, Thomas Trimper married Beulah's only daughter Elena Jane Wright, his first cousin. They had a son George, followed by twin daughters, Elena and Huldah, and Jane did not survive their birth. Elena died within a few months, so Huldah, and probably her brother George also were taken in by their grandmother Lydia. Huldah succumbed to consumption at age twelve. Beulah was said to be a good-natured woman who loved to laugh. She is buried in the cemetery, beside her husband, though her name has never been added to the headstone.

1891 census Bular Widow 67 Howard 22 Clarence 13. And on the same page Wright James E 40 Domestic is with Thomas Trimper 29 Head of Household George W 2 and Hattie V 7/12, also Daniel P Millner 79 Widow, Labourer (who would be a great-uncle)

Beulah, age 76, is in the 1901 census with son Edgar, age 48. They are beside Thomas Trimper, head, age 39, with mother Lydia, 80, son George, 12, and brother Fletcher, 47.

On 4 Mar 1851 when Beulah Elizabeth was 25, she married **William Oliver Wright**, son of **Ward Sneden Wright** (1806-6 Mar 1886) & **Hannah (Anna) Milner** (8 Oct 1804-27 Sep 1885). Born on 16 Oct 1831 in Clementsvale, Annapolis Co., NS. William Oliver died in Clementsvale, Annapolis Co., NS, on 10 Mar 1889; he was 57. Buried in Clementsvale Cemetery. Occupation: Farmer; Cattle Drover. Religion: Baptist.

1871 Annapolis Co. Nova Scotia census, Hessian Line, Annapolis, Nova Scotia: William 40 Beulah 46 Edgar 18 Alonzo 16 Charles 15 Harvey 10 Peter 9 George 5 Howard 3 Jane 1.

They had the following children:²

- i. **James Edgar**. Born on 7 Mar 1853.

There is a James E Wright, Single, died Dec. 5, 1918, Bridgetown, NS, ae 71, son of W. Wright, born Clementsport, NS, baptist, in the NS Historical Vital Statistics. There is also a James Wright in the 1911 census in Bridgetown, b. 1849, ae 62, single, as an inmate in some institution. This may be the same person, but the birth date I have for James Edgar doesn't match the census age or age at death.
- ii. **Leander "Alonzo"** (1 Aug 1854-6 Mar 1925)
- iii. **Charles Elkaneh** (16 Feb 1856-20 Mar 1895)
- iv. **Harvey W.** (29 Jul 1860-21 Jan 1932)
- v. **Peter Elsworth** (23 Mar 1862-14 Dec 1938)
- vi. **George Davenport** (19 Mar 1866-9 Sep 1931)

² For the descendants of Beulah Elizabeth Long and William Oliver Wright, please see my detailed report at:

<http://www.gofffamilyhistory.ca/WrightFamilyClementsAnnapolisNovaScotia.pdf>

I won't repeat it all here.

Long Family of Annapolis County, NS

- vii. **Rev. Howard St. Clair.** Born on 26 Jul 1867 in Clementsvale, Annapolis Co., NS. Howard St. Clair died in Clementsvale, Annapolis Co., NS, on 7 Jul 1893; he was 25. Buried in Clementsvale Cemetery. Occupation: Minister. Religion: Baptist. Residence: Clementsvale, NS. He was never married.

Cause of death: tuberculosis

- viii. **Elena Jane** (28 Aug 1869-Sep 1890)
ix. **Clarence Bertram** (10 Jul 1879-)

9. John Henry Long (*Peter², Jacob Peter Lange¹*). Born in 1826. John Henry died in 1900; he was 74.

1871 census Hessian Line Long John H 44 Amelia 37 James 14 Annie 10 Mortimer (M) 9 Amerilla (F) 5.
Lewis Mortimer Long had named his grandfather as Peter.

1881 census Hessian Line Long John H. 55 Caroline A. 48 James W. 23 Lewis M. (Mortimer) 18 Nelie 14.
Clementsvale Cemetery Long Caroline A. (Sproule), wife of John H. Long, d at Cambridgeport, Mass. Feb 3, 1888 aged 55; John H. Long 1826-1900

Long Annabella b. 21 May 1866 d/o John H. Long (ship's carpenter) and Caroline A. Sproule, md. 4 Jun 1855 Nictaux

Beulah Wright had named two sons of John as John James and John Balcom Long, md. to Eva Potter. This information, however, is unconfirmed.

On 4 Jun 1855 when John Henry was 29, he married **Caroline Amelia Sproule** in Nictaux, Annapolis Co., NS. Born in 1833. Caroline Amelia died on 3 Feb 1888; she was 55.

They had the following children:

- i. **James W.** Born in 1857.
ii. **Annie.** Born in 1861 in Nictaux, Annapolis Co., NS.

d/o John and Amelia (NSHVS marriage)

On 11 Mar 1879 when Annie was 18, she married **Edward E. Chute** in Hillsburg (Bear River), N.S. Born in 1858.

s/o John and Elizabeth

- 45 iii. **Lewis "Mortimer"** (17 Nov 1863-6 Oct 1912)
iv. **Amerilla.** Born on 21 May 1866.

Fourth Generation

Family of Jacob Long (3) & Anne M. Trimper

Long Family of Annapolis County, NS

10. Martha Long (*Jacob³, Peter², Jacob Peter Lange¹*). Born in 1830 in Clementsvale, Annapolis Co., NS. Martha died in West Springhill, Annapolis Co., on 5 Jul 1918; she was 88.

Martha married **Henry Brown**. Born on 4 Apr 1831. Henry died in West Springhill, Anna. Co., NS, on 26 Jun 1920; he was 89.

1871 census Hessian Line Brown Henry 39 Martha 39 Herman 7 George 5.

1881 census Annapolis Royal Brown Henry 49 Martha 49 Herman 17 George 15.

1891 census West Milford Annapolis Co. Brown Henry 59 Martha 59 Herman 27 Bessie 17 George 25 Lizzie 18.

They had the following children:

- 46** i. **Herman Augustus** (2 Dec 1863-29 Apr 1936)
- 47** ii. **George Henry** (5 Sep 1865-30 Dec 1945)

11. William Dennison Long (*Jacob³, Peter², Jacob Peter Lange¹*). Born on 12 Aug 1836. At the age of <1, William Dennison was baptized on 17 Oct 1836. William Dennison died on 28 Aug 1914; he was 78.

1871 census Hessian Line (beside Jacob) Long William 36 Sarah 43 Martha 10.

1881 census Hessian Line (beside Jacob) Long William D. 45 Sarah 52 Cory (M) 22 Martha B. 21. Note: Cory was son-in-law.

Clementsvale Cemetery William D. Long, d Aug 28, 1914 aged 78; Sarah Jane (Sproule), wife, d Sep 1. 1916 aged 89 yrs 6 mo

William Dennison married **Sarah Jane Sproule**. Born on 4 Mar 1827. Sarah Jane died on 1 Sep 1916; she was 89.

They had one child:

- i. **Martha B.** Born in 1860 in Nictaux, Annapolis Co., NS. Martha B. died on 16 Sep 1885; she was 25.

Martha B. wife of Cory Long d Sep 16, 1885 aged 25.

Martha B. is a granddaughter of Jacob Long Jr. ³¹ (See #2857)

On 14 Dec 1879 when Martha B. was 19, she married **Corey O'Dell Long (21)**, son of **4. William Bennett Long** (19 Aug 1811-12 Oct 1894) & **Rebecca Elizabeth (Betsy) Berry** (24 Mar 1838-28 Mar 1910), in Clementsvale, Annapolis Co., NS. Born on 22 Apr 1858 in Clementsvale, Annapolis Co., NS. Corey O'Dell died on 24 May 1935; he was 77.

Clementsvale Cemetery Corey O. Long, 1859-1935; wife Ella M. (Beeler) 1863-1936; J. Parker, 1895-1956; Florence M. (Beeler) Pyne 1860-1935, wife of Thomas Pyne

Family of Jacob Long (3) & Rachel Ann Simmons

12. Alden E. Long (*Jacob³, Peter², Jacob Peter Lange¹*). Born on 14 Sep 1858 in Clementsvale, Annapolis Co., NS.

s/o Jacob and Ann (NSHVS). it appears his mother Ann was with him in 1891.

1891 census Bear River Long Alden 30 Martha 27 Oscar 7 Lottie 5 Ann (widow) 72.

Long Family of Annapolis County, NS

On 13 Nov 1881 when Alden E. was 23, he married **Martha B. Long (22)**, daughter of **4. William Bennett Long** (19 Aug 1811-12 Oct 1894) & **Rebecca Elizabeth (Betsy) Berry** (24 Mar 1838-28 Mar 1910), in Clementsport, Annapolis Co., NS. Born on 12 Dec 1859 in Clementsvale, Annapolis Co., NS. Martha B. died in Annapolis Co., NS, on 13 Aug 1909; she was 49. Buried in Bear River Mount Hope Cemetery.

They had the following children:

- i. **Oscar Edward**. Born on 17 Mar 1883 in Bear River, Digby Co., NS. Occupation: Blacksmith.

On 18 Aug 1904 when Oscar Edward was 21, he married **Jennie E. Ginniman** in Clementsport, Annapolis Co., NS. Born in 1881 in Newcastle, NB.
- ii. **Lottie May**. Born on 22 May 1886. One her marriage register, d/o Addline Long, mother deceased.

On 29 Dec 1909 when Lottie May was 23, she married **Albert Fletcher McNeill** in Bear River, NS. Born in 1876, s/o Albert and Cecilia McNeill, widower at time of marriage to Lottie.

Family of William Bennett Long (4) & Martha Langley

13. James “Milledge” Long (*William Bennett³, Peter², Jacob Peter Lange¹*). Born ca 1841. At the age of <1, James “Milledge” was baptized on 14 Feb 1841. James “Milledge” died on 15 Mar 1887; he was 46. Buried in Clementsvale Cemetery.

1871 census Hessian Line Long Milledge 28 Rebecca 25 Avar 2 Milly 1/12.

1881 census Hessian Line Long Milledge 40 Rebecca 33 Avar 12 Carrie (F) 10.

On 15 Dec 1864 when James “Milledge” was 23, he married **Rebecca Burrell** in Annapolis, NS. Born in 1846. Rebecca died on 12 Jun 1904; she was 58. Buried in Clementsvale Cemetery.

Sister of William Burrell who married James Milledge’s sister Mary Long.³¹

They had the following children:

- i. **Avar C**. Born on 12 Jan 1869 in Clementsvale, Annapolis Co., NS. Avar C. died on 28 Mar 1924; he was 55. Buried in Holderness, New Hampshire.
- ii. **Carrie E**. Born on 23 Mar 1871 in Clementsvale, Annapolis Co., NS. She was never married.

14. Mary Lavinia Long (*William Bennett³, Peter², Jacob Peter Lange¹*). Born on 8 Mar 1842 in Bear River East, N.S. Mary Lavinia died in Bear River East, N.S., on 6 Nov 1922; she was 80.

Mary Lavinia married **William H. Burrell**. William H. died in Bear River East, N.S., on 1 Jun 1919; he was 79. Born on 3 Mar 1840. Residence: Middlesex Road, Bear River East.

Brother of Rebecca Burrell who married Mary’s brother James Millidge Long.

They had the following children:

- i. **Martha “Lavinia”**. Born on 22 Mar 1866 in Bear River East, N.S. Martha “Lavinia”

Long Family of Annapolis County, NS

died in 1961; she was 94.

In 1888 when Martha "Lavinia" was 21, she married **Everett Barnes**.

- ii. **Stillman**. Residence: Upper New York State.
- iii. **Abigail**. Residence: Dorchester, Mass.
- iv. **John**. Born on 23 Mar 1885 in Bear River East, N.S. John died in 1957; he was 71.

John married **Eva H. Burrell**. Born in 1880.

15. William "Harris" Long (*William Bennett³, Peter², Jacob Peter Lange¹*). Born on 12 Apr 1844 in Bear River East, N.S. William "Harris" died on 15 May 1918; he was 74.

1881 census Clementsport Long Harris 39 Saphronia 39 Daniel 14 Frederick 11 Mabel 5 Willie (? M) 3

Clementsvalle Cemetery. William H. Long, Apr 12, 1844 - May 15, 1918; Saphronia A., wife, 1848-1941; Harry S. Long 1886-1962; wife Gladys J. 1893-1993; Darrell D., Apr 16, 1918 - May 2, 1988

On 26 Nov 1864 when William "Harris" was 20, he married **Saphronia Ann Milbury**, daughter of **Fletcher Milbury & Sarah Jane Sproule** (4 Mar 1827-1 Sep 1916), in Clements, NS. Born on 11 Mar 1847. Saphronia Ann died in Deep Brook, Anna. Co., N.S., on 8 Jan 1941; she was 93. Buried in Clementsvalle Cemetery.

d/o Fletcher Milbury and Sarah J. Sproule.
Mabel Masters, Deep Brook, daughter.

Saphronia was a great singer and story-teller.³¹

They had the following children:

- 48** i. **Daniel Howard** (17 May 1866-23 Jun 1945)
- ii. **Norman Alfa**. Born on 2 Sep 1868 in Clementsvalle, Annapolis Co., NS.
- 49** iii. **Fred Chipman** (22 May 1870-22 Feb 1963)
- iv. **Lilly Beatrice**. Born on 18 Sep 1873 in Clements, Annapolis Co., NS. Lilly Beatrice died on 6 Jun 1876; she was 2.
- v. **Mabel Gertrude**. Born on 16 Aug 1875 in Clementsport, Annapolis Co., NS. Mabel Gertrude died on 29 Apr 1968; she was 92. Residence: Newton Highlands, Mass.; Deep Brook, NS.

On 21 Aug 1895 when Mabel Gertrude was 20, she married **Fred Nathaniel Marsters** in Clementsport, NS. Born in 1870 in Summerville, Hants Co., NS. Fred Nathaniel died on 19 Apr 1942; he was 72.

- s/o Capt. Robert and Maria (Musgrave) Marsters
- 50** vi. **William Bennett** (24 Feb 1877-29 Nov 1954)
- 51** vii. **Reginald Clayton** (28 Mar 1880-14 Jul 1934)
- 52** viii. **Harry Sufferin** (12 Jan 1886-28 Mar 1962)

16. Charles Augustus Long (*William Bennett³, Peter², Jacob Peter Lange¹*). Born on 8 Apr 1846 in Bear River East, N.S. Charles Augustus died in Clementsvalle, Annapolis Co., NS, on 25 Feb 1943; he was 96. Buried in Clementsvalle Cemetery. Residence: Clementsvalle (1901 census).

1871 census Hessian Line Long Charles 25 Melissa 22 Valentine (M) 1.

1881 census Hessian Line Long Charles A. 35 Mariah M. 32 Valentine 12 Mary A. 10 Abbie L. 8 Alice E. 5 George

Long Family of Annapolis County, NS

W. 3.

1901 census, George, Eliza, Clara and Gladys at home.

On 14 May 1869 when Charles Augustus was 23, he married **Maria Melissa Milner**, daughter of **Joshua Milner** (21 May 1816-1899) & **Sarah Hines** (ca 1831-1900), in Clements, Annapolis Co., NS. Born on 28 Jan 1849 in Clements, NS. Maria Melissa died in Clementsvale, Annapolis Co., NS, on 29 May 1927; she was 78.

They had the following children:

- 53** i. **Valentine Augustus** (17 Aug 1869-11 Jan 1955)
- 54** ii. **Mary Amert (Ammie)** (18 Aug 1871-16 Oct 1946)
- iii. **Abbie Louisa**. Born on 16 Aug 1873 in Clementsvale, Annapolis Co., NS. Abbie Louisa died on 28 May 1951; she was 77.

In Jun 1900 when Abbie Louisa was 26, she married **Fowler Wesley Fraser**. Born on 23 Dec 1868. Fowler Wesley died on 24 Dec 1932; he was 64.

- 55** iv. **Alice Ellsworth** (17 Feb 1876-4 Dec 1960)
- 56** v. **George Wallace** (11 May 1879-2 Jan 1965)
- vi. **Eliza Jane Perkins**. Born on 3 Sep 1881 in Clementsvale, Annapolis Co., NS. Eliza Jane Perkins died on 31 Dec 1949; she was 68.

On 3 Aug 1904 when Eliza Jane Perkins was 22, she married **Wilbert L. Drew** in Clementsvale, Annapolis Co., NS. Born on 3 Aug 1879 in Allsbro, Mass. Wilbert L. died on 11 Sep 1952; he was 73.

- vii. **Clara Marie**. Born on 25 Nov 1883 in Clementsvale, Annapolis Co., NS. Clara Marie died on 6 Jun 1966; she was 82.
- 57** viii. **Gladys Lorena** (23 Apr 1887-19 Oct 1976)

Family of William Bennett Long (4) & Rebecca Elizabeth (Betsy) Berry

17. Priestley Long (*William Bennett³, Peter², Jacob Peter Lange¹*). Born on 6 Dec 1851 in Bear River East, N.S. Priestley died on 25 Nov 1920; he was 68. Buried in Clementsvale Cemetery. Occupation: Wheelwright, Farmer. Residence: Bear River East.

1881 census Hessian Line Long Priestley 30 Saphronna 25.

On 14 Feb 1876 when Priestley was 24, he first married **Jane Sophronia Sanford**. Born in 1856. Jane Sophronia died on 27 Jan 1882; she was 26.

Sophronia J., wife of Priestly Long, d Jan 27, 1882 aged 26 yrs (Clementsval Cemetery)

They had no children.

On 2 Oct 1882 when Priestley was 30, he second married **Ella Wallace**.

They had one child:

- i. **Wallace Ewart**. Born on 4 May 1886.

On 29 Apr 1912 when Wallace Ewart was 25, he first married **Elsie Ardenell Cole** in

Long Family of Annapolis County, NS

Worcester, MA. Born in 1892 in providence, RI.

In 1920 when Wallace Ewart was 33, he second married **Florence Viola Cahill** in Saugus, Mass. Born in 1890.

On 11 Jan 1888 when Priestley was 36, he third married **Mary L. Milbury**. Born on 22 Jun 1867.

They had the following children:

i. **Eva May**. Born in Dec 1888.

On 4 Apr 1903 when Eva May was 14, she married **Albert A. Lomas** in Somerville, Mass. Born in 1881 in England.

58 ii. **Jasper Veloice**. Born on 1 May 1890.

iii. **Howard Thellwell** (18 Mar 1892-1957)

iv. **Pearl Elizabeth**. Born on 19 Oct 1905 in Bear River East, N.S.

On 31 Aug 1925 when Pearl Elizabeth was 19, she married **Malcolm "Bruce" Turnbull** in Digby, NS. Born in 1900. Residence: Saugus, Mass.

18. Thomas Roby Long (*William Bennett³, Peter², Jacob Peter Lange¹*). Born on 3 Jul 1852. Thomas Roby died on 23 Jul 1884; he was 32.

Drowned in Bear River.

On 15 Jan 1880 when Thomas Roby was 27, he married **Jane "Jennie" Milbury** in Clementsvale, Annapolis Co., NS. Born on 17 May 1862. Jane "Jennie" died in Clementsvale, Annapolis Co., NS, on 15 Mar 1947; she was 84.

Ralph and Elmer are with Jennie and husband James Berry, 1901 census Clementsport.

Clementsvale Cemetery: Pte. Corey M. Berry, #282774, 85Bn, b Aug 2, 1893, KIA June 16, 1917, buried in France, son of J. Wallace and Jennie Berry; Wallace Berry, 1861-1951; Jennie, wife, 1862-1947; Elmer R. Long, b. Jul 13, 1885; drowned Jul 5, 1915; son of Thomas & Jennie Long

They had the following children:

59 i. **Ralph Watson** (29 Jul 1881-1969)

ii. **Thomas**. Born on 15 Jul 1884. Thomas died on 5 Jul 1915; he was 30.

Drowned off Shaw Point, Clementsport, when their boat capsized.

iii. **Elmer R.** Born on 13 Jun 1885. Elmer R. died on 5 Jul 1915; he was 30. He was never married.

Drowned off Shaw Point, Clementsport, when their boat capsized.

19. Althea Ann Long (*William Bennett³, Peter², Jacob Peter Lange¹*). Born on 22 Apr 1855 in Clementsvale, Annapolis Co., NS. Althea Ann died in Allston, Mass. U.S.A., on 26 Jun 1894; she was 39.

On 13 Sep 1876 when Althea Ann was 21, she married **Thomas Ansley Sanford**, son of **Richard Harding Sanford** (1824-1883) & **Rebecca Potter** (18 Jun 1826-6 Apr 1866). Born on 5 Dec 1852 in Clementsvale, Annapolis Co., NS. Thomas Ansley died in Boston, Mass. U.S.A., on 10 Dec 1939; he was 87. Residence: Allston, Mass. (June 4, 1883).

Long Family of Annapolis County, NS

s/o Richard Harding and Rebecca Elizabeth (Potter) Sanford.

They had the following children:

- 60** i. **Hobart Albertus** (21 Jul 1877-Mar 1975)
- ii. **Herman Incas**. Born on 3 May 1879 in Clementsvale, Annapolis Co., NS. Herman Incas died in West Roxbury, Boston, Mass., in Aug 1968; he was 89.

Herman Incas married **Elizabeth Mary Roach**. Born in 1877. Elizabeth Mary died in 1968; she was 91.

- 61** iii. **Clarence Higgins** (Twin) (11 Jan 1887-13 Mar 1965)
- iv. **Mabel B.** (Twin). Born on 11 Jan 1887 in Allsbro, Mass. Mabel B. died on 5 Apr 1888; she was 1.
- v. **Isabel**.

Isabel married **Frank Wright**.

20. Jacob Whitman Long (*William Bennett³, Peter², Jacob Peter Lange¹*). Born on 17 Sep 1856 in Clementsvale, Annapolis Co., NS. Jacob Whitman died on 11 Nov 1934; he was 78. Residence: Bear River, Annapolis (1901 census).

On 17 Sep 1882 when Jacob Whitman was 26, he married **Izetta J. Ritchie** in Virginia, Annapolis Co., NS. Born on 6 May 1858 in Virginia, Annapolis Co., NS. Izetta J. died in 1926; she was 67.

d/o James and Elizabeth

They had the following children:

- i. **Walter** (Died as Infant). Born on 1 Oct 1883. Walter died in Jul 1884; he was <1.
- 62** ii. **James "Leonard"** (29 Nov 1886-Dec 1936)
- 63** iii. **Harold Hastings** (11 Jun 1889-1939)
- iv. **Lena Gertrude**. Born on 19 Apr 1894.

Lena Gertrude married **Frank Coombs**. Residence: Lynn, Mass.

- 64** v. **Otto** (20 Mar 1897-18 Dec 1975)
- 65** vi. **Milton** (10 Sep 1899-5 Jan 1963)

21. Corey O'Dell Long (*William Bennett³, Peter², Jacob Peter Lange¹*). Born on 22 Apr 1858 in Clementsvale, Annapolis Co., NS. Corey O'Dell died on 24 May 1935; he was 77.

Clementsvale Cemetery Corey O. Long, 1859-1935; wife Ella M. (Beeler) 1863-1936; J. Parker, 1895-1956; Florence M. (Beeler) Pyne 1860-1935, wife of Thomas Pyne

On 14 Dec 1879 when Corey O'Dell was 21, he first married **Martha B. Long**, daughter of **11. William Dennison Long** (12 Aug 1836-28 Aug 1914) & **Sarah Jane Sproule** (4 Mar 1827-1 Sep 1916), in Clementsvale, Annapolis Co., NS. Born in 1860 in Nictaux, Annapolis Co., NS. Martha B. died on 16 Sep 1885; she was 25.

Martha B. wife of Cory Long d Sep 16, 1885 aged 25.

Martha B. is a granddaughter of Jacob Long Jr. ³¹ (See #2857)

Long Family of Annapolis County, NS

On 3 Dec 1890 when Corey O'Dell was 32, he second married **Ella Mae Beeler** in Clementsport, Annapolis Co., NS. Born on 3 Mar 1863 in Prunedale, Annapolis Co. Ella Mae died in Clementsvale, Annapolis Co., NS, on 16 Apr 1936; she was 73.

They had the following children:

- 66** i. **James "Parker"** (17 Jun 1895-31 Jul 1956)
- ii. **Milledge C.** Born on 28 Nov 1896. Milledge C. died in Feb 1914; he was 17.
- 67** iii. **Marion Dorothy** (18 Aug 1898-7 Aug 1958)

22. Martha B. Long (*William Bennett³, Peter², Jacob Peter Lange¹*). Born on 12 Dec 1859 in Clementsvale, Annapolis Co., NS. Martha B. died in Annapolis Co., NS, on 13 Aug 1909; she was 49. Buried in Bear River Mount Hope Cemetery.

On 13 Nov 1881 when Martha B. was 21, she married **Alden E. Long (12)**, son of **3. Jacob Long** (1807-1 Apr 1887) & **Rachel Ann Simmons**, in Clementsport, Annapolis Co., NS. Born on 14 Sep 1858 in Clementsvale, Annapolis Co., NS.

s/o Jacob and Ann (NSHVS), but see discussion under his father. However, it appears his mother Ann was with him in 1891.

1891 census Bear River Long Alden 30 Martha 27 Oscar 7 Lottie 5 Ann (widow) 72.

They had the following children:

- i. **Oscar Edward.** Born on 17 Mar 1883 in Bear River, Digby Co., NS. Occupation: Blacksmith.

On 18 Aug 1904 when Oscar Edward was 21, he married **Jennie E. Ginniman** in Clementsport, Annapolis Co., NS. Born in 1881 in Newcastle, NB.
- ii. **Lottie.** Born on 22 May 1886.

23. Henry "Fletcher" Long (*William Bennett³, Peter², Jacob Peter Lange¹*). Born on 8 Dec 1860 in Bear River East, N.S. Henry "Fletcher" died in Clementsvale, Annapolis Co., NS, on 2 Oct 1929; he was 68.

In 1882 when Henry "Fletcher" was 21, he first married **Lillian Frances Scheffer**. Born on 6 Jul 1865 in Maitland, Annapolis Co., NS. Lillian Frances died in Clementsvale, Annapolis Co., NS, on 22 Jun 1912; she was 46.

They had the following children:

- 68** i. **George Edward** (12 Nov 1885-30 Sep 1925)
- 69** ii. **Beatrice Martha** (11 Nov 1887-17 Jan 1962)
- 70** iii. **Goldie Vivian** (29 Jun 1900-2 Jun 1983)

On 26 Jul 1921 when Henry "Fletcher" was 60, he second married **Flora Jane Ord** in Clementsvale, Annapolis Co., NS.

Flora Jane Millett, born Milford, age 59.

On 17 Jun 1923 when Henry "Fletcher" was 62, he third married **Laura Hall** in Clementsvale, Annapolis Co., NS.

24. Joel Daniel Long (*William Bennett³, Peter², Jacob Peter Lange¹*). Born on 27 Sep 1865 in Bear River East, N.S.

Long Family of Annapolis County, NS

Joel Daniel died on 2 Jun 1948; he was 82. Residence: Bear River, Annapolis (1901 census).

Clementsvale cemetery. Joel Long, 1853-1948; Maggie (Weilant), wife, 1876-1963; Hartford Long, 1898-1947

On 4 Apr 1896 when Joel Daniel was 30, he married **Margaret Weilant**, daughter of **Jacob Weiland** (28 Feb 1849-) & **Melvina Milner** (Aug 1853-), in Clementsvale, Annapolis Co., NS. Born on 20 Apr 1877. Margaret died on 11 Sep 1963; she was 86.

They had the following children:

- 71** i. **Hartford Thorold** (10 Jan 1898-21 Feb 1947)
- ii. **Everett**. He was never married.
- 72** iii. **Grace Elizabeth** (16 Mar 1902-)

25. Daniel "Emerson" Long (*William Bennett³, Peter², Jacob Peter Lange¹*). Born on 19 Feb 1869 in Bear River East, N.S. Daniel "Emerson" died in Erving, Mass., on 8 Sep 1945; he was 76. Buried in Highland Cemetery, Millers Falls, Mass. Occupation: Long's Tea Room and Motel, Erving, Mass., since 1925. Residence: Lynn, Mass. (after birth of Charlotte); Erving, Mass.

Emerson served in the American Army Reg. 7th Infantry, Company E, fought at Fort Laramie, Wyoming. Started the restaurant and motel in 1925, sold in 1945 to son Waldo and his wife Bertha, and he in turn sold to his nephew Barry Brocklesby (son of Helen) in 1968.

On 8 May 1898 when Daniel "Emerson" was 29, he married **Elizabeth Ann Meuse**. Born on 8 May 1881. Elizabeth Ann died on 30 Aug 1963; she was 82.

d/o John F. (sailor) and Charlotte Adelaide (Rosencrants) Meuse.

They had the following children:

- 73** i. **Joseph Warren** (16 Dec 1898-28 Apr 1941)
- ii. **Katherine Lois** (Died as Infant). Born on 17 Mar 1899.
- 74** iii. **Waldo Emerson** (25 May 1903-10 Nov 1978)
- 75** iv. **Charlotte Elizabeth** (5 Jan 1905-3 Feb 1986)
- 76** v. **Althea Priscilla** (Oct 1909-17 Jan 1969)
- vi. **Avis Adeline** (Died as Infant). Born on 8 Dec 1912.
- 77** vii. **Pearl Jeanette** (7 Feb 1915-6 Mar 1972)
- 78** viii. **Irene Francis** (3 Jun 1917-26 Jun 2016)
- 79** ix. **Helen Marion** (26 Aug 1919-8 Feb 2011)

26. John Bennett ("Ben") Long (*William Bennett³, Peter², Jacob Peter Lange¹*). Born on 31 Dec 1871 in Clementsvale, Annapolis Co., NS. John Bennett ("Ben") died in Penacook, Merrimack, NH, on 10 Jan 1927; he was 55. Occupation: Policeman, South Boston. Residence: Concord, NH.

On 18 Jul 1900 when John Bennett ("Ben") was 28, he married **Nellie Florence Ferry** in East Weare, Hillsborough, NH. Born on 29 Apr 1875 in Antrim, Hillsborough, NH.

They had the following children:

- i. **John Clark**. Born on 12 Nov 1909 in Lynn, Essex Co., Mass.
- ii. **Nellie F.** Born in 1913.

27. Wesley "Manning" Long (*William Bennett³, Peter², Jacob Peter Lange¹*). Born on 15 May 1874 in Bear River East, N.S. Wesley "Manning" died in Bear River East, N.S., on 6 Apr 1961; he was 86. Buried in Clementsvale.

Long Family of Annapolis County, NS

Long, Estella Maude, b. Dec 21, 1913 Bear River east, d/o Manning Long and Minnie H. McSwain (NSHVS)

On 9 Jun 1910 when Wesley "Manning" was 36, he married **Minnie McSwain** in Bear River, Digby Co., NS. Born on 29 Oct 1885. Minnie died on 17 Sep 1959; she was 73.

They had the following children:

- 80** i. **Estella Maude** (21 Dec 1913-29 Oct 1976)
- ii. **Ada**. Born on 9 Apr 1917 in Boston, Mass., USA. Ada died on 26 Jan 1989; she was 71. Residence: Roslindale, Mass. She was never married.

Family of Ephraim Daniels Long (6) & Jane Elizabeth Hines

28. Melinda Long (*Ephraim Daniels*³, *Peter*², *Jacob Peter Lange*¹). Born in 1845. Melinda died in Auburndale, Mass., USA, on 30 Dec 1912; she was 67.

1870 US census Newton, Mass. Cook George 35 b. Nova Scotia, Melinda 25 b. Nova Scotia, Caroline 6 b. Nova Scotia, Loring 4 b. Nova Scotia, Long Joshua 20 b. Nova Scotia. (Joshua is Melinda's brother).

On 23 Jun 1863 when Melinda was 18, she first married **George N. Cook** in Annapolis Co., NS. Born in 1835.

They had the following children:

- i. **Caroline (Caddie) May**. Born on 4 Jun 1864 in Clementsvale, Annapolis Co., NS.
- ii. **Loran LeCain**. Born on 11 Apr 1866 in Clementsvale, Annapolis Co., NS.

Melinda second married **Sanford Wood Freeman**. Born in 1821 in Toledo, Ohio, USA. Sanford Wood died in 1904; he was 83.

29. Janette Long (*Ephraim Daniels*³, *Peter*², *Jacob Peter Lange*¹). Born on 5 Mar 1847. Janette died in Acaciaville, Digby Co., on 23 Mar 1930; she was 83.

Mrs. John Nichols, Acaciaville, daughter.

On 31 Aug 1868 when Janette was 21, she married **Samuel Peck** in Clements, Annapolis Co., NS. Born on 29 Mar 1848. Residence: Hessian Line (1881 census); Bear River (1901 census).

They had the following children:

- i. **Arabelle**. Born on 26 Mar 1868. Arabelle died in Bear River, NS, on 30 Jan 1940; she was 71.

Daughter Hazel Banks married Avard Robar.³¹

Arabelle married **James Banks**.

- ii. **Ulysses**. Born in 1870.

Children Marguerite Watson, Hilda Meikle, Roy, Gladys and Harold.³¹

On 4 Nov 1900 when Ulysses was 30, he married **Flora Hill** in Boston. Born in 1879.

Long Family of Annapolis County, NS

- iii. **Freman.** Born in 1872.
- iv. **Margaret J.** Born in 1874 in Bear River, NS. Margaret J. died in Boston, Mass., on 28 Aug 1910; she was 36.

Margaret J. married **Henry P. Andrews.**

- v. **Adney Willard.** Born on 2 Jul 1875.

On 4 Oct 1905 when Adney Willard was 30, he married **Ina Charlton Mitchell** in Newton, Massachusetts. Born in 1883.

- vi. **Archibald.** Born in 1878.
- vii. **Ida May.** Born in 1879.
- viii. **George.** Born on 17 Jul 1886.
- ix. **Lillian.** Born on 27 Sep 1879. Lillian died in Conway, Digby Co., on 12 Nov 1945; she was 66.

Mrs. Vernon Rice, daughter

Lillian married **John Nichol.**

30. Joshua Freeman Long (*Ephraim Daniels*³, *Peter*², *Jacob Peter Lange*¹). Joshua Freeman died in Waverley, Mass., on 4 Dec 1913; he was 63. Born in 1850. Residence: Naturalization, Massachusetts (1893).

1870 US census Newton, Mass. Cook George 35 b. Nova Scotia, Melinda 25 b. Nova Scotia, Caroline 6 b. Nova Scotia, Loring 4 b. Nova Scotia, Long Joshua 20 b. Nova Scotia. (Joshua is Melinda's brother).

1880 US census Newton, Mass. Joshua Long 29, coachman, single, b. Canada, is living with the family of Charles and Mary Sweet.

Death record lists parents as Ephraim and Jane Long.

The names of wife and daughters comes from ³¹, records have not been found.

Joshua Freeman married **Roxanna.**

They had the following children:

- i. **Florence.**

Florence married **Harry Loomer.**

- ii. **Elizabeth.**

Elizabeth married **Bartlett Lockhart.**

31. George Hines Long (*Ephraim Daniels*³, *Peter*², *Jacob Peter Lange*¹). Born on 20 Jan 1852. George Hines died in Arlington, Mass., on 30 May 1920; he was 68.

1910 US census Belmont, Mass., Adna 15 Gladys 14 Harold 11 Freeman 9.

George Hines married **Florence Darling.** Born in 1872. Florence died in Arlington, Mass., in 1947; she was 75.

They had the following children:

- i. **Adna George.** Born on 24 Feb 1895 in Cambridge, Mass.

Long Family of Annapolis County, NS

1930 US census Somerville, Kenneth B. son 8, Barbara J. daughter 4.

On 28 Nov 1918 when Adna George was 23, he married **Helen Theodore Jackson** in Watertown, Middlesex, MA. Born in 1896 in Brookline, Mass., USA.

- ii. **Gladys**. Born on 2 Dec 1896 in Cambridge, Middlesex, Mass.
- iii. **Harold Martin** (Twin). Born on 9 May 1899 in Cambridge, Middlesex, Mass. Harold Martin died in 1956; he was 56. Buried in Arlington, Mass. Occupation: WW1, US Army.

Harold Martin married **Doshie Lee**. Born in 1903 in Kentucky. Doshie died in 1959; she was 56.

- iv. **Ella** (Twin). Born on 10 May 1899 in Cambridge, Middlesex, Mass.
- v. **Melvin "Freeman"**. Born on 25 Apr 1901 in Watertown, Middlesex, MA. Melvin "Freeman" died in Jan 1966; he was 64.

1930 US census, Lowell, Mass., Long Freeman 27 b. Mass., Jessie 30 b. Scotland, E. Freeman son 5, Dorothy G. daughter 3.

On 5 Dec 1923 when Melvin "Freeman" was 22, he married **Jessie McLeod** in Boston, Mass. Born in 1899.

32. Sarah Long (*Ephraim Daniels³, Peter², Jacob Peter Lange¹*). Sarah died in Sharon, Mass., in 1925; she was 70. Born in 1855 in Clementsvale, Annapolis Co., NS.

On 29 Oct 1873 when Sarah was 18, she married **James "William" Gray** in Bear River, Digby Co., NS. James "William" died in Bear River, NS. Born in 1848 in Granville, Anna. Co., NS. Residence: Hessian Line (1881 census).

s/o John Gray

They had one child:

- i. **George H.** Born on 19 Jan 1875 in Bear River, NS.

33. Effie Long (*Ephraim Daniels³, Peter², Jacob Peter Lange¹*). Born in 1858 in Clementsvale, Annapolis Co., NS.

On 13 Jun 1877 when Effie was 19, she married **Joseph Henry Cook** in Clementsport, Annapolis Co., NS. Joseph Henry died in Auburndale, Newton, Mass., on 29 Dec 1893; he was 41. Born in 1852 in Aylesford, Kings Co., NS.

s/o William Cook and Phoebe Gates (Mass. Deaths).

They had the following children:

- i. **Eva Dean**. Born on 1 Feb 1879 in Newton, Mass.

On 1 Nov 1910 when Eva Dean was 31, she married **Paul Burrage** in Newton, Mass. Born in 1877 in Newton, Mass.

- ii. **Otis C.** Born in 1880 in Auburndale, Newton, Mass.

On 6 Mar 1900 when Otis C. was 20, he married **Gertrude E. Weatherby** in Boston, Mass. Born in 1880.

d/o Jonathan Weatherby and Martha Gay.

Long Family of Annapolis County, NS

34. Ella S. Long (*Ephraim Daniels³, Peter², Jacob Peter Lange¹*). Born on 3 Jun 1860. Ella S. died in Bear River, Digby Co., NS, on 10 Nov 1937; she was 77. Buried in Clementsvale Cemetery.

1881 census Hessian Line Household 227 Apt Elizabeth B 76 Ella 20 Peck John 26 Gray Ira S 2.

On 6 Jul 1875 when Ella S. was 15, she first married **John Ambrose Grey** in Clementsport, Annapolis Co., NS.

s/o John and Elizabeth

They had the following children:

- i. **Ira**. Born in 1879.
- ii. **Herman**.

On 28 Dec 1880 when Ella S. was 20, she second married **John Peck** in Clementsvale, Annapolis Co., NS. Born on 11 Jan 1855. John died in 1930; he was 74. Buried in Clementsvale Cemetery. Residence: Bear River (1901 census).

s/o Samuel and Mary

They had the following children:

- i. **Homer**. Born on 29 Jul 1881.
- ii. **Daisy**. Born on 19 Feb 1883.
- iii. **Charlotte**. Born on 4 May 1884.
- iv. **Orland Harry**. Born on 3 Jul 1887.
- 81 v. **Enoch** (1 Apr 1889-)
- vi. **Mary**. Born on 26 Apr 1891.
- vii. **Willard** (Twin). Born on 22 May 1893.
- viii. **Lulu** (Twin). Born on 22 May 1893.
- ix. **Esther Lindy**. Born on 19 Dec 1895.
- x. **Vernon**.

Family of Lydia Jane Long (7) & John Henry Trimper

35. John Edward Trimper (*Lydia Jane Long³, Peter², Jacob Peter Lange¹*). Born on 14 Apr 1843. John Edward died in Clementsvale, Annapolis Co., NS, on 7 Jul 1916; he was 73.

On 9 Aug 1865 when John Edward was 22, he married **Emma E. Beeler** in Clements, Annapolis Co., NS. Born in 1845. Emma E. died in 1900; she was 55.

They had the following children:

- i. **David Ernest**. Born on 9 Apr 1868. David Ernest died in 1951; he was 82.
- ii. **Myrtle Ulanda**. Born in 1869. Myrtle Ulanda died in 1921; she was 52.
- iii. **Edith** (Died as Infant). Born in 1876. Edith died in 1876; she was <1.
- iv. **Harland Clark**. Born in 1877. Harland Clark died in 1952; he was 75.
- v. **Alice Martha**. Born on 4 Aug 1879. Alice Martha died in 1944; she was 64.
- vi. **John**. Born in 1880.
- vii. **Ivan Carroll**. Born on 20 Apr 1881. Ivan Carroll died in 1944; he was 62.
- 82 viii. **Miriam Ann** (7 Feb 1884-14 Dec 1913)

Long Family of Annapolis County, NS

ix. **Leota Gladys**. Born on 17 Nov 1886. Leota Gladys died in 1969; she was 82.

36. Hallett Ray Trimper (*Lydia Jane Long³, Peter², Jacob Peter Lange¹*). Born on 7 Mar 1858. Hallett Ray died in Clementsvale, Annapolis Co., NS, on 10 Jul 1914; he was 56. Residence: Clementsvale (1901 and 1911 census).

Clementsvale Cemetery, Hallett R. Trimper, 1858-1914; Margaret (Ramsay), wife, 1864-1955; son William W., 1891-1892

On 2 Jul 1890 when Hallett Ray was 32, he married **Margaret J. Ramsay**. Born on 10 Jan 1864.

They had the following children:

- i. **Catherine**. Born on 27 Oct 1892.
- ii. **Lydia**. Born on 10 Jun 1894.
- iii. **Lee Mary**. Born on 13 Aug 1896.

37. Thomas Henry Trimper (*Lydia Jane Long³, Peter², Jacob Peter Lange¹*). Born on 14 Mar 1862. Thomas Henry died in Clementsvale, Annapolis Co., NS, in Aug 1939; he was 77.

1891 census Thomas Trimper 29 Head of Household George W 2 and Hattie V 7/12, also Daniel P Millner 79 Widow, Labourer (Thomas Trimper owned Daniel's home from 1888 to 1939)
1901 census Clementsvale Trimper Thomas (head) 39 George (son) 12 Lydia (mother) 80 Fletcher (brother) 47.

On 8 May 1888 when Thomas Henry was 26, he married **Elena Jane Wright (43)**, daughter of **William Oliver Wright** (16 Oct 1831-10 Mar 1889) & **8. Beulah Elizabeth Long** (7 Nov 1825-21 Dec 1902), in Clementsvale, Annapolis Co., NS. Born on 28 Aug 1869 in Clementsvale, Annapolis Co., NS. Elena Jane died in Clementsvale, Annapolis Co., NS, in Sep 1890; she was 21.

They had the following children:

- 83**
- i. **George Wickup** (14 Feb 1889-8 May 1947)
 - ii. **Elena** (Died as Infant). Born on 31 Aug 1890. Elena died on 22 Dec 1890; she was <1.
 - iii. **Huldah** (Died as Child). Born on 31 Aug 1890. Huldah died in Clementsvale, Annapolis Co., NS, on 30 Jan 1901; she was 10. Buried in Clementsvale Cemetery.

Family of John Henry Long (9) & Caroline Amelia Sproule

45. Lewis "Mortimer" Long (*John Henry³, Peter², Jacob Peter Lange¹*). Born on 17 Nov 1863 in Bear River, NS. Lewis "Mortimer" died in Woburn, Mass., on 6 Oct 1912; he was 48. Residence: Clementsport (1901 census).

Long, Bertha May, Nov. 4 1897 Clementsport, d/o Lewis Mortimer Long (b. Bear River) and Ida May Chute

On 16 May 1885 when Lewis "Mortimer" was 21, he married **Ida May Chute** in Cambridge, Mass. Born on 3 Nov 1864.

They had the following children:

- i. **Clarence Mortimer**. Born on 27 May 1885 in Cambridge, Mass. Clarence Mortimer died in Somerville, Mass., on 27 Feb 1915; he was 29. Buried in Woodbrook Cemetery, Woburn.

Long Family of Annapolis County, NS

Daughter Marjory E. Long Maskell, b. 6 Oct 1909 Somerville, d. 13 Feb 2003 (aged 93), wife of Nelson Maskell, 1909-1994. Their daughter Judith M. "Judy" Maskell Lorenz, b. 18 Jun 1940 Medford, d. 18 May 2012 (aged 71), Lincoln, Lancaster County, Nebraska.

Judith (Maskell) Lorenz, age 72, died Friday, May 18, 2012, in Lincoln, Neb., 1 month shy of her 73rd birthday. She passed away peacefully at home in the loving embrace of her family and under the superlative care of Hospice. Over the last year she bravely fought and conquered breast cancer but finally succumbed to COPD. She was the beloved wife of Harold "Bud" Lorenz and the daughter of the late Nelson and Marjory (Long) Maskell. Born in Medford, Mass. she lived in the Boston and Braintree, Mass. area for many years, attending Boston Latin School, Braintree High & graduating from Children's Hospital School of Pediatric Nursing in Boston. Bud's job with Goodyear came with many relocations over the years, including 6 years abroad in Mexico City and 3 years in Ontario, Canada. They had lived in Lincoln for the last 18 years and Marion, Mass. for 14 years prior to that. She worked at many hospitals as a Pediatric Registered Nurse, including St Luke's Hospital in New Bedford, Mass. for 11 years. Devoted to her profession of Pediatric Nursing, she was always "A Giver". She often went above and beyond, doing special things for many of her young patients & their parents - trying to make their experience a little happier. Her kindnesses are still remembered by many people years later. Judy was also a registered EMT. In her retirement years she helped many friends thru illnesses by offering her support and guidance. Judy was an avid bridge player, she loved flowers and the ocean. She also enjoyed gardening, reading, entertaining and shopping. She was a devoted grandmother to three wonderful grandchildren; Mandy and Jessi Mettscher and Alex Lorenz. She leaves her devoted husband Bud of 52 years; three children: Melissa and Daniel Chase, Christopher and Lisa Lorenz of Massachusetts and Diana Mettscher of Lincoln; her three precious grandchildren; nieces & nephews; and her loving sister, Melanie Horte of Hingham, Mass.

On 8 Aug 1907 when Clarence Mortimer was 22, he married **Bertha May Guy** in Somerville, Mass. Born in 1889.

- ii. **Mabel Estella**. Born on 22 Jan 1887 in Cambridge, Mass.
- iii. **Annie Amelia**. Born on 13 Jun 1888 in Cambridge, Mass.
- iv. **James H.** Born on 25 Jul 1892.
- v. **William Erington**. Born on 12 Oct 1894. William Erington died on 4 Jul 1950; he was 55. Buried in Woodbrook Cemetery, Woburn.

On 17 May 1920 when William Erington was 25, he married **Ruth Bassett** in Boston, Mass.

Ruth (Bassett) Eddy, d/o Lucius A. Bassett and Mary Jacques.

- vi. **Bertha May**. Born on 4 Nov 1896. Bertha May died in Cambridge, Mass., on 11 Jan 1969; she was 72. Buried in Woodbrook Cemetery, Woburn.
- vii. **Susan L.** Born on 22 Jan 1899. Susan L. died on 24 Jun 1986; she was 87. Buried in Ocean View Cemetery, Wells, Maine.

Samuel Richard Ruggeri, Jr., 31 Oct 1926 13 Feb 2011 (aged 84), Ocean View Cemetery, Wells, York County, Maine.

Susan L. married **Samule D. Ruggari**. Born on 8 May 1895 in Messina, Città Metropolitana di Messina, Sicilia, Italy. Samule D. died in Mar 1969; he was 73.

- viii. **Meredith**. Born on 9 Sep 1903 in Woburn, Mass. Meredith died on 25 Sep 1955; she was

Long Family of Annapolis County, NS

52.

Meredith married **Hans Iver Paulsen**.

- ix. **Nellie Irene**. Born on 3 Jan 1905 in Woburn, Mass. Nellie Irene died in Melrose, Mass., on 2 Mar 1982; she was 77. Buried in Woodbrook Cemetery, Woburn.

Nellie Irene married **James Edgar Aylward**. Born on 15 Jun 1902 in PEI. James Edgar died in Stoneham, MA, on 15 Jan 1970; he was 67.

- x. **Ena Louise**. Born on 11 Feb 1908 in Woburn, Mass.

Fifth Generation

Family of Martha Long (10) & Henry Brown

46. Herman Augustus Brown (*Martha Long⁴, Jacob³, Peter², Jacob Peter Lange¹*). Born on 2 Dec 1863 in West Springhill, Anna. Co., NS. Herman Augustus died in West Springhill, Anna. Co., NS, on 29 Apr 1936; he was 72. Occupation: Postmaster, West Springhill.

On 15 Dec 1890 when Herman Augustus was 27, he first married **Bessie Olivia Wright**, daughter of **Wallace Albert Wright** (29 Jul 1842-20 May 1912) & **Martha Loretta Chute** (6 Jan 1851-Sep 1928). Born in 1874 in Clementsvale, Annapolis Co., NS. Bessie Olivia died in West Springhill, Anna. Co., NS, on 28 Mar 1924; she was 50.

They had one child:

- 99** i. **Wellington Augustus** (1 Jul 1890-5 Feb 1982)

On 22 Dec 1886 when Herman Augustus was 23, he second married **Lydia A. Sproul** in Clementsport, Annapolis Co., NS. Born in 1868.

47. George Henry Brown (*Martha Long⁴, Jacob³, Peter², Jacob Peter Lange¹*). Born on 5 Sep 1865 in Clementsvale, Annapolis Co., NS. George Henry died in West Springhill, Anna. Co., NS, on 30 Dec 1945; he was 80.

George Henry Brown, b. 5 Sep 1865, s/o Henry Brown and Martha Long (NSHVS)

George Henry married **Lizzie**. Born on 14 Mar 1873.

They had the following children:

- i. **John**. Born on 16 Aug 1890.
ii. **Modena**. Born on 17 Nov 1892.
iii. **Gilbert**. Born on 6 Jun 1895.

Long Family of Annapolis County, NS

- iv. **Carroll**. Born on 19 Mar 1898.
- v. **Lucy**. Born on 2 Jun 1900.

Family of William "Harris" Long (15) & Saphronia Ann Milbury

48. Daniel Howard Long (*William "Harris"⁴, William Bennett³, Peter², Jacob Peter Lange¹*). Born on 17 May 1866 in Clementsvale, Annapolis Co., NS. Daniel Howard died in Clementsport, Annapolis Co., NS, on 23 Jun 1945; he was 79.

They lived in Deep Brook, near his father's home, where he farmed and maintained a fish weir. His property was sold to the Canadian government for the construction of CFB Cornwallis, and they relocated to Clementsport.

On 25 Dec 1889 when Daniel Howard was 23, he married **Fannie Elizabeth White**. Born on 10 Jul 1870. Fannie Elizabeth died in 1965; she was 94.

They had the following children:

- 100** i. **Mildred Freda** (6 Feb 1892-6 Mar 1968)
- ii. **Leon Marsters**. Born on 24 Mar 1895 in Deep Brook, Anna. Co., N.S. Leon Marsters died in Auburndale, Mass., USA, on 16 Aug 1986; he was 91. Buried in Puritan Lawn Memorial Park, Peabody, MA. Occupation: Carpenter and cabinet maker.

On 25 Oct 1923 when Leon Marsters was 28, he married **Grace Maling**. Born on 1 Oct 1904.

- 101** iii. **Roy Lorimer** (1 Dec 1898-)
- 102** iv. **Walter Purdy** (20 Apr 1904-6 Jan 1965)

49. Fred Chipman Long (*William "Harris"⁴, William Bennett³, Peter², Jacob Peter Lange¹*). Born on 22 May 1870 in Brighton, MA. Fred Chipman died in Allston, Mass. U.S.A., on 22 Feb 1963; he was 92. Residence: Somerville and Allston, Mass.

He lived all of his life in Massachusetts but built a family cottage in Deep Brook in 1914. When CFB Cornwallis was built, they relocated to Clementsport.

Fred Chipman married **Frances Amelia Morgan**. Born on 15 Mar 1870. Frances Amelia died on 6 Dec 1936; she was 66.

They had the following children:

- 103** i. **Rev. Fred Burton** (14 Jan 1894-19 May 1966)
- 104** ii. **Ormond Richard** (4 Jul 1899-14 Jun 1978)
- 105** iii. **Beatrice Viola** (9 Jun 1902-25 Nov 1980)
- iv. **Myrtle Meredith**. Born on 22 Feb 1904.

On 8 Jun 1934 when Myrtle Meredith was 30, she married **Ilko O. E. Knowles** in Herkiner, New York.

50. William Bennett Long (*William "Harris"⁴, William Bennett³, Peter², Jacob Peter Lange¹*). Born on 24 Feb 1877 in Deep Brook, Anna. Co., N.S. William Bennett died in Allston, Mass. U.S.A., on 29 Nov 1954; he was 77.

At age 45 (1922) Will was paralyzed by a 55 foot fall down at elevator shaft during the construction of the Park

Long Family of Annapolis County, NS

Square building in Boston, where he was working.

On 31 Jul 1899 when William Bennett was 22, he married **Lucinda Arbuthnot Sabean** in Newton Highlands, MA. Born on 1 Dec 1869 in Port Lorne, NS. Lucinda Arbuthnot died on 3 Feb 1961; she was 91.

They had the following children:

- 106** i. **Mabel Sophronia** (18 Jan 1901-)
- 107** ii. **Edna Winifred** (21 Dec 1904-22 Mar 1989)
- 108** iii. **Vera May** (17 Jan 1907-19 Dec 1986)
- 109** iv. **William Lovett** (1 Feb 1909-18 Aug 1978)
- 110** v. **Eugene Arthur** (19 Dec 1914-)

51. Reginald Clayton Long (*William "Harris"⁴, William Bennett³, Peter², Jacob Peter Lange¹*). Born on 28 Mar 1880 in Clementsport, Annapolis Co., NS. Reginald Clayton died on 14 Jul 1934; he was 54. Buried in Clementsvale Cemetery. Residence: Deep Brook, NS.

On 15 Jan 1913 when Reginald Clayton was 32, he married **Harriett (Hattie) Louise Perkins** in Clementsvale, Annapolis Co., NS. Born in 1890 in Clementsvale, Annapolis Co., NS.

They had the following children:

- 111** i. **Clayton Marshall** (3 Sep 1914-22 Nov 2004)
- ii. **Gordon Marsters**. Born on 14 May 1917 in Deep Brook, Anna. Co., N.S. Gordon Marsters died on 2 Jan 1992; he was 74.

52. Harry Sufferin Long (*William "Harris"⁴, William Bennett³, Peter², Jacob Peter Lange¹*). Born on 12 Jan 1886 in Clementsport, Annapolis Co., NS. Harry Sufferin died in Allston, Mass. U.S.A., on 28 Mar 1962; he was 76. Residence: Allston, Mass. (1923).

They maintained their Deep Brook homestead after moving to Massachusetts, and spent summers there.

Harry Sufferin married **Gladys Jeanette O'Mara**. Gladys Jeanette died on 12 Mar 1993.

They had the following children:

- i. **Martha Beatrice** (Died as Child). Born on 21 Mar 1915 in Clementsport, Annapolis Co., NS. Martha Beatrice died on 24 May 1923; she was 8.
- 112** ii. **Harry Burton** (4 Nov 1916-29 May 1987)
- 113** iii. **Darrel Douglas** (16 Apr 1918-)
- 114** iv. **Garnett Densmore** (14 Oct 1919-)
- v. **H. Meredith**. Born on 22 Feb 1921 in Deep Brook, Anna. Co., N.S. H. Meredith died on 10 Sep 1964; she was 43. Buried in Puritan Lawn Memorial Park, Peabody, MA.

H. Meredith married **Reginald Steven Amsden**. Reginald Steven died on 26 Apr 1982.
- 115** vi. **Francis Lorraine** (14 May 1922-)

Family of Charles Augustus Long (16) & Maria Melissa Milner

53. Valentine Augustus Long (*Charles Augustus⁴, William Bennett³, Peter², Jacob Peter Lange¹*). Born on 17 Aug 1869 in Clementsvale, Annapolis Co., NS. Valentine Augustus died in Clementsvale, Annapolis Co., NS, on 11 Jan 1955; he was 85. Residence: Clementsvale (1901 census).

Long Family of Annapolis County, NS

Mother named as Maria Apt (NSHVS), Melissa Milner (death registration) Clementsvale Cemetery. Fred W. Long, 1893-1924; Elsie C. (Wright), wife, 1899-1938; Valentine A. Long 1869-1955; wife Ella M. (Fraser) 1870-1955; dau Sadie L. 1897-1902

On 10 Nov 1892 when Valentine Augustus was 23, he married **Ella M. Fraser**. Born on 28 Feb 1870. Ella M. died on 2 Dec 1955; she was 85.

d/o David A. and Catherine (Burrell) Fraser.

They had the following children:

- i. **Fred Watson**. Born on 12 Jan 1893. Fred Watson died on 22 Oct 1924; he was 31. Buried in Clementsvale Cemetery.

Fred Watson married **Elsie Glover Wright**, daughter of **Martin Revardy Wright** (22 Mar 1869-23 Jan 1947) & **Caroline (Carrie) Leavitt** (22 Oct 1872-10 Jul 1922). Born in 1899. Elsie Glover died on 6 Dec 1938; she was 39.
- 116 ii. **Etta May** (18 Aug 1894-26 Jan 1952)
- 117 iii. **Mabel Millicent** (24 Jan 1896-)
- iv. **Sadie L.** (Died as Child). Born on 29 Aug 1897. Sadie L. died on 3 Jun 1902; she was 4.

54. Mary Amert (Ammie) Long (*Charles Augustus⁴, William Bennett³, Peter², Jacob Peter Lange¹*). Born on 18 Aug 1871 in Clementsvale, Annapolis Co., NS. Mary Amert (Ammie) died on 16 Oct 1946; she was 75.

On 29 Dec 1892 when Mary Amert (Ammie) was 21, she married **William L. Ramsay** in Clementsvale, Annapolis Co., NS. Born on 17 Sep 1866 in Annapolis, NS. William L. died on 28 Jul 1938; he was 71.

They had the following children:

- i. **Marion Lee**. Born on 12 Oct 1893. Marion Lee died on 14 Jan 1979; she was 85.
- ii. **Charles William**. Born on 29 Jun 1896. Charles William died on 16 Feb 1984; he was 87. Occupation: Undertaker.

On 8 Jan 1925 when Charles William was 28, he married **Beulah Louise Jones** in Allston, Mass. U.S.A. Born on 9 Sep 1902. Beulah Louise died on 20 May 1971; she was 68.

55. Alice Ellsworth Long (*Charles Augustus⁴, William Bennett³, Peter², Jacob Peter Lange¹*). Born on 17 Feb 1876 in Clementsvale, Annapolis Co., NS. Alice Ellsworth died on 4 Dec 1960; she was 84.

On 4 Oct 1898 when Alice Ellsworth was 22, she married **Ferdinand Calvin Hutchings**. Born in 1873. Ferdinand Calvin died on 18 Mar 1945; he was 72. Residence: Oak Square, Brighton, Mass.; Watertown, Mass.

They had the following children:

- i. **Ralph Elmer**. Born on 31 Oct 1901. Ralph Elmer died on 12 May 1977; he was 75.

On 14 Jun 1930 when Ralph Elmer was 28, he married **Margaret Willard**. Born on 8 Nov 1896.
- ii. **Gladys**. Born on 12 Sep 1905.

On 3 Jun 1944 when Gladys was 38, she married **Kenneth C. Hoyt**.
- iii. **Calvin Long**. Born on 24 Mar 1907.

Long Family of Annapolis County, NS

On 13 May 1939 when Calvin Long was 32, he married **Leila Rogers**. Born on 27 Nov 1908.

iv. **Lawrence Andrews**. Born on 27 May 1913.

On 21 Sep 1946 when Lawrence Andrews was 33, he married **Virginia Mae Foreman**. Born on 5 Oct 1919.

56. George Wallace Long (*Charles Augustus⁴, William Bennett³, Peter², Jacob Peter Lange¹*). Born on 11 May 1879 in Clementsvale, Annapolis Co., NS. George Wallace died on 2 Jan 1965; he was 85.

Clementsvale Cemetery. George W. Long, 1879-1965; Pte, 85 Bn, C.E.F., Jan 2, 1965 aged 86; Daisy B. (Burrell) wife 1896-1983

On 8 Dec 1920 when George Wallace was 41, he married **Daisy Bell Burrell** in Clementsport, Annapolis Co., NS. Born on 11 Jul 1896 in Bear River East, N.S. Daisy Bell died on 31 May 1983; she was 86.

They had the following children:

- i. **Millicent Beulah**. Born on 6 Mar 1926. Millicent Beulah died in Victoria, BC, on 22 Oct 1985; she was 59.
- 118 ii. **Marie** (12 Mar 1928-12 Aug 2019)
- iii. **Charles Chester**. Born on 15 Feb 1937. Charles Chester died on 27 May 1978; he was 41.

On 15 Oct 1960 when Charles Chester was 23, he married **Ella Carol Harris**. Born on 31 Dec 1936.

57. Gladys Lorena Long (*Charles Augustus⁴, William Bennett³, Peter², Jacob Peter Lange¹*). Born on 23 Apr 1887 in Clementsvale, Annapolis Co., NS. Gladys Lorena died on 19 Oct 1976; she was 89.

On 12 Aug 1908 when Gladys Lorena was 21, she married **John Alexander King** in Clementsvale, Annapolis Co., NS. Born on 3 Mar 1883 in Geneva, New York, USA. John Alexander died on 10 Jun 1969; he was 86.

They had the following children:

- i. **Robert Clarence**. Born on 10 Aug 1909.
- ii. **Edna Mae**. Born on 8 Oct 1911.

On 3 May 1941 when Edna Mae was 29, she married **Eginald Southard**. Born on 27 Oct 1909.

iii. **John Charles**. Born on 29 Nov 1914.

Family of Priestley Long (17) & Mary L. Milbury

58. Howard Thellwell Long (*Priestley⁴, William Bennett³, Peter², Jacob Peter Lange¹*). Born on 18 Mar 1892. Howard Thellwell died in 1957; he was 64.

In 1919 when Howard Thellwell was 26, he married **Ethel Jenny Dukeshire** in Newburyport, Mass. Born in 1902. Ethel Jenny died in 1944; she was 42.

Long Family of Annapolis County, NS

They had the following children:

- i. **Winola**. Born in 1920.

Winola married **Ralph Williams**.
- ii. **Gerald**. Born in 1921.

Gerald married **Helen Hallock**.
- iii. **Florence**. Born in 1923.

Florence married **Alfred O'Conner**.
- iv. **Mildred** (Died as Child). Born in 1925.
- v. **Howard Wallace**. Born on 11 Mar 1932. Howard Wallace died on 17 Jun 2011; he was 79.

Howard Wallace "Howie" Long, Ret. Saugus Police Dept. Chief of Inspectors, formerly of Saugus, died Thursday, June 17, 2011 at the Oxford Rehabilitation Center in Haverhill, following hip surgery and a lengthy illness with his daughter at his side. He was the beloved husband of the late Lois Jean (Pye) Long. He was born on March 11, 1932 to the late Ethel Jenny (Dukeshire) and Howard T. Long at the family home on Long Place in Saugus. Howie briefly worked for the family concrete business also located on Long Place before joining the military. He served with the 101st Airborne Division of the U.S. Army Air Corp. during the Korean war. After completion of service for our country he joined the Saugus Police Dept. serving as Patrolmen, Safety Officer, Dog Officer, Narcotics Officer, Detective and Chief of Inspectors. When he retired from the Saugus Police Dept. after 28 years he moved to Seabrook, NH. He then worked for the Seabrook Greyhound Race Track as the Presiding Judge for over a decade. He was the loving father of Susan Jean Moutsoulas and Howard Wallace Long, Jr. Grandfather of George Moutsoulas, Alexander Moutsoulas, Irene Moutsoulas, Marissa Long & Megan Long. Great grandfather of Nicholas Schultz. Brother of the late Winola Williams, Gerald Long, Florence O'Connor & Mildred Long. Also survived by many nieces, nephews, brother's in-laws, sister's in-laws and by his dear friend Jean MacDougal and her family.

Howard Wallace married **Lois Pye**.

Family of Thomas Roby Long (18) & Jane "Jennie" Milbury

59. Ralph Watson Long (*Thomas Roby⁴, William Bennett³, Peter², Jacob Peter Lange¹*). Born on 29 Jul 1881 in Clementsport, Annapolis Co., NS. Ralph Watson died in 1969; he was 87. Residence: 1921 Census Clementsport.

Ralph W. Long, 1881-1969; wife Zeddie V. (Wright) 1884-1957; Gillenford R. 1908-1944; Elmore 1918-1979; Verna 1912-1989; William M. Ring 1899-1948; wife Lillian Esther 1902-1979 (Clementsvalle Cemetery)

Note: I am confused by the birth registrations in NSHVS of Darrel and Dennis, twins, s/o Ralph and Zeddie, b. same day as Corey and Clyde, also twins. Corey and Clyde are not registered in NSHVS.

On 6 Dec 1906 when Ralph Watson was 25, he married **Zeddie Viola Wright**, daughter of **Deacon Aaron Wright** (14 Aug 1847-24 Jun 1932) & **Mary Jeanette Chute** (6 Jan 1851-22 Dec 1923), in Princedale, Anna. Co., NS. Born on 22 Oct 1884 in Princedale, Anna. Co., NS. Zeddie Viola died in Clementsport, Annapolis Co., NS, on 18 Dec 1957; she was 73.

Long Family of Annapolis County, NS

They had the following children:

- i. **Glenford Roscoe**. Born on 3 Jan 1908 in Clementsport, Annapolis Co., NS. Glenford Roscoe died in Clementsport, NS, on 26 Mar 1944; he was 36. He was never married.
- ii. **Ethel Viola**. Born on 28 Mar 1909 in Clementsvale, Annapolis Co., NS. Ethel Viola died in 1947; she was 37.

Ethel Viola married **Bernard A. Dean**.
- iii. **Wylie Gordon**. Born on 30 Jun 1910 in Clementsvale, Annapolis Co., NS. Wylie Gordon died in Shad Bay, Halifax, NS, on 19 Apr 1983; he was 72.

Sons Gordon, Grant and Paul.

On 14 Jun 1935 when Wylie Gordon was 24, he married **Inez Edwina Baltzer** in Granville Ferry, NS. Born on 17 Jan 1910. Inez Edwina died in Middleton, NS, on 18 Sep 1976; she was 66. Buried in Aylesford, Kings Co., NS. Marriage was annulled in 1971.
- iv. **Vera Eileen**. Born on 11 Jun 1912. Vera Eileen died on 8 Jun 1989; she was 76. Residence: Halifax.

On 29 Jul 1946 when Vera Eileen was 34, she married **Donald Aubrey Payne** in Pictou, NS. Born in 1918 in Amherst, NS. Donald Aubrey died in Halifax NS, on 15 Jun 1999; he was 81.
- 119 v. **Lindsay Eugene** (23 Jan 1914-23 Nov 1963)
- vi. **Clyde Maxwell** (Twin). Born on 21 Jan 1917. Clyde Maxwell died in Greenfield Park, Longueuil, QC, on 26 Jul 1993; he was 76. Residence: Montreal.

Clyde Maxwell married **Naomi Ward**.
- 120 vii. **Corey Milton** (Twin) (21 Jan 1917-19 Feb 1988)
- viii. **Darrell Waldo Irving** (Twin). Born on 21 Jan 1917 in Power Lot, Clementsvale.
- ix. **Dennis Walter Raymond** (Twin). Born on 21 Jan 1917 in Power Lot, Clementsvale.
- x. **Elmore Summerville**. Born on 15 Oct 1918 in Clementsvale, Annapolis Co., NS. Elmore Summerville died in Jun 1979; he was 60. He was never married.
- 121 xi. **Thane V.** (1924-17 Jan 2018)

Family of Althea Ann Long (19) & Thomas Ansley Sanford

60. Hobart Albertus Sanford (*Althea Ann Long⁴, William Bennett³, Peter², Jacob Peter Lange¹*). Born on 21 Jul 1877 in Clementsvale, Annapolis Co., NS. Hobart Albertus died in Asbury Park, Monmouth, NJ, in Mar 1975; he was 97.

On 1 Sep 1908 when Hobart Albertus was 31, he married **Mary B. Waterman** in Buffalo, NY. Born in 1876 in Worcester, MA.

They had the following children:

- i. **James Hobart**. Born on 8 Aug 1910.
- ii. **Norma Isabel**. Born on 15 Aug 1912.
- iii. **Ruth Waterman**.
- iv. **Doris Althea**.

61. Clarence Higgins Sanford (*Althea Ann Long⁴, William Bennett³, Peter², Jacob Peter Lange¹*). Born on 11 Jan 1887 in Allston, Mass. U.S.A. Clarence Higgins died in Exeter, Rockingham, NH, on 13 Mar 1965; he was 78.

Long Family of Annapolis County, NS

Clarence Higgins married **Emily May Keyes**. Born on 22 Aug 1887 in Roxbury, Mass. Emily May died in East Kingston, Rockingham, NH, in May 1978; she was 90.

d/o James. H. Keyes and Emily Stevens

They had one child:

- i. **Richard Ainsley**. Born on 13 Dec 1916 in Allston, Mass. U.S.A.

Family of Jacob Whitman Long (20) & Izetta J. Ritchie

62. James "Leonard" Long (*Jacob Whitman⁴, William Bennett³, Peter², Jacob Peter Lange¹*). Born on 29 Nov 1886 in Bear River East, N.S. James "Leonard" died in Lynn, Essex Co., Mass., in Dec 1936; he was 50. Buried in Pine Grove Cemetery, Lynn, MA.

On 8 Nov 1908 when James "Leonard" was 21, he married **Della J. Kelly** in Lynn, Essex Co., Mass. Born in 1885 in Ireland. Della J. died in Lynn, MA, in Apr 1940; she was 55.

They had one child:

- i. **Florence Louise**. Born on 18 Nov 1912 in Lynn, Essex Co., Mass. Florence Louise died in Lynn, Mass., on 10 Jul 1981; she was 68.

In 1937 when Florence Louise was 24, she married **Thomas Edward Healey** in Lynn, Mass. Born on 20 Oct 1913 in Lynn, Mass. Thomas Edward died in Lynn, Mass., on 30 Jan 1985; he was 71.

63. Harold Hastings Long (*Jacob Whitman⁴, William Bennett³, Peter², Jacob Peter Lange¹*). Born on 11 Jun 1889 in Bear River East, N.S. Harold Hastings died in Chelsea, Mass., in 1939; he was 49. Residence: Lynn, Mass.

On 19 Jun 1918 when Harold Hastings was 29, he married **Katherine Finley** in Lynn, Mass. Born on 11 Nov 1889 in Lorne, Pictou Co.

They had the following children:

- i. **Harold Jason** (Died as Infant). Born in 1920. Harold Jason died in 1921; he was 1.
- ii. **Robert G.**
- iii. **Jean I.**
- iv. **Barbara C.**

64. Otto Long (*Jacob Whitman⁴, William Bennett³, Peter², Jacob Peter Lange¹*). Born on 20 Mar 1897 in Bear River East, N.S. Otto died on 18 Dec 1975; he was 78.

Otto married **Reta Mae Chute**. Born in 1901. Reta Mae died on 24 May 1976; she was 75.

They had the following children:

- | | | |
|------------|-----|---|
| 122 | i. | Lewis Otto (28 Aug 1923-31 Oct 2011) |
| 123 | ii. | Hilda Marie (6 Jul 1932-) |

65. Milton Long (*Jacob Whitman⁴, William Bennett³, Peter², Jacob Peter Lange¹*). Born on 10 Sep 1899 in Bear River East, N.S. Milton died in Lynn, Mass., on 5 Jan 1963; he was 63. Buried in Pine Grove Cemetery, Lynn, MA.

Long Family of Annapolis County, NS

On 26 Feb 1919 when Milton was 19, he married **Esther Jennette Coombs** in Bear River, Digby Co., NS. Born in 1898.

They had the following children:

- i. **Katherine**. Born on 21 May 1925 in Lynn, Mass. Katherine died in Lynn, Mass., on 12 Jul 2015; she was 90.

Katherine married **Richard Eichel**. Born on 10 Apr 1922. Richard died on 13 Mar 2002; he was 79.
- ii. **Richard**.
- iii. **John**. Born in 1929.
- iv. **Gilbert**. Born on 15 Dec 1930 in Lynn, Mass.

Family of Corey O'Dell Long (21) & Ella Mae Beeler

66. James "Parker" Long (*Corey O'Dell⁴, William Bennett³, Peter², Jacob Peter Lange¹*). Born on 17 Jun 1895 in Clementsvale, Annapolis Co., NS. James "Parker" died in Clementsvale, Annapolis Co., NS, on 31 Jul 1956; he was 61.

On 27 Jun 1928 when James "Parker" was 33, he married **Frances Marion Gesner**. Born on 10 Sep 1907 in Belle Isle, Anna. Co., NS. Occupation: School Teacher.

They had the following children:

- i. **Raymond**. Born on 28 Jan 1929.
- 124 ii. **Reginald Nelson** (4 Apr 1930-21 Mar 2018)
- 125 iii. **Gerald Parker** (15 Nov 1931-24 Apr 2017)

67. Marion Dorothy Long (*Corey O'Dell⁴, William Bennett³, Peter², Jacob Peter Lange¹*). Born on 18 Aug 1898 in Clementsvale, Annapolis Co., NS. Marion Dorothy died in Clementsvale, Annapolis Co., NS, on 7 Aug 1958; she was 59.

On 18 Feb 1920 when Marion Dorothy was 21, she married **Clifford James Sanford**. Born on 14 Jul 1896 in Clementsport, NS. Clifford James died in Annapolis Royal, NS, on 14 Feb 1975; he was 78.

s/o Zenas Sanford and Annie Fraser

They had one child:

- i. **Clifford Otis**. Born on 16 May 1920. Clifford Otis died on 10 Nov 1981; he was 61.

On 6 Mar 1943 when Clifford Otis was 22, he married **Alythe Lottie Coombs**. Born in 1920 in Lake Jolly, Digby Co. Alythe Lottie died in Dartmouth, N.S., on 12 Jan 2014; she was 94.

Family of Henry "Fletcher" Long (23) & Lillian Frances Scheffer

68. George Edward Long (*Henry "Fletcher"⁴, William Bennett³, Peter², Jacob Peter Lange¹*). Born on 12 Nov

Long Family of Annapolis County, NS

1885 in Clementsvale, Annapolis Co., NS. George Edward died in Bear River East, N.S., on 30 Sep 1925; he was 39.

On 9 Nov 1904 when George Edward was 18, he first married **Mabel Milbury** in Clementsvale, Annapolis Co., NS. Born on 5 Oct 1888 in Bear River, Digby Co., NS. Mabel died on 12 May 1921; she was 32.

They had the following children:

- 126** i. **Lester Durant** (2 Jul 1905-25 Feb 1976)
- ii. **George E.** Born on 26 Jun 1910 in Clementsvale, Annapolis Co., NS.
- iii. **George "Warren"**. Born on 20 Mar 1911. George "Warren" died in May 1986; he was 75.

Children Judith and Brian.

George "Warren" married **Freda Pick**. Born in 1918 in White Rock, Kings Co., NS. Freda died in Kentville, NS, on 2 Mar 2008; she was 90.

- iv. **Lawrence Edward**. Born on 21 Nov 1913 in Bear River East, N.S. Lawrence Edward died in England on 5 Jan 1985; he was 71.
- v. **Gordon Albert**. Born on 26 Apr 1918 in Clementsvale, Annapolis Co., NS. Gordon Albert died in Kentville, NS, on 7 Mar 1959; he was 40.
- 127** vi. **Willard Wallace** (10 Feb 1920-)

On 12 Sep 1923 when George Edward was 37, he second married **Sadie Lee Mailing**. Born in 1900.

d/o Charles Mailing and Maude Berry

69. Beatrice Martha Long (*Henry "Fletcher"*⁴, *William Bennett*³, *Peter*², *Jacob Peter Lange*¹). Born on 11 Nov 1887 in Clementsvale, Annapolis Co., NS. Beatrice Martha died in Digby, NS, on 17 Jan 1962; she was 74.

On 25 Dec 1907 when Beatrice Martha was 20, she married **William Howard Potter**, son of **Robert Jefferson Potter** (25 Dec 1858-5 Sep 1943) & **Annie Milner Wright** (20 Jan 1866-30 Jun 1948), in Clementsport, NS. Born on 22 Jun 1888 in Clementsvale, Annapolis Co., NS. William Howard died on 22 Apr 1971; he was 82.

They had the following children:

- 128** i. **Russell Devernett** (23 Sep 1908-29 Oct 1985)
- ii. **Trueman Oscar**. Born on 3 Dec 1913. Trueman Oscar died in Clementsvale, Annapolis Co., NS, on 24 Nov 1983; he was 69.

On 27 Sep 1943 when Trueman Oscar was 29, he married **Isabelle Rose Milner**. Born on 27 Sep 1922.

- 129** iii. **Murray Eldon** (11 Jul 1915-10 May 1989)
- 130** iv. **Gladys Mae** (1 Apr 1917-24 Jun 1994)
- 131** v. **Frances Lillian** (12 Dec 1919-)
- 132** vi. **Flora Annie** (18 Mar 1922-26 Jan 2001)
- 133** vii. **Betty Levone** (17 Apr 1928-)

70. Goldie Vivian Long (*Henry "Fletcher"*⁴, *William Bennett*³, *Peter*², *Jacob Peter Lange*¹). Born on 29 Jun 1900 in Clementsvale, Annapolis Co., NS. Goldie Vivian died in Sandy Cove, Digby Co., NS, on 2 Jun 1983; she was 82.

On 25 Nov 1919 when Goldie Vivian was 19, she married **Hartford Thorold Long (71)**, son of **24. Joel Daniel**

Long Family of Annapolis County, NS

Long (27 Sep 1865-2 Jun 1948) & **Margaret Weiland** (20 Apr 1877-11 Sep 1963), in Bear River East, N.S. Born on 10 Jan 1898 in Bear River East, N.S. Hartford Thorold died in Sandy Cove, Digby Co., NS, on 21 Feb 1947; he was 49.

They had one child:

- i. **Kathleen**. Born in 1921 in Bear River East, N.S. Kathleen died in Liverpool, NS, on 26 Mar 1998; she was 77.

Kathleen first married **Stanley Neil**.

Kathleen second married **Maurice Whynaucht**.

Family of Joel Daniel Long (24) & Margaret Weiland

71. Hartford Thorold Long (*Joel Daniel⁴, William Bennett³, Peter², Jacob Peter Lange¹*). Born on 10 Jan 1898 in Bear River East, N.S. Hartford Thorold died in Sandy Cove, Digby Co., NS, on 21 Feb 1947; he was 49.

On 25 Nov 1919 when Hartford Thorold was 21, he married **Goldie Vivian Long (70)**, daughter of **23. Henry “Fletcher” Long** (8 Dec 1860-2 Oct 1929) & **Lillian Frances Scheffer** (6 Jul 1865-22 Jun 1912), in Bear River East, N.S. Born on 29 Jun 1900 in Clementsvale, Annapolis Co., NS. Goldie Vivian died in Sandy Cove, Digby Co., NS, on 2 Jun 1983; she was 82.

They had one child:

- i. **Kathleen**. Born in 1921 in Bear River East, N.S. Kathleen died in Liverpool, NS, on 26 Mar 1998; she was 77.

Kathleen first married **Stanley Neil**.

Kathleen second married **Maurice Whynaucht**.

72. Grace Elizabeth Long (*Joel Daniel⁴, William Bennett³, Peter², Jacob Peter Lange¹*). Born on 16 Mar 1902 in Bear River East, N.S.

On 6 Apr 1920 when Grace Elizabeth was 18, she married **Forrest Parker Fraser** in Bear River, Digby Co., NS. Born in 1898 in Prinedale, Anna. Co., N.S.

s/o George Fraser and Lottie LeCain

They had the following children:

- i. **Keith**.

Keith was in the tank division, Canadian Army, WW II, Italy and Africa.

Keith married **Juanita Brown**.

- ii. **Phyllis**.

Phyllis married **Herbert Trimper**.

- iii. **Lorge**. Born on 2 Aug 1923.

Long Family of Annapolis County, NS

Long married **Gladys Harvey**. Born in Deep Brook, Anna. Co., N.S.

Family of Daniel "Emerson" Long (25) & Elizabeth Ann Meuse

73. Joseph Warren Long (*Daniel "Emerson"⁴, William Bennett³, Peter², Jacob Peter Lange¹*). Born on 16 Dec 1898 in Bear River East, N.S. Joseph Warren died in Montague, Franklin County, Massachusetts, on 28 Apr 1941; he was 42. Buried in Highland Cemetery, Montague.

In 1921 when Joseph Warren was 22, he married **Margaret King**. Born on 19 Sep 1900 in Hinsdale, New Hampshire. Margaret died on 20 Nov 1961; she was 61.

They had the following children:

- i. **Richard Emerson.**
- ii. **Guy Laverne.**

Guy Laverne married **Helen Chamberlain**.

74. Waldo Emerson Long (*Daniel "Emerson"⁴, William Bennett³, Peter², Jacob Peter Lange¹*). Born on 25 May 1903 in Bear River East, N.S. Waldo Emerson died in Carroga Park, California, on 10 Nov 1978; he was 75. Occupation: Long's Tea Room and Motel, Irving, Mass., since 1925.

Waldo bought Long's Tea Room from his father. They enlarged it, built living quarters for themselves, and built a 5-unit motel (1954). "Many a traveler has stood in the shady lane and enjoyed the 60-mile view of the Pioneer Valley and Holyoke Range."³¹ Following Bertha's death in 1968, he sold the property to his sister Helen's son Barry Brocklesby

On 16 Sep 1924 when Waldo Emerson was 21, he first married **Josephine Lemaire** in Athol, Mass.

They had one child:

- i. **David Emerson.** Born on 3 Jun 1927.

David Emerson married **Christobol Stevens**.

Waldo Emerson second married **Bertha Perkins Dykes**.

75. Charlotte Elizabeth Long (*Daniel "Emerson"⁴, William Bennett³, Peter², Jacob Peter Lange¹*). Born on 5 Jan 1905 in Bear River East, N.S. Charlotte Elizabeth died in Phoenix, AZ, on 3 Feb 1986; she was 81.

On 6 Jun 1923 when Charlotte Elizabeth was 18, she married **George William Cote**. Born in Turner's Falls, Mass.

They had the following children:

- i. **George N.** George N. died in Died at sea, WW2.
- ii. **Jacqueline Lois.** Born on 9 May 1928.

- iii. On 16 Apr 1945 when Jacqueline Lois was 16, she married **Leonard Wright.**
William Emerson.

William Emerson married **Shirley Lenhart**. Born in fosteria, Ohio.

Long Family of Annapolis County, NS

- iv. **Elizabeth Ann.** Born on 29 Mar 1938.

Elizabeth Ann married **Laurence Pisano.**

76. Althea Priscilla Long (*Daniel "Emerson"⁴, William Bennett³, Peter², Jacob Peter Lange¹*). Born in Oct 1909 in Lynn, Mass. Althea Priscilla died in Ervingside, Millers Falls, Mass., on 17 Jan 1969; she was 59. Buried in Highland Cemetery, Millers Falls, Mass.

On 27 Sep 1926 when Althea Priscilla was 16, she first married **Frederick Felton.** Born in 1909 in Stafford, Tolland Co., CT. They were divorced.

They had the following children:

- i. **Robert Clifford.** Born on 22 Apr 1927.
- ii. **Richard Long** (Died as Child). Born on 21 Jun 1930.

On 27 Aug 1938 when Althea Priscilla was 28, she second married **Frederick Irving Morse.** Born on 16 Jan 1913 in Southbridge MA. Frederick Irving died in Erving, Mass., in 1957; he was 43.

They had the following children:

- i. **Frederick Arthur.** Born on 19 Apr 1947. Frederick Arthur died in Springfield, MA, on 2 Jun 1966; he was 19.
- ii. **Avis Adeline.** Born on 9 Mar 1948.

77. Pearl Jeanette Long (*Daniel "Emerson"⁴, William Bennett³, Peter², Jacob Peter Lange¹*). Born on 7 Feb 1915 in Lynn, Mass. Pearl Jeanette died in Jacksonville, Vermont, on 6 Mar 1972; she was 57.

Died in a car accident with her daughter Rosemary.

Pearl Jeanette married **Ward Cromack.** Born on 27 May 1913 in Colrain, Franklin Co., MA. Ward died in Greenfield, MA, on 8 Jun 1989; he was 76.

They had the following children:

- i. **Ward David "Peter".**

Ward David "Peter" married **June Dix.**
- ii. **Ann Susan.**

Ann Susan married **Richard Gray.**
- iii. **Carol Lorraine.**

Carol Lorraine married **William Bolt.**
- iv. **Mark.**

Mark married **Elaine Dove.**
- v. **Rosemary.** Born on 1 Dec 1955. Rosemary died in Bennington, VT, on 6 Mar 1972; she was 16.

78. Irene Francis Long (*Daniel "Emerson"⁴, William Bennett³, Peter², Jacob Peter Lange¹*). Born on 3 Jun 1917 in Erving, Mass. Irene Francis died in Springfield, MA, on 26 Jun 2016; she was 99.

Long Family of Annapolis County, NS

Irene "Himmie" F. (Long) Cole, 99, of Old State Rd. in Erving died Sunday 6-26-16 at Baystate Medical Center in Springfield. She was born in Erving on June 3, 1917, the daughter of David E. and Elizabeth A. (Meuse) Long. Irene attended local schools and was a graduate of Turners Falls High School Class of 1935 as a pro merito student. On November 30, 1935, Irene married her beloved husband, Hervey "Kibby" L. Cole of Millers Falls and they resided in the original homestead where she was born. For over 80 years, Irene was a devout member of the former First Congregational Church of Millers Falls, currently Covenant Church, and a choir member for over 50 years. Irene was a receptionist for the Millers Falls Paper Company for 25 years until her retirement in 1981. She was a life member of the Erving Historical Society and for many years she was the secretary there. Irene enjoyed golf, dancing and crossword puzzles. She loved her friends, and especially loved her family and her grandchildren. Among her survivors, Irene leaves her son, Gary Cole and his wife Linda of Athol, eight grandchildren, Ken (Kathy) Mattson, Leann Zembower, Tracy (Micki) Sigler, Carrie Lu (Tim) Corle, Eric (Susan) Cole, Benjamin (Lea) Cole, Elizabeth (Jeff) McLean and Lisa (Jessica) Cole; thirteen great-grandchildren, Ryan Mattson, Josh Mattson, Dale Sigler, Amber Sigler, Joshua Corle, Andrew Corle, Jeffrey Zembower, Steven Zembower, Teresa Zembower, Leif Cole, Duncan Cole, Jacob Mclean and Eva Cole, and many great great grandchildren. Irene was predeceased by her husband of 74 years, Hervey "Kibby" Cole on July 23, 2009 and a daughter, Sandra A. Mattson in 1987.

On 30 Nov 1935 when Irene Francis was 18, she married **Hervey L. Cole**. Born on 12 May 1913 in Millers Falls, Montague, Mass. Hervey L. died in Erving, Mass., on 23 Jul 2009; he was 96.

They had the following children:

- i. **Sandra Ann**. Born on 20 Jan 1938.

- ii. On 6 Jul 1956 when Sandra Ann was 18, she married **Norman K. Mattson**.
Gary Evans. Born on 11 Aug 1947.

Gary Evans first married **Christine Krlic**.

Gary Evans second married **Linda Gibbs**.

79. Helen Marion Long (*Daniel "Emerson"⁴, William Bennett³, Peter², Jacob Peter Lange¹*). Born on 26 Aug 1919 in Erving, Mass. Helen Marion died on 8 Feb 2011; she was 91. Buried in Highland Cemetery, Montague.

On 2 Aug 1940 when Helen Marion was 20, she married **Russell Percy Brocklesby**. Born on 12 Dec 1915 in Greenville, Mass. Russell Percy died in Greenfield, MA, on 19 Nov 2010; he was 94.

They had one child:

- i. **Barry Russell**. Born on 25 Feb 1947 in Montague City, Mass.

Barry and his wife bought his grandfather's business, Long's Tea Room, Erving, Mass., from his Uncle Waldo Long.

Barry Russell married **Elizabeth MacKey**. Born on 2 Feb 1949 in Orange, Mass.

Family of Wesley "Manning" Long (27) & Minnie McSwain

80. Estella Maude Long (*Wesley "Manning"⁴, William Bennett³, Peter², Jacob Peter Lange¹*). Born on 21 Dec 1913 in Bear River East, N.S. Estella Maude died on 29 Oct 1976; she was 62.

Estella Maude married **Daniel Hayward**.

Long Family of Annapolis County, NS

They had the following children:

- i. **Daniel Joseph**. Born in 1935.

Daniel Joseph married **Shirley Conway**.
- ii. **Jean Louise**. Born in 1936. Residence: Pembroke, Mass.

Jean Louise married **Michael Gorman**.
- iii. **Carol**. Born in 1937. Residence: Marco Island, Florida.

Carol married **William Bennett**.
- iv. **Thomas Joseph**. Born in 1940.
- v. **Elizabeth Mae**. Born in 1941. Residence: Buena Park, California.

Elizabeth Mae married **Raymond Shade**.

Family of Ella S. Long (34) & John Peck

81. Enoch Peck (*Ella S. Long⁴, Ephraim Daniels³, Peter², Jacob Peter Lange¹*). Born on 1 Apr 1889.

Clementsvalle Cemetery, Peck Enoch 1889-1961 Ella 1896-1979

Enoch married **Ella Lutz**.

They had one child:

- i. **Enoch**. Born on 9 Sep 1934. Enoch died in Annapolis Royal, NS, on 11 Feb 2012; he was 77.

Peck, Enoch "Junior" 77 of Bear River, passed away in Annapolis Royal Health Centre Saturday February 11th, 2012. Born September 9, 1934 in Greenland, Annapolis Co. Junior was a son of the late Enoch and Ella (Lutz) Peck. Junior was a cook at C.F.B. Cornwallis, later at Digby General Hospital, retiring in 1994. Junior was a member of the Bear River Baptist Church, Bear River Fire Dept., Bear River Health Clinic and an associate member of the Bear River Legion Branch #22. Junior volunteered for many groups including the Trimper Family Reunion Committee. Junior will be missed greatly by all his family and friends, especially his dog Roxie. He is survived by his wife of 53 years, Lillas (Trimper), Bear River; son, Lindsay, Edmonton, Alb.; sisters, Martha Bourassa, Digby; Alice (Willis) Trimper and Joan (Don) Wright, both of Bear River East; brothers, Howard (Mary), Bridgetown and Orrin (Becky), Yarmouth. Besides his parents, Junior was predeceased by sisters, Daisy and Doroth

Family of John Edward Trimper (35) & Emma E. Beeler

82. Miriam Ann Trimper (*John Edward⁴, Lydia Jane Long³, Peter², Jacob Peter Lange¹*). Born on 7 Feb 1884 in Clementsvalle, Annapolis Co., NS. Miriam Ann died in Virginia, Anna. Co., N.S., on 14 Dec 1913; she was 29.

On 16 Aug 1905 when Miriam Ann was 21, she married **Harley Oberlyn Potter**, son of **John Douglas Potter** (25 Apr 1853-26 May 1939) & **Sabra Ann Potter** (22 Apr 1854-16 Aug 1941), in Clementsvalle, Annapolis Co., NS.

Long Family of Annapolis County, NS

Born on 13 Sep 1881 in Clementsvale, Annapolis Co., NS. Harley Oberlyn died in Virginia, Annapolis Co., NS, on 27 Jul 1934; he was 52.

The Weekly Monitor, Bridgetown, Wednesday, August 8, 1934

Harley Potter died at his home in Virginia on Friday evening, July 27th. Funeral services were held at the home of his son, Owen, with whom he lived, on Sunday afternoon, July 29. He is survived by his mother, Mrs Sabra Potter of Clementsvale; 3 sons: Owen and Loran of Virginia; Gordon of Waltham, Mass., and 1 daughter, Mrs Frank Cashman of Princedale; 2 sisters: Mrs William Crouse and Mrs LL Henshaw of Clementsvale; 3 brothers: Kenneth of Virginia; Frank of Clementsvale and Reginald of Bear River. Reverend CC Blanchard of Bear River officiated. His wife, who was Miss Miriam Trimper of Clementsvale, passed away 20 years ago.

They had one child:

- 134** i. **Loran Dalton** (5 Feb 1912-10 Apr 1971)

Family of Thomas Henry Trimper (37) & Elena Jane Wright (43)

83. George Wickup Trimper (*Thomas Henry⁴, Lydia Jane Long³, Peter², Jacob Peter Lange¹*). Born on 14 Feb 1889 in Clementsvale, Annapolis Co., NS. George Wickup died in Clementsvale, Annapolis Co., NS, on 8 May 1947; he was 58. Buried in Clementsvale Cemetery.

On 28 May 1915 when George Wickup was 26, he married **Emma Jeanetta Earley**. Born on 14 Jan 1898. Emma Jeanetta died on 9 Mar 1970; she was 72.

Mrs Emma Janet Trimper, 72, of Wolfville, died at her home. Born at Annapolis Royal, she was the daughter of Elias and Mae (Jenkins) Earle. She leaves 2 sons: Dean, Halifax; Clinton, Clementsvale; 2 daughters: Pauline, Mrs Merle Skerry, Wolfville; Marilyn, Mrs Larry Machum, Saint John, Nova Scotia [sic]; 4 sisters: Mrs Bessie Olsen, New Mexico; Dolly, Mrs Thomas Leahey and Mrs Hattie Custer, both of Florida; Addie Ryan, Boston; 2 brothers: William Earle, Boston, and Roy Earle, California. Funeral was Wednesday at the HC Lindsay Funeral Home, Wolfville, Reverend Austin MacPherson officiating. The body was then transferred to the Clementsvale Baptist Church where another funeral service was held, Reverend H Price officiating. Interment was in the Church Cemetery. (Annapolis Spectator, Tuesday, March 17, 1970)

They had the following children:

- i. **Robert Leroy** (Died as Infant). Born in Oct 1915. Robert Leroy died in Oct 1915; he was <1.
- 135** ii. **Huldah Pauline** (25 Dec 1916-Aug 2002)
- 136** iii. **Clinton Allen** (2 Mar 1919-21 Oct 2007)
- 137** iv. **Ralph Raymond** (24 Jul 1920-11 Mar 1967)
- 138** v. **Dean Milton** (11 Feb 1928-19 May 2000)
- 139** vi. **Marilyn Joyce** (4 Dec 1933-)

Long Family of Annapolis County, NS

Sixth Generation

Family of Herman Augustus Brown (46) & Bessie Olivia Wright

99. Wellington Augustus Brown (*Herman Augustus⁵, Martha Long⁴, Jacob³, Peter², Jacob Peter Lange¹*). Born on 1 Jul 1890 in West Springhill, Anna. Co., NS. Wellington Augustus died in West Springhill, Anna. Co., NS, on 5 Feb 1982; he was 91.

On 24 Dec 1924 when Wellington Augustus was 34, he married **Helen Louise Nauss**. Born in 1905 in Lake Munro, Anna. Co., NS. Helen Louise died in South Milford, on 9 Nov 1972; she was 67.

They had the following children:

- 174**
- i. **Warren Lenly** (19 Nov 1925-)
 - ii. **Celia**. Born on 17 Nov 1927.

Celia married **Austin Hearn**.

Family of Daniel Howard Long (48) & Fannie Elizabeth White

100. Mildred Freda Long (*Daniel Howard⁵, William "Harris"⁴, William Bennett³, Peter², Jacob Peter Lange¹*). Born on 6 Feb 1892 in Deep Brook, Anna. Co., N.S. Mildred Freda died on 6 Mar 1968; she was 76. Residence: Deep Brook; Clementsport.

On 12 Jun 1918 when Mildred Freda was 26, she married **William Sebra Berteaux** in Deep Brook, Anna. Co., N.S. Born in 1894 in Deep Brook, N.S. Occupation: Land surveyor.

They had the following children:

- i. **Iylah Mildred**. Born on 14 Apr 1919 in Deep Brook, Anna. Co., N.S. Iylah Mildred died on 24 Sep 1943; she was 24.

On 24 Jun 1939 when Iylah Mildred was 20, she married **Douglas Densmore Riley**.

Son of John and Alice (Trimper) Riley.

- ii. **Annie Marie**. Born on 27 Apr 1921 in Deep Brook, Anna. Co., N.S.

On 6 Dec 1945 when Annie Marie was 24, she married **Randolph Wellington Kearnes**. Born on 19 Jul 1922. Randolph Wellington died on 29 Mar 1978; he was 55.

- iii. **William Francis**. Born on 11 Aug 1923 in Deep Brook, Anna. Co., N.S.

On 5 Jun 1946 when William Francis was 22, he married **Phyllis Marion Hicks**.

101. Roy Lorimer Long (*Daniel Howard⁵, William "Harris"⁴, William Bennett³, Peter², Jacob Peter Lange¹*). Born on 1 Dec 1898 in Deep Brook, Anna. Co., N.S. Residence: Allston, Mass.

Roy Lorimer married **Ruth Mahan**. Ruth died on 19 Jan 1977.

They had the following children:

Long Family of Annapolis County, NS

- 175** i. **David Roy** (18 Jun 1926-)
 ii. **Donald E.** Born in 1927. Residence: Braintree, Mass.
- Donald E. married **Mary Jane Carll**.
 iii. **Elizabeth R.**
- Elizabeth R. married **Sterling Ulrich**.
176 iv. **Robert Lee** (28 Mar 1933-17 May 1988)
 v. **Dorothy Maisie**. Born in Aug 1934. Dorothy Maisie died on 15 Jun 1987; she was 52.
- Dorothy Maisie married **John Bantoloneo**. Residence: Chevy Chase, MD.
177 vi. **Daniel H.** (3 Feb 1939-)

102. Walter Purdy Long (*Daniel Howard*⁵, *William "Harris"*⁴, *William Bennett*³, *Peter*², *Jacob Peter Lange*¹). Born on 20 Apr 1904 in Deep Brook, Anna. Co., N.S. Walter Purdy died on 6 Jan 1965; he was 60.

Walter Purdy married **Greta Lawson**. Greta died on 15 Jan 1987.

They had one child:

- 178** i. **Walter Purdy** (23 Aug 1929-)

Family of Fred Chipman Long (49) & Frances Amelia Morgan

103. Rev. Fred Burton Long (*Fred Chipman*⁵, *William "Harris"*⁴, *William Bennett*³, *Peter*², *Jacob Peter Lange*¹). Born on 14 Jan 1894 in Brighton, MA. Fred Burton died in Clementsport, Annapolis Co., NS, on 19 May 1966; he was 72. Education: B. Theol. and Div., Gordon College, Boston, 1927 and 1929.

Rev. Fred Long held Baptist pastorates in Arthurette, New Brunswick (1918-1923), West Bridgewater Baptist Church, Mass. (1923-1930), First Baptist Church, Milton, Mass. (1931-1938), Highfield St. Baptist Church, Moncton, New Brunswick (1938-1945), First Baptist Church, McKeesport, Pennsylvania (1946-1954) and in Indiana, Pennsylvania (1954-1964). They retired to Clementsport in 1964.

On 1 Jan 1919 when Fred Burton was 24, he married **Ruth Alicia King** in Greenwood, Mass. Born in 1892. Ruth Alicia died in 1981; she was 89.

They had the following children:

- i. **Ruth Alicia**. Born on 22 May 1921 in Arthurette, NB. Occupation: Dietitian, Faculty NE Baptist Hospital School of Nursing; Genealogist and author of the Long genealogy.
- ii. **Dorothy Myrtle**. Born on 13 Sep 1923 in Melrose, Mass.
- Dorothy Myrtle married **Frederick Peter Trebino**.
- 179** iii. **Fred Burton** (11 Aug 1926-26 Apr 1990)
- 180** iv. **Roberta Harris** (27 Jun 1932-)

104. Ormond Richard Long (*Fred Chipman*⁵, *William "Harris"*⁴, *William Bennett*³, *Peter*², *Jacob Peter Lange*¹). Born on 4 Jul 1899 in Somerville, Mass. Ormond Richard died on 14 Jun 1978; he was 78. Buried in Lake Grove Cemetery, Holliston, Mass. Residence: Waltham, Sherborn, Holliston and Medway, Mass.

Ormond Richard married **Caroline Mae Comey**. Born on 26 Feb 1903 in Worcester, MA. Caroline Mae died on 20

Long Family of Annapolis County, NS

May 1986; she was 83.

They had the following children:

- i. **Evelyn Viola**. Born on 25 Aug 1921 in Somerville, Mass.
On 8 Apr 1938 when Evelyn Viola was 16, she married **Fred A. Latown**.
- 181 ii. **Arthur Richard** (28 Dec 1922-)
- iii. **Caroline Edith**. Born on 29 Sep 1924 in Waltham, Mass.
On 23 Sep 1942 when Caroline Edith was 17, she married **Robert Arthur Demery**.
- 182 iv. **David Chipman** (10 Feb 1926-)
- 183 v. **Ormond Richard** (20 Oct 1928-)
- vi. **Eleanor Marie**. Born on 21 May 1931 in Waltham, Mass.
On 15 Nov 1954 when Eleanor Marie was 23, she married **Gordon Massie**.
- vii. **Bethel May**. Born on 28 May 1935.
On 6 Jun 1953 when Bethel May was 18, she married **Leo Flanagan** in Seabrook, NH.
Leo died on 6 Jul 1983.
- 184 viii. **Charles Comey** (28 Apr 1940-)
- ix. **Bruce Clyde**. Born on 7 May 1946 in Framingham, Mass.
On 16 Dec 1967 when Bruce Clyde was 21, he married **Geraldine C. LaVigne** in Chicopee, Mass.
- x. **Rebecca Anna**. Born on 13 Feb 1948.

105. Beatrice Viola Long (*Fred Chipman*⁵, *William "Harris"*⁴, *William Bennett*³, *Peter*², *Jacob Peter Lange*¹). Born on 9 Jun 1902 in Somerville, Mass. Beatrice Viola died in Belmont, Mass., on 25 Nov 1980; she was 78.

On 8 Jun 1933 when Beatrice Viola was 30, she married **Harold Henry Metts** in Somerville, Mass. Born in 1900. Harold Henry died in Allston, Mass. U.S.A., on 1 Apr 1959; he was 59.

They had the following children:

- i. **June Amelia Mary**. Born on 9 Jun 1935. June Amelia Mary died on 15 Jul 1982; she was 47.
June Amelia Mary married **David Levy**.
- ii. **Rederick Harold**. Born on 27 May 1939 in Cambridge, Mass. Rederick Harold died on 18 Mar 1989; he was 49. Occupation: Firefighter.
Rederick Harold married **Sandra Jardine Bryant**.

Family of William Bennett Long (50) & Lucinda Arbuthnot Sabean

106. Mabel Sophronia Long (*William Bennett*⁵, *William "Harris"*⁴, *William Bennett*³, *Peter*², *Jacob Peter Lange*¹). Born on 18 Jan 1901 in Allsbro, Mass.

On 18 Jun 1923 when Mabel Sophronia was 22, she married **Phili Raymond Hayes**. Born on 5 May 1901. Phili Raymond died in Torrington, CT, on 22 Dec 1985; he was 84.

Long Family of Annapolis County, NS

They had one child:

- i. **Beverly Arleen.** Born on 10 May 1925 in Boston, Mass.

On 23 Jun 1949 when Beverly Arleen was 24, she married **Carl Everett Kallgren.**

107. Edna Winifred Long (*William Bennett⁵, William "Harris"⁴, William Bennett³, Peter², Jacob Peter Lange¹*). Born on 21 Dec 1904 in Allston, Mass. U.S.A. Edna Winifred died on 22 Mar 1989; she was 84.

On 16 Oct 1936 when Edna Winifred was 31, she married **Ralph Sidney Davis** in Calcutta, India. Born on 21 Jul 1904 in Bedford, Mass. Ralph Sidney died in Nigeria on 26 Jun 1966; he was 61. Buried in Carlisle, Mass.

They had the following children:

- i. **Ralph William.** Born on 14 Jun 1942.
- ii. **Mark Bennett.** Born on 27 Apr 1948.

108. Vera May Long (*William Bennett⁵, William "Harris"⁴, William Bennett³, Peter², Jacob Peter Lange¹*). Born on 17 Jan 1907 in Allston, Mass. U.S.A. Vera May died on 19 Dec 1986; she was 79.

Vera May married **Edward T. Oldenburgh.** Born in May 1901 in Fredericton, NB. Edward T. died on 13 May 1982; he was 81. Occupation: Contractor/builder, large leisure boats; Commander Wollaston Boat Club.

They had the following children:

- i. **Chilson Edward** (Died as Infant). Born on 22 Nov 1925. Chilson Edward died in Jul 1926; he was <1.
- ii. **James Edward.** Born on 7 Apr 1929.

109. William Lovett Long (*William Bennett⁵, William "Harris"⁴, William Bennett³, Peter², Jacob Peter Lange¹*). Born on 1 Feb 1909 in Allston, Mass. U.S.A. William Lovett died on 18 Aug 1978; he was 69.

On 29 Nov 1934 when William Lovett was 25, he married **Ann Lamb Michie** in Allsbro, Mass. Born on 5 Jan 1907 in Windy Gates, Scotland.

They had one child:

- i. **Jo-Ann Lucinda.** Born on 17 Aug 1942 in Sudbury, MA.

On 11 Jul 1964 when Jo-Ann Lucinda was 21, she married **James Douglas Howe.** Born on 28 Sep 1939.

110. Eugene Arthur Long (*William Bennett⁵, William "Harris"⁴, William Bennett³, Peter², Jacob Peter Lange¹*). Born on 19 Dec 1914 in Allston, Mass. U.S.A.

On 19 Dec 1942 when Eugene Arthur was 28, he married **Ruth Bradford Hill** in Brookline, Mass. Born on 19 Apr 1920.

They had the following children:

- i. **Leslie Catherine.** Born on 8 Mar 1944.

On 16 Aug 1969 when Leslie Catherine was 25, she married **Marcus Tarkington.** Born in Oklahoma City, OK. Residence: Greenwich, CT.

- ii. **Lucinda Bradford.** Born on 18 Sep 1946.

Long Family of Annapolis County, NS

On 15 Jun 1968 when Lucinda Bradford was 21, she married **Richard Henry Kingsbury Victor**.

iii. **Margaret Jane**. Born on 29 Nov 1950.

On 25 Jan 1975 when Margaret Jane was 24, she married **David Frederick White**.

Family of Reginald Clayton Long (51) & Harriett (Hattie) Louise Perkins

111. Clayton Marshall Long (*Reginald Clayton*⁵, *William "Harris"*⁴, *William Bennett*³, *Peter*², *Jacob Peter Lange*¹). Born on 3 Sep 1914 in Deep Brook, Anna. Co., N.S. Clayton Marshall died on 22 Nov 2004; he was 90. Buried in Clementsvale Cemetery.

LONG, Clayton Marshall - 90, Deep Brook, Annapolis Co., passed away November 22, 2004, in Digby General Hospital. Born September 3, 1914 in Deep Brook, Annapolis Co., he was a son of the late Reginald and Harriett (PERKINS) LONG. He served in the Royal Canadian Air Force. He was a carpenter employed with CFB Cornwallis for 28 years where he was well-known for his expertise in carpentry. Clayton built several boats used for trout fishing. He had many hobbies which included photography, fishing and playing cards. Clayton enjoyed traveling, especially with his family to different parts of Canada. He was a wonderful father and grandfather and will be missed by all who knew and loved him. He is survived by son, Murray, Halifax; daughters, Elizabeth (Wayne) HALL, Porter's Lake, Digby Co.; and Judith (Dan) NICHOLS, Calgary, Alta.; grandchildren, Sherri SELIG, Bridgewater; Todd HALL, Halifax; Gregory HALL, Bear River; David LONG, Dartmouth; Joel LONG, Ottawa, Ont.; Robert BERRY and Kelly HANKE, both of British Columbia; Teresa STRATTON and Leah LADUKE, both of Alberta; eight great-grandchildren. He was predeceased by wife, Gertrude (SELIG); brother, Gordon.

On 27 Aug 1936 when Clayton Marshall was 21, he married **Gertrude Selig** in Deep Brook, Anna. Co., N.S. Born in 1917 in Grofton, Queens Co., NS.

d/o Solomon Selig, b. Lunenburg Co., and Bertha Weir (NSHVS).

They had the following children:

i. **Elizabeth Gertrude**.

Elizabeth Gertrude married **Wayne Hall**.

ii. **Murray Clayton**.

Murray Clayton married **Mary Ann Myers**.

iii. **Judy Ann**.

Judy Ann married **Robert Berry**.

Family of Harry Sufferin Long (52) & Gladys Jeanette O'Mara

112. Harry Burton Long (*Harry Sufferin*⁵, *William "Harris"*⁴, *William Bennett*³, *Peter*², *Jacob Peter Lange*¹). Born on 4 Nov 1916 in Clementsport, Annapolis Co., NS. Harry Burton died in Concord, Mass., on 29 May 1987; he was 70.

On 4 Aug 1946 when Harry Burton was 29, he married **Josephine T. O'Neill**.

Long Family of Annapolis County, NS

They had the following children:

- i. **Joanne Frances.** Born on 5 Oct 1947 in Boston, Mass.

On 7 Sep 1981 when Joanne Frances was 33, she married **Dr. John Kenison Stene.**
Occupation: University of Maryland.
- ii. **Patricia Ann.** Born on 27 Apr 1949.

On 4 Oct 1985 when Patricia Ann was 36, she married **George Martin LeVan** in
Concord, Mass. Born on 17 Nov 1945 in Winchester, Mass.

113. Darrel Douglas Long (*Harry Sufferin⁵, William "Harris"⁴, William Bennett³, Peter², Jacob Peter Lange¹*).
Born on 16 Apr 1918 in Clementsport, Annapolis Co., NS.

On 31 Oct 1947 when Darrel Douglas was 29, he married **Frances Gray.** Frances died in Allston, Mass. U.S.A. on
27 Apr 1949.

They had one child:

- i. **Diane Jean Cox.** Born on 13 Sep 1946.

Diane Jean Cox married **William Noble.**

114. Garnett Densmore Long (*Harry Sufferin⁵, William "Harris"⁴, William Bennett³, Peter², Jacob Peter Lange¹*).
Born on 14 Oct 1919 in Deep Brook, Anna. Co., N.S. Residence: Allston, Mass.

In Jun 1944 when Garnett Densmore was 24, he married **Jean Gray.** Born in Allston, Mass. U.S.A.

They had the following children:

- i. **Janet Anne.** Born on 18 May 1945.

Janet Anne married **Richard Trembley.**
- ii. **Christine Roberta.** Born on 26 Mar 1952.

On 24 Oct 1975 when Christine Roberta was 23, she married **Gary Weiner.**
- iii. **Glen David.** Born on 14 Jul 1955.

On 9 Oct 1978 when Glen David was 23, he married **Linda LaJoie.**
- iv. **Sharon Lee.**
- v. **Charlotte Jane.**

Charlotte Jane Long married **Bruce Richards.** Born in Sackville, NB.

115. Francis Lorraine Long (*Harry Sufferin⁵, William "Harris"⁴, William Bennett³, Peter², Jacob Peter Lange¹*).
Born on 14 May 1922 in Deep Brook, Anna. Co., N.S.

Francis Lorraine married **Helen Trawinski.**

They had the following children:

- i. **John.** Born in Jul 1949. John died on 26 Feb 1990; he was 40.
- ii. **Valerie.**

Long Family of Annapolis County, NS

Family of Valentine Augustus Long (53) & Ella M. Fraser

116. Etta May Long (*Valentine Augustus⁵, Charles Augustus⁴, William Bennett³, Peter², Jacob Peter Lange¹*). Born on 18 Aug 1894. Etta May died on 26 Jan 1952; she was 57.

In Feb 1928 when Etta May was 33, she married **Maurice Alfred Potter**, son of **Robert Jefferson Potter** (25 Dec 1858-5 Sep 1943) & **Annie Milner Wright** (20 Jan 1866-30 Jun 1948). Born on 31 May 1893. Maurice Alfred died in Halifax N.S., on 4 Oct 1974; he was 81.

They had one child:

i. **Ann Mary**. Born on 10 Oct 1931.

On 2 Mar 1951 when Ann Mary was 19, she married **Peter Harry Brown**. Born on 30 Jan 1929.

117. Mabel Millicent Long (*Valentine Augustus⁵, Charles Augustus⁴, William Bennett³, Peter², Jacob Peter Lange¹*). Born on 24 Jan 1896 in Clementsvale, Annapolis Co., NS.

On 22 Jul 1925 when Mabel Millicent was 29, she married **Joseph Ernest McDormand** in Digby, NS. Born in 1887 in Annapolis, NS. Joseph Ernest died on 17 Sep 1948; he was 61.

They had one child:

i. **Joan Ernestine**. Born on 8 Mar 1927.

On 19 Sep 1947 when Joan Ernestine was 20, she married **John Bateman**. Born on 3 Sep 1925. John died on 4 Oct 1982; he was 57.

Family of George Wallace Long (56) & Daisy Bell Burrell

118. Marie Long (*George Wallace⁵, Charles Augustus⁴, William Bennett³, Peter², Jacob Peter Lange¹*). Born on 12 Mar 1928. Marie died on 12 Aug 2019; she was 91.

Wamboldt, Marie Louise, 91 of Clementsvale passed away August 12, 2019 at home. Born in Clementsvale she was a daughter of the late George and Daisy (Burrell) Long. Marie was a long time member of the Clementsvale Baptist Church and the Friendly Club and attended faithfully. She was a member of the Royal Canadian Legion Auxiliary, Clementsport Branch for over 60 years; was a Red Hatter, and a long time TOPS member. Marie loved to travel and went a crossed Canada, Europe, Spain, Florida and New Hampshire to name a few. She is survived by her sons: David (Norma) of Clementsvale, Tim (Stephanie) of Lower Sackville; daughter Nancy (Bill) Hilden of Bear River; grandchildren: Hal and family, Arthur and boys, Lucas and family, Logan, Naomi, and Dillion; 8 great grandchildren; nephew John McKim and family and cousin Jean Beckwith and family. Marie was predeceased by her husband Mason, a daughter in infancy, sister Millicent and brother Charlie.

On 6 Sep 1950 when Marie was 22, she married **Mason Lawrence Wamboldt**. Born on 9 Feb 1919.

Son of J. Albert Wamboldt and Leota (Trimper) Wamboldt.

They had the following children:

Long Family of Annapolis County, NS

i. **Nancy Eliza.** Born on 12 Mar 1951.

On 28 Jun 1975 when Nancy Eliza was 24, she married **William Harold Hilden.**

ii. **David Mason.**

iii. **Timothy John.**

Family of Ralph Watson Long (59) & Zeddie Viola Wright

119. Lindsay Eugene Long (*Ralph Watson⁵, Thomas Roby⁴, William Bennett³, Peter², Jacob Peter Lange¹*). Born on 23 Jan 1914 in Power Lot. Lindsay Eugene died in Pictou, N.S., on 23 Nov 1963; he was 49. Buried in Seaview Cemetery, Pictou.

Lindsay Eugene married **Hilda Pyne Robar.** Born in 1920 in Virginia East, Anna. Co., N.S. Hilda Pyne died in Pictou, NS, on 23 Dec 1993; she was 73.

They had the following children:

i. **Garry.**

ii. **Tessa.**

Tessa married **Robert Love.**

120. Corey Milton Long (*Ralph Watson⁵, Thomas Roby⁴, William Bennett³, Peter², Jacob Peter Lange¹*). Born on 21 Jan 1917 in Clementsport, NS. Corey Milton died in Kentville N.S., on 19 Feb 1988; he was 71.

Corey Milton married **Dorothy Dukeshire.** Born in 1921. Dorothy died on 5 Sep 2009; she was 88. Buried in Lakeview Cemetery, Lakeville, Kings Co.

Dorothy Mae Sanford – 88, of Kentville, passed away Saturday, September 5, 2009 at home. Born in Round Hill, Annapolis County, she was a daughter of the late Israel and Mildred (Greenslade) Dukeshire. In her earlier years, she owned and operated a restaurant in Clementsport. More recently, she boarded students from the Nova Scotia Community College – Kingstec Campus, Kentville, for whom she enjoyed baking and cooking. She is survived by her husband, Calvin; two daughters, Dianne Holmes, Kentville and Tami (Terry Dalton), Timberlea; a sister, Mildred Burrell, Clementsport; five grandchildren and two great grandchildren. She was predeceased by her first husband, Corey Long; two sons, James Long and Rodney Long; two brothers, Ernest Dukeshire and Aiden Dukeshire.

They had the following children:

185 i. **Diana J.** (1942-)

ii. **Jimmy Derrel** (Died as Child). Born on 24 Oct 1946. Jimmy Derrel died on 14 Feb 1949; he was 2.

iii. **Rodney Corey.** Born in 1949. Rodney Corey died in Jul 1971; he was 22.

Rodney Corey married **Sandra Marilyn Drake.**

186 iv. **Tami Elizabeth**

121. Thane V. Long (*Ralph Watson⁵, Thomas Roby⁴, William Bennett³, Peter², Jacob Peter Lange¹*). Born in 1924. Thane V. died in Lawrencetown, NS, on 17 Jan 2018; he was 94.

We are saddened to announce the passing of our father in his 93rd year on January 17, 2018, in Lawrencetown with

Long Family of Annapolis County, NS

his family by his side. Born in Powerlot, he was the son of the late Ralph and Zeddie (Wright) Long. Thane was the last surviving sibling of his family. A beloved husband, father, grand-father and great grand-father, Thane was a very loving, kind, and gentle soul. He was a member and trustee of the Clementsvale United Baptist Church and also sang in the choir. Thane was a 48 year continuous service member of Branch 122 Clementsport Royal Canadian Legion where he enjoyed playing pool and cards. At the age of 19 he enlisted in the Canadian Army where he served overseas during WWII. Thane worked as a carpenter at CFB Cornwallis for 28 years where he retired at the young age of 65. He always enjoyed working in his garden and cutting up his firewood. Dad was loved by so many and will be sadly missed by everyone. Thane is survived by son, Joey Long (Darlene) Lawrencetown; daughters Janice Deveau (Gary) Clementsport and Teresa Long Lawrencetown; grandchildren, Michael, Lisa, Brian and Joey; great-grandchildren, Juliette, Lola, Arlo and Rayna. He was predeceased by his wife, Marion; sisters, Ethel Dean, Verna Payne; brothers, Glenford Long, Wiley Long, Lindsay Long, Clyde Long, Corey Long and Elmore Long.

On 27 Jun 1954 when Thane V. was 30, he married **Marion Esther Dukeshire**. Born in 1929. Marion Esther died in Clementsport, Annapolis Co., NS, on 15 Jan 2017; she was 88.

Age 87, of Clementsport. We are saddened to announce her passing on January 15, 2017, in Lawrencetown with her family by her side. Born in Waldec, she was the daughter of the late Odbur and Lena (Ring) Dukeshire. Marion was the last surviving sibling of her family. A beloved wife, mother, grand-mother and great grand-mother, Marion devoted her entire life to her family, especially her daughter Teresa whom she gave the upmost love and care too. She was a member of the Clementsvale United Baptist Church and also the Clementsvale Friendly Club. She enjoyed knitting, sewing, quilting and playing cards. She never missed a family member's birthday, always ensuring each and every one received a gift on time. Mom was loved by so many and will be sadly missed by everyone. Marion is survived by husband, Thane Long; son Joey Long (Darlene) Lawrencetown; daughters Janice Deveau (Gary) Clementsport; and Teresa Long at home; grandchildren, Michael, Lisa, Brian and Joey; great-grandchildren Juliette, Lola and Rayna. She was predeceased by sister, Marjorie Saari; brothers, Roy Dukeshire and Ronald Dukeshire.

They had the following children:

- | | | |
|------------|------|-------------------|
| | i. | Janice. |
| 187 | ii. | Joey Thane |
| | iii. | Teresa. |

Family of Otto Long (64) & Reta Mae Chute

122. Lewis Otto Long (*Otto*⁵, *Jacob Whitman*⁴, *William Bennett*³, *Peter*², *Jacob Peter Lange*¹). Born on 28 Aug 1923. Lewis Otto died on 31 Oct 2011; he was 88. Buried in Clementsvale Cemetery.

CAMBRIDGE / BEAR RIVER EAST. It is with great sadness that the family of the late Lewis Otto Long, age 88, Camro Place, Cambridge, Kings County and formerly of Bear River East, Annapolis County announce his passing in Valley Regional Hospital, Kentville, NS on Monday, October 31, 2011. Dad passed away peacefully surrounded by his loving family. Born in Bear River, he was the son of the late Otto and Reta (Chute) Long. For nearly 30 years, Dad was a butcher and meat peddler in Annapolis and Digby Counties making many lifelong friends. Following his years of being the "meat man", he worked at Upper Clements Wildlife Park. Dad loved the outdoors and had a passion for hunting, fishing, canoeing and enjoying time with his family whom he cherished. He will be lovingly remembered and sadly missed by his second wife Ruth (Tompkins) Wilkinson, two sons, Roger (Ann) of Coldbrook, Rodney (Gaynell) of Amherst, and daughter, Myrna (Jay) Verge of Cambridge, his sister, Hilda (Esmond Jr.) Whynott of Lower Branch, Queens County. He was a special grandfather to Christa (Scott) MacDonald, Scott (Cheryl) Long, Rose (Chad) Clarke, Peter (Amy) Long, Graham (Jackie) Long, Cara Dawn (Corey) Pierce, Allison (Evan) Collins, Denise and Tracey Verge as well as 11 special great grandchildren and 2

Long Family of Annapolis County, NS

nieces. Dad is also survived by three step children, Joan (Howard) Pratt of Woodstock, NB; Connie (Keith) Ford of Winsloe North, PEI and Randy (Cathy) Wilkinson of Woodstock. Besides his parents, he was predeceased by his first wife of 50 years, Viola (Trimper) Long.

In 1946 when Lewis Otto was 22, he married **Viola Trimper**. Born in 1923. Viola died in 1996; she was 73.

They had the following children:

- | | | |
|------------|------|-----------------------------|
| 188 | i. | Roger Lewis (1947-) |
| 189 | ii. | Rodney Leigh (1953-) |
| | iii. | Myrna Ann Atricia . |

Myrna Ann Atricia Long married **Jay Howard Verge**. Residence: New Glasgow, NS.

123. Hilda Marie Long (*Otto*⁵, *Jacob Whitman*⁴, *William Bennett*³, *Peter*², *Jacob Peter Lange*¹). Born on 6 Jul 1932.

Hilda Marie married **Esmond (Jr.) Whynott**. Residence: Bridgewater, NS.

They had the following children:

- | | | |
|--|-----|------------------|
| | i. | Colleen . |
| | ii. | Glenda . |

Glenda married **Murray St. Clair MacKenzie**.

Family of James "Parker" Long (66) & Frances Marion Gesner

124. Reginald Nelson Long (*James "Parker"*⁵, *Corey O'Dell*⁴, *William Bennett*³, *Peter*², *Jacob Peter Lange*¹). Born on 4 Apr 1930. Reginald Nelson died on 21 Mar 2018; he was 87.

Long, Reginald Nelson – 87, Bear River East, Annapolis County, passed away March 21, 2018, in the Annapolis Community Health Centre, Annapolis Royal. Born in Clementsvale, he was a son of the late Parker and Frances (Gesner) Long. Reginald was a carpenter at Cornwallis base and constructed parts of the Digby General and Annapolis Royal, Hospitals. He enjoyed working in the woods, and on his farm, and loved taking care of his sheep. Reginald battle with cancer lasted 30 years. He is survived by his son, Brian (Julie), Airdrie, AB; Richard (Debbie), Rimbey, AB; Paul (Joyce), Vernon, BC; daughter, Susan (Mark), Clementsvale; brother, Raymond, Phoenix, Arizona; grandchildren, Christopher (Alicia), Maeeka, Jason, Melissa, Ashley, Raymond, Johnathan, Ashley and Devon; great grandchildren, Liam, Kamryn, Brooklyn, Mason and Cailiegh, two nieces. Other than his parents, he was predeceased by wife, Marjorie (Pine) and a daughter in infancy, Patty Lou; brother, Gerald.

Reginald Nelson married **Marjorie Pyne**. Born on 6 Dec 1933. Marjorie died on 28 Jul 2008; she was 74.

They had the following children:

- | | | |
|------------|------|---|
| | i. | Brian Nelson . |
| | ii. | Richard James . |
| 190 | iii. | Paul Anthony |
| | iv. | Patricia Louise (Died as Child). Patricia Louise died in 1962. |
| | v. | Susan . |

125. Gerald Parker Long (*James "Parker"*⁵, *Corey O'Dell*⁴, *William Bennett*³, *Peter*², *Jacob Peter Lange*¹). Born on 15 Nov 1931. Gerald Parker died on 24 Apr 2017; he was 85.

Long Family of Annapolis County, NS

Long, Gerald "Bibs" Parker – 85, of Clementsvale, passed away after a short illness April 24, 2017, in the Annapolis Community Health Center. Born November 15, 1931, in Clementsvale, he was the son of the late Parker and Francis (Gesner) Long. Bibs had a 25 year military career, which lead him many places. Upon his retirement, he came back to his home in Clementsvale, to begin farming. Bibs enjoyed working in the fields, bailing hay and thrashing oats. He also loved the woods, cutting for firewood or lumber and planting trees to replenish the forest. He built his own little sawmill and for many years ran it for himself or any neighbor that needed a board cut. He was an avid supporter for Clementsport Legion Branch #122, often playing pool, cribbage and bridge. He will be forever remembered sitting under the maple tree enjoying a home brew. He is survived by his daughters, Mary Catherine (Brian) Cook, of Petawawa, and Faye Bell of Clementsvale; grandchildren, Jay Barron, Candice Barron, David Cook, Natasha Bell, and Amberley Cleland; 13 great grandchildren; two great great grandchildren; brothers, Reginald of Bear River, and Raymond of Phoenix, Arizona. He was predeceased by his first wife, Betty (Davidson) Long; his second wife, Rose (Vanvleek) Long; son in-law, Dick Bell.

Gerald Parker married **Betty Davidson**.

They had the following children:

i. **Mary.**

Mary married **Neil Barron**.

ii. **Faye.**

Faye married **Richard Bell**.

Family of George Edward Long (68) & Mabel Milbury

126. Lester Durant Long (*George Edward⁵, Henry "Fletcher"⁴, William Bennett³, Peter², Jacob Peter Lange¹*). Born on 2 Jul 1905 in Clementsvale, Annapolis Co., NS. Lester Durant died on 25 Feb 1976; he was 70.

On 7 Apr 1926 when Lester Durant was 20, he married **Aileen Blanche Dunn** in Clementsvale, Annapolis Co., NS. Born on 24 Jun 1907. Aileen Blanche died in Annapolis Royal, NS, on 21 Apr 1965; she was 57.

They had the following children:

i. **Edward Lee.** Born on 18 Jan 1937. Edward Lee died on 26 Jan 2002; he was 65. Buried in Clementsvale Cemetery.

Edward Lee married **Gloria Ann Wilson**. Born on 20 May 1941. Gloria Ann died on 2 Jul 2006; she was 65.

ii. **Mabel.**

Mabel married **Maynard Wagner**.

127. Willard Wallace Long (*George Edward⁵, Henry "Fletcher"⁴, William Bennett³, Peter², Jacob Peter Lange¹*). Born on 10 Feb 1920.

Willard Wallace married **Edith Beulah Guest**. Born on 22 May 1922 in Williamsdale, Cumb. Co., NS.

They had the following children:

i. **Diane Louise.** Born on 18 Jun 1951.

Long Family of Annapolis County, NS

- ii. Diane Louise married **Robert Charles Hardwick**.
Deborah Doreen. Born on 22 Mar 1953.
- iii. On 4 May 1974 when Deborah Doreen was 21, she married **Rockey Hebb**.
Kevin Willard.
Kevin Willard Long married **Catherine Bromley**.

Family of Beatrice Martha Long (69) & William Howard Potter

128. Russell Devernott Potter (*Beatrice Martha Long*⁵, *Henry "Fletcher"*⁴, *William Bennett*³, *Peter*², *Jacob Peter Lange*¹). Born on 23 Sep 1908 in Bear River East, N.S. Russell Devernott died in Clementsvale, Annapolis Co., NS, on 29 Oct 1985; he was 77.

On 1 Jun 1940 when Russell Devernott was 31, he married **Gertrude Rebecca Zwicker** in Clementsport, NS. Born on 18 Aug 1914 in Glenmore, Musquodoboit, NS. Gertrude Rebecca died in Digby, NS, on 27 Apr 2007; she was 92.

They had the following children:

- i. **Marguerite Dolene**. Born on 28 Dec 1942.
Surname Watters
- ii. On 5 Dec 1964 when Marguerite Dolene was 21, she married **Albert C. Hartling**.
191 Barbara Beatrice (12 Jan 1950-)

129. Murray Eldon Potter (*Beatrice Martha Long*⁵, *Henry "Fletcher"*⁴, *William Bennett*³, *Peter*², *Jacob Peter Lange*¹). Born on 11 Jul 1915 in Bear River East, N.S. Murray Eldon died in Digby, NS, on 10 May 1989; he was 73.

On 27 Sep 1942 when Murray Eldon was 27, he married **Carrie Anna Zwicker**. Born on 29 Dec 1916 in Glenmore, Musquodoboit, NS. Carrie Anna died in Annapolis Royal, NS, on 3 Apr 1999; she was 82.

They had one child:

- 192** i. **Allister Ira**

130. Gladys Mae Potter (*Beatrice Martha Long*⁵, *Henry "Fletcher"*⁴, *William Bennett*³, *Peter*², *Jacob Peter Lange*¹). Born on 1 Apr 1917 in Clementsvale, Annapolis Co., NS. Gladys Mae died in Yarmouth, N.S., on 24 Jun 1994; she was 77.

On 27 Oct 1937 when Gladys Mae was 20, she first married **Atlee Leroy Buckler**.

They had the following children:

- 193** i. **Kathryn Mae** (4 May 1938-)
- 194** ii. **Carroll Stanley** (20 Dec 1940-)
- 195** iii. **Victor Gerald** (7 Mar 1945-)
- 196** iv. **Geraldine Evone** (4 May 1947-)

Long Family of Annapolis County, NS

Gladys Mae second married **Burt Podwinski**. Burt died bef 1994.

131. Frances Lillian Potter (*Beatrice Martha Long⁵, Henry "Fletcher"⁴, William Bennett³, Peter², Jacob Peter Lange¹*). Born on 12 Dec 1919.

On 28 Aug 1937 when Frances Lillian was 17, she married **Leander Arthur Fritz**.

They had the following children:

- i. **Joan Irene**. Born on 4 Dec 1939.
- ii. **Norman Leander**. Born on 4 Feb 1942.
- iii. **David Willie**. Born on 27 Sep 1946.
- iv. **Harold Arthur**. Born on 9 Dec 1952.
- v. **Thomas Morgan**.

132. Flora Annie Potter (*Beatrice Martha Long⁵, Henry "Fletcher"⁴, William Bennett³, Peter², Jacob Peter Lange¹*). Born on 18 Mar 1922 in Bear River East, N.S. Flora Annie died in Bridgetown, Annap. Co., NS, on 26 Jan 2001; she was 78.

On 4 Jun 1942 when Flora Annie was 20, she married **Raymond LeRoy Elmore**.

They had the following children:

- i. **Richard LeRoy**. Born on 6 Sep 1942.
- ii. **Shirley Ann**. Born on 22 Sep 1953.
- iii. **Rodney Eugene**. Born on 14 Jun 1955.

133. Betty Levone Potter (*Beatrice Martha Long⁵, Henry "Fletcher"⁴, William Bennett³, Peter², Jacob Peter Lange¹*). Born on 17 Apr 1928.

On 23 Aug 1949 when Betty Levone was 21, she married **Harold Leslie Burrell**. Born on 22 Dec 1917.

They had the following children:

- i. **Pauline Joyce**. Born on 15 Jun 1950.
- ii. **George Howard**. Born on 16 May 1951.
- iii. **Nancy Marie**. Born on 23 Feb 1953.

- iv. On 2 Sep 1978 when Nancy Marie was 25, she married **James L. E. Arsenault**.
Peter Harold.

Family of Miriam Ann Trimper (82) & Harley Oberlyn Potter

134. Loran Dalton Potter (*Miriam Ann Trimper⁵, John Edward⁴, Lydia Jane Long³, Peter², Jacob Peter Lange¹*). Born on 5 Feb 1912 in Virginia, Anna. Co., N.S. Loran Dalton died in Clementsvale, Annapolis Co., NS, on 10 Apr 1971; he was 59.

Son of Harley Potter and Myriam Trimper.

On 20 May 1938 when Loran Dalton was 26, he married **Mildred Gertrude Wright**, daughter of **John Everett Wright** (15 Feb 1888-1967) & **Florence Mary Brown** (6 Mar 1890-15 Nov 1979), in Clementsvale, Annapolis Co.,

Long Family of Annapolis County, NS

NS. Born on 5 Aug 1920 in Princesdale, Annapolis Co. Mildred Gertrude died in Bear River, Digby Co., NS, on 20 May 2002; she was 81.

Daughters Gertrude Miriam (Mrs. Robert Benson), Bear River; Margaret Ann (Mrs. Ronald Cooper), Digby; sons Harley and his wife Fay, Bear River; Phillip, Bear River; Harry and his wife Tanya, Ross and his wife Susan, both of Wainwright, AB. (2002).

They had the following children:

- i. **Ross.**
- ii. **Harry.**
- iii. **Gertrude.**

Family of George Wickup Trimper (83) & Emma Jeanetta Earley

135. Huldah Pauline Trimper (*George Wickup⁵, Thomas Henry⁴, Lydia Jane Long³, Peter², Jacob Peter Lange¹*). Born on 25 Dec 1916. Huldah Pauline died in Aug 2002; she was 85.

SKERRY, Hulda "Pauline" (TRIMPER)[COLDWELL]; 85; Kentville NS; Chron-Herald; 2002-8-17

Huldah Pauline first married **William Caldwell**.

They had one child:

- i. **William Terrance.** Born on 28 Jan 1939.

Huldah Pauline second married **Merle Skerry**.

They had the following children:

- i. **Carol Jane.** Born on 1 Feb 1948.
- ii. **Elizabeth Merle Dorothy.** Born on 13 May 1954.

136. Clinton Allen Trimper (*George Wickup⁵, Thomas Henry⁴, Lydia Jane Long³, Peter², Jacob Peter Lange¹*). Born on 2 Mar 1919 in Clements, Annapolis Co., NS. Clinton Allen died in Digby, NS, on 21 Oct 2007; he was 88. Buried in Clementsvale Baptist Cemetery.

He is survived by daughters, Glenna MacGregor (Dr. Rod MacGregor), Ohio; Judy Trimper, Bear River East; grandchildren, Andrew MacGregor, Florida; Allison Holzapfel (Scott), Ohio; Matthew MacGregor (Sandy), North Carolina; Christopher Trimper and Geoffery Trimper, both of Alberta; great-grandchildren, Ava Grace MacGregor/Bergmann, Florida; Alex Holzapfel, Ohio; sister Marilyn Machum, Saint John, N.B.; many nieces and nephews. He was predeceased by his wife, the former Helen Potter; sister, Pauline Skerry; brothers, Ralph and Dean.

On 4 Jul 1946 when Clinton Allen was 27, he married **Helen Lucille Potter**, daughter of **Ralph Nelson Potter** (23 Oct 1884-24 Jan 1956) & **Esther Maude Simpson** (1891-1994). Born on 5 Mar 1922 in Clementsvale, Annapolis Co., NS. Helen Lucille died in Clementsvale, Annapolis Co., NS, on 17 Mar 2004; she was 82.

d/o Ralph and Esther (Simpson) Potter

They had the following children:

Long Family of Annapolis County, NS

- i. **Glenna Rae.** Born on 20 Apr 1947. Residence: Dayton, Ohio (2004).

Children Andrew, Allison and Matthew (2004).

Glenna Rae married **Dr. Rod H. I. MacGregor.**

- ii. **Judy Ann.** Born on 9 Oct 1953.

Judy Ann married **Gregory Trimper.** Born in Bear River, NS.

137. Ralph Raymond Trimper (*George Wickup⁵, Thomas Henry⁴, Lydia Jane Long³, Peter², Jacob Peter Lange¹*). Born on 24 Jul 1920. Ralph Raymond died on 11 Mar 1967; he was 46.

Deep Brook. Ralph Raymond Trimper, 46, died at his home, Saturday. He was the son of Mrs Emma (Early) Trimper, Wolfville, and the late George W Trimper, Clementsvale. Mr Trimper served in Italy with the West Nova Scotia Regiment during the Second World War. He was employed with the International Nickel Company in Sudbury, Ontario for 17 years. Returning to Nova Scotia 2 years ago he operated a restaurant in Clementsvale for a short time. Mr Trimper moved to Deep Brook last fall and was employed at CFB Cornwallis. He leaves his mother; his wife, the former Marie McAndrews of Hampton; 3 daughters: Lynne, Mrs David Bidderman, Germany; Pamela and Susan at home; 2 sisters: Pauline, Mrs MV Skerry, Wolfville; Marilyn, Mrs LM Machum, Saint John, NB; 2 brothers, Clinton, Clementsvale; Dean, Halifax. Funeral will be Thursday in Clementsvale Baptist Church, Lic. WG Duffett officiating, assisted by Reverend GD Brydon. (Annapolis Spectator, Tuesday, March 14, 1967)

Ralph Raymond married **Marie MacAndrews.**

They had the following children:

- i. **Lynne.**
- ii. **Pamela.**
- iii. **Susan.**

138. Dean Milton Trimper (*George Wickup⁵, Thomas Henry⁴, Lydia Jane Long³, Peter², Jacob Peter Lange¹*). Born on 11 Feb 1928 in Clementsvale, Annapolis Co., NS. Dean Milton died in Halifax N.S., on 19 May 2000; he was 72.

Dean Milton married **Marie Sweeney.** Born on 30 May 1928. Marie died on 14 Sep 2001; she was 73.

They had the following children:

- i. **Deborah Marie.** Born on 30 Jun 1953.
- ii. **Dani Sue.**

139. Marilyn Joyce Trimper (*George Wickup⁵, Thomas Henry⁴, Lydia Jane Long³, Peter², Jacob Peter Lange¹*). Born on 4 Dec 1933.

On 10 Jul 1954 when Marilyn Joyce was 20, she married **Lawrence Merritt Machum** in Wolfville, NS.

MACHUM, LAWRENCE MERRITT QC - August 02, 1929 - March 10, 2005. After a short but fierce struggle with pulmonary fibrosis, Larry died peacefully at the Saint John Regional Hospital on March 10th, 2005. He was a son of the late Donald Wilfred Machum and Mary Gibson (Merritt) Machum. He is survived by his wife, Judith Brannen; by four children: Greg Machum (Ann) of Fredericton, Lauren Cosman (Mike) of Saint John, Geoff Machum of Halifax and Grant Machum (Jane) of Halifax; as well as by three step children: Lisa Alward (John Ball) of Fredericton, Peter Alward of Lethbridge and Gavin Alward (Mary) of Halifax. In addition, he is survived by 13 grandchildren (Melissa, Michael, Emily, David and Heather Machum, Jonathan and Justin Cosman, Andrew and Matthew Machum, Henry, Alexander, Amelia and Mary Machum) and by five step grandchildren (Hilary, Jack and

Long Family of Annapolis County, NS

Peter Ball and Olivia and Emily Alward). His sister, Kathryn Gillespie of Calgary, and brother, Donald (Sandy) Machum of Edmonton, along with five nieces and one nephew also survive. At Larry's request there will be no visitation or funeral service. A family celebration of his life will take place at a later date. His remains have been cremated and his ashes will be scattered, as he wished them to be, over the Bay of Fundy. He loved his wife, his children, his beautiful garden and walking through the Yorkshire Dales.

Judith Kathleen Brannen October 24, 1938, to April 19, 2013. After a brave struggle with colon cancer, Judith died peacefully at the Dr. Everett Chalmers Regional Hospital in Fredericton, New Brunswick, at the age of 74. Blessed with lifelong good humour, Judith spent her early years in Brass Hill, Barrington, Nova Scotia, and attended Dalhousie University (1955-59). She studied law at the University of New Brunswick (1978-81), practicing for ten years with Lutz, Smith, Brannen of Hampton, New Brunswick. She is predeceased by her parents, Wallace and Winnifred Brannen; her brother, Roger Brannen; and her husband, Lawrence M. Machum. She is survived by her sister, Belinda Lefurgey; her first husband, John. W. Alward; and her three children, Lisa Alward (John Ball) of Fredericton, Peter Alward (Jennifer Crane) of Saskatoon, and Gavin Alward (Mary) of Halifax. Also by her four step-children, Greg Machum (Ann) of Fredericton, Lauren Cosman (Mike) of Rothesay, Geoff Machum (Kim) of Halifax, and Grant Machum (Jane) of Halifax. In addition, she is survived by her six beloved grandchildren, Hilary, Jack, and Peter Ball, Theo Crane-Alward, and Olivia and Emily Alward. And by her fourteen step-grandchildren, Melissa, Michael, Emily, David, and Heather Machum, Jonathan and Justin Cosman, Andrew, Matthew, and Max Machum, and Henry, Alexander, Amelia, and Mary Machum. She will be much missed by her nieces, Dawn, Melinda, and Julia, and her nephew, John, as well as by her many good friends, including her dear walking companion, Jane Wasson. At Judith's request, there will be no visitation or funeral service. A small family gathering will take place at a later time. Her remains have been cremated, and her ashes will be scattered as she wished. A strong Brannen woman to the end, she will be remembered for her adventurous spirit, her keen interest in people, books, and politics, and the caring attention she gave to everything in life. In lieu of flowers, donations to the Chalmers Hospital Foundation, for either the Gastrointestinal (GI) Lab or the Palliative Care Unit, would be much appreciated.

September 13, 2011

With great sadness, today we advise that **Neil McKelvey, O.C., Q.C., C.D.**, has passed away. One of Stewart McKelvey's founding fathers, his death marks the end of an important chapter in the history of our firm. Neil founded Saint John law firm McKelvey Macaulay Machum in 1955 with Wally Macaulay and Larry Machum. In 1990, the firm merged with Stewart MacKeen & Covert, Scales, Jenkins & McQuaid and Stirling, Ryan to become the regional law firm that is now known as Stewart McKelvey. We will forever be indebted to Neil for his role in creating and building Stewart McKelvey.

They had the following children:

- i. **Lawrence Gregory.**
- ii. **Lauren Emily.**
- iii. **Donal Geoffrey.**
- iv. **George Grant.**

Long Family of Annapolis County, NS

Seventh Generation

Family of Wellington Augustus Brown (99) & Helen Louise Nauss

174. Warren Lenly Brown (*Wellington Augustus⁶, Herman Augustus⁵, Martha Long⁴, Jacob³, Peter², Jacob Peter Lange¹*). Born on 19 Nov 1925.

Warren Lenly married **Marion Stewart**.

They had the following children:

- i. **Edith**
- ii. **Marilyn**

Family of Roy Lorimer Long (101) & Ruth Mahan

175. David Roy Long (*Roy Lorimer⁶, Daniel Howard⁵, William "Harris"⁴, William Bennett³, Peter², Jacob Peter Lange¹*). Born on 18 Jun 1926 in Brighton, MA.

On 25 Oct 1952 when David Roy was 26, he married **Alice Lucy Thompson**. Born on 30 Jan 1926 in Saugus, Mass.

They had the following children:

- i. **Roberta Cindy** (22 Dec 1953-)
- ii. **David Scott**
- iii. **Heather Ann**
- iv. **Glenn Thompson**
- v. **Melanie Ruth**

176. Robert Lee Long (*Roy Lorimer⁶, Daniel Howard⁵, William "Harris"⁴, William Bennett³, Peter², Jacob Peter Lange¹*). Born on 28 Mar 1933. Robert Lee died on 17 May 1988; he was 55. Residence: Allston, Mass.

Robert Lee married **Joan T. Shea**.

They had the following children:

- i. **Robert James**
- ii. **Brian Edward**
- iii. **Kevin Joseph**
- iv. **Tracey Ann**
- v. **Andrea Atricia**
- vi. **Christoher Michael**
- vii. **Jeffrey David**

177. Daniel H. Long (*Roy Lorimer⁶, Daniel Howard⁵, William "Harris"⁴, William Bennett³, Peter², Jacob Peter Lange¹*). Born on 3 Feb 1939. Residence: Falmouth, Mass.

Daniel H. married **Sheila Kelly**. Born in Brookline, Mass.

Long Family of Annapolis County, NS

They had the following children:

- i. **Veronica Lee**
- ii. **Brenda**
- iii. **Sheila-Beth**
- iv. **Joanne**
- v. **Maureen**
- vi. **Kerry**

Family of Walter Purdy Long (102) & Greta Lawson

178. Walter Purdy Long (*Walter Purdy⁶, Daniel Howard⁵, William "Harris"⁴, William Bennett³, Peter², Jacob Peter Lange¹*). Born on 23 Aug 1929 in Everett, MA. Residence: Cambridge, Mass.

On 28 Jul 1956 when Walter Purdy was 26, he married **Barbara Goodwin**. Born in rochester, new hampshire.

They had the following children:

- i. **James Walter**
- ii. **Karen Louise**
- iii. **Susan Sharon**

Family of Rev. Fred Burton Long (103) & Ruth Alicia King

179. Fred Burton Long (*Fred Burton⁶, Fred Chipman⁵, William "Harris"⁴, William Bennett³, Peter², Jacob Peter Lange¹*). Born on 11 Aug 1926 in Brockton, Mass. Fred Burton died on 26 Apr 1990; he was 63. Residence: Dedham, Mass.

Fred Burton married **Rosamond Leona Longley**.

Daughter of Wilfred and Dorothy (Laurillard) Longley of Kentville, NS.

They had the following children:

- i. **Fred Burton** (4 May 1953-)
- ii. **John Douglas** (27 May 1954-)
- iii. **Donald Fletcher** (23 Jan 1955-)
- iv. **Elizabeth Ann**
- v. **Heather Jean**
- vi. **Michael Wilfred**

180. Roberta Harris Long (*Fred Burton⁶, Fred Chipman⁵, William "Harris"⁴, William Bennett³, Peter², Jacob Peter Lange¹*). Born on 27 Jun 1932 in Clinton, Mass.

On 13 Sep 1950 when Roberta Harris was 18, she married **Ray Douglas Potter**, son of **Ezra Dimmock Potter** (1 Feb 1898-May 1981) & **Edith Bernice Rogers** (1900-1992), in Deep Brook, Anna. Co., N.S.

Son of Ezra and Bernice (Rogers) Potter, of Clementsport.

They had the following children:

Long Family of Annapolis County, NS

- i. **Michael Douglas** (2 Apr 1952-)
- ii. **Kevin Donald** (15 Sep 1955-)

Family of Ormond Richard Long (104) & Caroline Mae Comey

181. Arthur Richard Long (*Ormond Richard*⁶, *Fred Chipman*⁵, *William "Harris"*⁴, *William Bennett*³, *Peter*², *Jacob Peter Lange*¹). Born on 28 Dec 1922 in Somerville, Mass.

On 27 Mar 1943 when Arthur Richard was 20, he married **Bertha Nicholson** in Natick, MA.

They had the following children:

- i. **Sandra Joyce** (18 Jul 1947-)
- ii. **Arthur Richard** (19 Mar 1950-)
- iii. **Timothy Allen** (25 Jul 1955-)
- iv. **Dennis Wayne**
- v. **Jeffrey Lawrence**

182. David Chipman Long (*Ormond Richard*⁶, *Fred Chipman*⁵, *William "Harris"*⁴, *William Bennett*³, *Peter*², *Jacob Peter Lange*¹). Born on 10 Feb 1926 in Somerville, Mass. Residence: Wareham, Mass.

On 31 Jan 1948 when David Chipman was 21, he married **Joan Sullen** in Holliston, Mass.

They had the following children:

- i. **Virginia** (6 Apr 1949-)
- ii. **Stephen David** (15 Jun 1950-)
- iii. **David Chipman**
- iv. **Donald Alan** (23 Aug 1954-)
- v. **Peter Ormond**

183. Ormond Richard Long (*Ormond Richard*⁶, *Fred Chipman*⁵, *William "Harris"*⁴, *William Bennett*³, *Peter*², *Jacob Peter Lange*¹). Born on 20 Oct 1928 in Waltham, Mass. Residence: Rochester, New York.

On 23 Oct 1948 when Ormond Richard was 20, he married **Shirley White** in Framingham, Mass.

They had the following children:

- i. **Karen Mae** (11 Feb 1950-)
- ii. **Nancy Jean** (30 Nov 1951-)

184. Charles Comey Long (*Ormond Richard*⁶, *Fred Chipman*⁵, *William "Harris"*⁴, *William Bennett*³, *Peter*², *Jacob Peter Lange*¹). Born on 28 Apr 1940 in Framingham, Mass.

On 20 Jan 1961 when Charles Comey was 20, he married **Susan S. Holbrook** in Holliston, Mass.

They had the following children:

- i. **Matthew Holbrook**
- ii. **Deborah Jean**
- iii. **Kristin**

Long Family of Annapolis County, NS

Family of Corey Milton Long (120) & Dorothy Dukeshire

185. Diana J. Long (*Corey Milton⁶, Ralph Watson⁵, Thomas Roby⁴, William Bennett³, Peter², Jacob Peter Lange¹*).
Born in 1942. Residence: Kentville.

Diana J. married **Harold Holmes**.

They had the following children:

- i. **Christopher P.**
- ii. **Travis T.**

186. Tami Elizabeth Long (*Corey Milton⁶, Ralph Watson⁵, Thomas Roby⁴, William Bennett³, Peter², Jacob Peter Lange¹*).

Tami Elizabeth Long first married **Johannes Arnoldus Klein**.

Tami Elizabeth Long second married **Tony Dalton**.

They had one child:

- i. **Thomas Andrew**

Family of Thane V. Long (121) & Marion Esther Dukeshire

187. Joey Thane Long (*Thane V.⁶, Ralph Watson⁵, Thomas Roby⁴, William Bennett³, Peter², Jacob Peter Lange¹*).

Joey Thane Long married **Karen Marie Lincoln**.

They had the following children:

- i. **Michael**
- ii. **Lisa Marie**

Family of Lewis Otto Long (122) & Viola Trimper

188. Roger Lewis Long (*Lewis Otto⁶, Otto⁵, Jacob Whitman⁴, William Bennett³, Peter², Jacob Peter Lange¹*). Born in 1947.

They lived on the old William Bennett Long homestead in Bear River East, the great great grandfather of Roger. The house was built by D. Emerson Long, son of W. B. Long. It burned April, 1992.

In 1969 when Roger Lewis was 22, he married **Elizabeth Ann Sinclair**. Born in 1949 in Moncton, NB.

They had the following children:

- i. **Christa Eliza**
- ii. **Scott Roger**

Long Family of Annapolis County, NS

189. Rodney Leigh Long (*Lewis Otto⁶, Otto⁵, Jacob Whitman⁴, William Bennett³, Peter², Jacob Peter Lange¹*). Born in 1953 in Digby, NS.

On 4 Aug 1978 when Rodney Leigh was 25, he married **Gaynell Fern Crandlemire**.

They had the following children:

- i. **Rose Ladia**
- ii. **Peter Rodney**
- iii. **Graham Rae**
- iv. **Cara Dawn Gaynell**

Family of Reginald Nelson Long (124) & Marjorie Pyne

190. Paul Anthony Long (*Reginald Nelson⁶, James "Parker"⁵, Corey O'Dell⁴, William Bennett³, Peter², Jacob Peter Lange¹*).

Paul Anthony married **Shelley Rice**.

They had one child:

- i. **Son**

Family of Russell Devernett Potter (128) & Gertrude Rebecca Zwicker

191. Barbara Beatrice Potter (*Russell Devernett⁶, Beatrice Martha Long⁵, Henry "Fletcher"⁴, William Bennett³, Peter², Jacob Peter Lange¹*). Born on 12 Jan 1950 in Clementsvale, Annapolis Co., NS.

On 21 Apr 1972 when Barbara Beatrice was 22, she married **Harry Olsen**. Born on 19 Apr 1943.

They had the following children:

- i. **Eric Alfred Lucien**
- ii. **Russell Harry**
- iii. **Jeffrey Parker**
- iv. **Jerrald Phillip**
- v. **Robin Lyndon Herbert**

Family of Murray Eldon Potter (129) & Carrie Anna Zwicker

192. Allister Ira Potter (*Murray Eldon⁶, Beatrice Martha Long⁵, Henry "Fletcher"⁴, William Bennett³, Peter², Jacob Peter Lange¹*).

Allister Ira Potter married **Roberta Florence Wright**, daughter of **Vernon Harold Wright** (22 Apr 1919-26 Jul 1992) & **Marie Elizabeth Potter** (20 Mar 1923-).

They had the following children:

- i. **Greg William**

Long Family of Annapolis County, NS

- ii. **Geneva Marie** (Died as Infant) (8 Oct 1981-27 Feb 1982)
- iii. **Carrie Marie**

Family of Gladys Mae Potter (130) & Atlee Leroy Buckler

193. Kathryn Mae Buckler (*Gladys Mae Potter⁶, Beatrice Martha Long⁵, Henry "Fletcher"⁴, William Bennett³, Peter², Jacob Peter Lange¹*). Born on 4 May 1938 in Digby, NS.

Kathryn Mae married **Edwin Bruce Vroom**. Born in 1937 in Digby, NS. Edwin Bruce died in Deep Brook, Anna. Co., N.S., on 30 Dec 1990; he was 53.

They had the following children:

- i. **Theresa Mae**
- ii. **Christine Katherine**
- iii. **Marilyn Joyce**

194. Carroll Stanley Buckler (*Gladys Mae Potter⁶, Beatrice Martha Long⁵, Henry "Fletcher"⁴, William Bennett³, Peter², Jacob Peter Lange¹*). Born on 20 Dec 1940.

Carroll Stanley married **Carolyn Cecelia Prime**.

They had the following children:

- i. **Blake Carroll**
- ii. **Cathie Lee**
- iii. **Kimberley**

195. Victor Gerald Buckler (*Gladys Mae Potter⁶, Beatrice Martha Long⁵, Henry "Fletcher"⁴, William Bennett³, Peter², Jacob Peter Lange¹*). Born on 7 Mar 1945.

Victor Gerald married **Marsha Fletcher**.

They had one child:

- i. **Barbara Louise**

196. Geraldine Evone Buckler (*Gladys Mae Potter⁶, Beatrice Martha Long⁵, Henry "Fletcher"⁴, William Bennett³, Peter², Jacob Peter Lange¹*). Born on 4 May 1947.

In 1970 when Geraldine Evone was 22, she married **Austin Howard Morine**.

They had the following children:

- i. **Dawn Della Mae**
- ii. **Howard Austin**

Long Family of Annapolis County, NS

Index

Anderson

Paulette spouse of 223

Bailey

Mabel Alice spouse of 44

Barchard

Gerald parent of spouse of 216

Tammy Lynn spouse of 216

Beeler

Ella Mae spouse of 21

Emma E. spouse of 35

Belanger

Aimee Joy child of 215

Courtney child of 215

Michael Kent spouse of 215

Morgan Lee child of 215

Berry

Cathy child of 161

Charles B. parent of spouse of 142

Margaret spouse of 142

Rebecca Elizabeth (Betsy) spouse of 4

Rebecca Elizabeth (Betsy) parent of spouse of 12

Ronald Leroy spouse of 161

Susan child of 161

Timothy child of 161

Berteaux

Annie Marie child of 100

Iylah Mildred child of 100

William Francis child of 100

William Sebra spouse of 100

Boisvert

Richard spouse of 149

Brocklesby

Barry Russell child of 79

Russell Percy spouse of 79

Brown

Carroll child of 47

Celia child of 99

Edith child of 174

Florence spouse of 39

Florence Mary parent of spouse of 134

George Henry 47

Gilbert child of 47

Henry spouse of 10

Herman Augustus 46

John child of 47

Long Family of Annapolis County, NS

Lucy	child of 47
Marilyn	child of 174
Modena	child of 47
Warren Lenly	174
Wellington Augustus	99
Buckler	
Atlee Leroy	spouse of 130
Barbara Louise	child of 195
Blake Carroll	child of 194
Carroll Stanley	194
Cathie Lee	child of 194
Geraldine Evone	196
Kathryn Mae	193
Kimberley	child of 194
Victor Gerald	195
Burke	
Sandra	spouse of 207
Burr	
Jacqueline	child of 147
Melissa	child of 147
Michael	child of 147
Robert	spouse of 147
Burrell	
Abigail	child of 14
Daisy Bell	spouse of 56
George Howard	child of 133
Harold Leslie	spouse of 133
John	child of 14
Martha "Lavinia"	child of 14
Nancy Marie	child of 133
Pauline Joyce	child of 133
Peter Harold	child of 133
Rebecca	spouse of 13
Stillman	child of 14
William H.	spouse of 14
Burton	
James	child of 150
James	spouse of 89
James J.	150
Lisa	child of 150
Caldwell	
William	spouse of 135
William Terrance	child of 135
Canning	
Janice	spouse of 208
Casey	
Austin Davis	166
Brian David	213
David Corey	child of 213

Long Family of Annapolis County, NS

Dennis Austin	child of 166
Florence Sharon	210
Frances Hazel	165
Gordon Davis	spouse of 96
Gordon Ernest	211
Heather Lynn	212
James	parent of spouse of 96
James "Russell"	164
Jeannie Delores	child of 166
Maurice Clifford	167
Michael Graham	208
Patricia Ruth	child of 166
Phyllis Bernice	168
Ross James	207
Scott Alexander	child of 207
Sean David	child of 211
Shelley Lynn	child of 213
Stephen Michael	child of 211
Susan	child of 208

Chute

Ida May	spouse of 45
Martha Loretta	parent of spouse of 46
Mary	parent of spouse of 4
Mary Jeanette	parent of spouse of 59
Reta Mae	spouse of 64
Winnifred Prudence	spouse of 93

Clarke

Camden Lewis Edward	child of 222
Kadain Elizabeth	child of 222
Payton Lynne	child of 222
Ravel Leigh	child of 222
Robert Alan Edward	spouse of 222
Rori Ida Mae	child of 222
Taya Jane Dawn	child of 222

Cole

Gary Evans	child of 78
Hervey L.	spouse of 78
Sandra Ann	child of 78

Comey

Caroline Mae	spouse of 104
--------------	---------------

Connell

Joyce	child of 160
Lawrence	child of 160
Leland	spouse of 160
Randall	child of 160
Ronald	child of 160

Connors

Dorothy "Joan"	spouse of 164
----------------	---------------

Cook

Long Family of Annapolis County, NS

Caroline (Caddie) May	child of 28
Eva Dean	child of 33
George N.	spouse of 28
Joseph Henry	spouse of 33
Loran LeCain	child of 28
Otis C.	child of 33
Coombs	
Esther Jennette	spouse of 65
Cote	
Elizabeth Ann	child of 75
George N.	child of 75
George William	spouse of 75
Jacqueline Lois	child of 75
William Emerson	child of 75
Crandlemire	
Gaynell Fern	spouse of 189
Cress	
Naomi Lovely	spouse of 140
Cromack	
Ann Susan	child of 77
Carol Lorraine	child of 77
Mark	child of 77
Rosemary	child of 77
Ward	spouse of 77
Ward David "Peter"	child of 77
Cumming	
Marie	spouse of 171
Currie	
Gordon	child of 157
Robert	spouse of 157
Robert	child of 157
Ronald	child of 157
Curtis	
Mabel Vaughn	spouse of 41
Dalton	
Thomas Andrew	child of 186
Tony	spouse of 186
Darling	
Florence	spouse of 31
Davidson	
Allison	spouse of 223
Betty	spouse of 125
Davis	
Mark Bennett	child of 107
Ralph Sidney	spouse of 107
Ralph William	child of 107
Debruyne	
Betty	spouse of 204

Long Family of Annapolis County, NS

Deyarmond

Nettie Blanche parent of spouse of 163

Dill

Sarah Maria parent of spouse of 42

Dixon

Ava Grace child of 220
Carter George Foster child of 220
Clarke spouse of 220

Doherty

Mary (May) Theresa spouse of 40

Downe

Mildred Adeline spouse of 86

Duffy

Jo Anne spouse of 214

Dukeshire

Dorothy spouse of 120
Ethel Jenny spouse of 58
Hannah Catherine parent of spouse of 38
Marion Esther spouse of 121

Dunn

Aileen Blanche spouse of 126

Dykes

Bertha Perkins spouse of 74

Earley

Emma Jeanetta spouse of 83

Elmore

Raymond LeRoy spouse of 132
Richard LeRoy child of 132
Rodney Eugene child of 132
Shirley Ann child of 132

Felton

Frederick spouse of 76
Richard Long child of 76
Robert Clifford child of 76

Ferry

Nellie Florence spouse of 26

Finley

Katherine spouse of 63

Fish

Cheryl child of 162
Dale child of 162
Wayne child of 162
William spouse of 162

Fitzpatrick

Elizabeth Jane spouse of 85

Fletcher

Marsha spouse of 195

Ford

Long Family of Annapolis County, NS

David "Robert"	spouse of 202
Jill E.	child of 202
Kelly K.	child of 202
Kyle Patrick Wright	child of 202
Megan	child of 202
Forsythe	
Judith	spouse of 211
Fotino	
Hillary Elizabeth	child of 203
Robert Paul	spouse of 203
Fraser	
Charles	parent of spouse of 98
Della Elizabeth	spouse of 98
Ella M.	spouse of 53
Forrest Parker	spouse of 72
Frances Ann	spouse of 42
George	parent of spouse of 42
Keith	child of 72
Lorge	child of 72
Phyllis	child of 72
Freeman	
Freda Elsie	160
Margaret Priscilla	161
Melzena	162
Robert Delfon	spouse of 94
Sanford Wood	spouse of 28
Fritz	
David Willie	child of 131
Harold Arthur	child of 131
Joan Irene	child of 131
Leander Arthur	spouse of 131
Norman Leander	child of 131
Thomas Morgan	child of 131
Fulton	
Benjamin Arthur	child of 226
Chandler Clark	child of 226
Chase Albert	child of 226
James Albert	spouse of 226
Gesner	
Frances Marion	spouse of 66
Goff	
Allison Grace Lockhart	child of 205
Drew Douglas	child of 206
Everill Murray	163
Harry "Douglas"	206
Helen Martha	child of 95
John Alexander	child of 206
John Roy	spouse of 95
Lindsay Anne Lockhart	child of 205

Long Family of Annapolis County, NS

Murray John	205
William Miles Dickey "MD"	parent of spouse of 95
Gonzales	
Ruth	spouse of 151
Goodwin	
Barbara	spouse of 178
Gower	
Marie	spouse of 144
Gray	
Frances	spouse of 113
George H.	child of 32
James "William"	spouse of 32
Jean	spouse of 114
Grey	
Herman	child of 34
Ira	child of 34
John Ambrose	spouse of 34
Guest	
Edith Beulah	spouse of 127
Hall	
Laura	spouse of 23
Hammond	
Dorothy Helen	spouse of 90
Hayes	
Beverly Arleen	child of 106
Phili Raymond	spouse of 106
Hayward	
Carol	child of 80
Daniel	spouse of 80
Daniel Joseph	child of 80
Elizabeth Mae	child of 80
Jean Louise	child of 80
Thomas Joseph	child of 80
Henshaw	
Ida A.	child of 5
Ruby Ester	child of 5
William	spouse of 5
Heughens	
Barbara Ann	spouse of 169
Ernest Lynds	parent of spouse of 169
Hill	
Ruth Bradford	spouse of 110
Hillier	
Meta	spouse of 167
Hines	
Jane Elizabeth	spouse of 6
Sarah	parent of spouse of 16
Holbrook	

Long Family of Annapolis County, NS

Susan S.	spouse of 184
Holmes	
Christopher P.	child of 185
Harold	spouse of 185
Travis T.	child of 185
Hooper	
Betty	spouse of 154
Horton	
Jennifer	spouse of 219
Huber	
Alexander David	child of 217
Anneka Elizabeth	child of 217
Ralph	spouse of 217
Hubley	
Claudine Joyce	child of 141
Gerald Ross	child of 141
John	spouse of 141
Lena Mae	child of 141
Hutchings	
Calvin Long	child of 55
Ferdinand Calvin	spouse of 55
Gladys	child of 55
Lawrence Andrews	child of 55
Ralph Elmer	child of 55
Johnson	
Kate Blanche	parent of spouse of 97
Jordan	
Evelyn Ada	parent of spouse of 173
Kelly	
Della J.	spouse of 62
John Joseph	spouse of 91
John Joseph Jr.	153
Kerry	child of 153
Michael	child of 153
Nancy	child of 153
Sheila	spouse of 177
Kennedy	
Margaret Elva	spouse of 156
Keyes	
Emily May	spouse of 61
King	
Edna Mae	child of 57
John Alexander	spouse of 57
John Charles	child of 57
Margaret	spouse of 73
Robert Clarence	child of 57
Ruth Alicia	spouse of 103
Klein	

Long Family of Annapolis County, NS

Johannes Arnoldus	spouse of 186
Landry	
Brian	child of 214
Janet Bernice	child of 168
Joseph Bertram	spouse of 168
Matthew	child of 214
Scott Bertram	214
Stephen Joseph	child of 168
Lange	
Jacob Peter	1
Langely	
John Jr.	parent of spouse of 2
Langille	
Donna Darlene	spouse of 172
John Alfred	parent of spouse of 172
Langley	
Acquila	parent of spouse of 4
Martha	spouse of 2
Martha	spouse of 4
Lawson	
Greta	spouse of 102
Lemaire	
Josephine	spouse of 74
Leonard	
Paul	spouse of 148
Suzanne	child of 148
Tracie	child of 148
Lincoln	
Karen Marie	spouse of 187
Lisa	
UNNAMED	spouse of 209
Lockhart	
Leonard Jr.	parent of spouse of 205
Wendy Joan	spouse of 205
Long	
Abbie Louisa	child of 16
Ada	child of 27
Adna George	child of 31
Alden E.	12
Alden E.	spouse of 22
Alice Ellsworth	55
Althea Ann	19
Althea Priscilla	76
Amaret "Jane"	child of 3
Amerilla	child of 9
Andrea Atricia	child of 176
Anna Catherine	child of 3
Annie	child of 9
Annie Amelia	child of 45

Long Family of Annapolis County, NS

Arthur Richard	181
Arthur Richard	child of 181
Avard C.	child of 13
Avis Adeline	child of 25
Barbara C.	child of 63
Beatrice Martha	69
Beatrice Viola	105
Bertha May	child of 45
Bethel May	child of 104
Beulah Elizabeth	8
Beulah Elizabeth	parent of spouse of 37
Brenda	child of 177
Brian Edward	child of 176
Brian Nelson	child of 124
Bruce Clyde	child of 104
Cara Dawn Gaynell	child of 189
Caroline Edith	child of 104
Carrie E.	child of 13
Charles Augustus	16
Charles Chester	child of 56
Charles Comey	184
Charlotte	child of 4
Charlotte Elizabeth	75
Charlotte Jane	child of 114
Christa Eliza	child of 188
Christine Roberta	child of 114
Christoher Michael	child of 176
Clara Marie	child of 16
Clarence Mortimer	child of 45
Clayton Marshall	111
Clyde Maxwell	child of 59
Corey Milton	120
Corey O'Dell	21
Daniel "Emerson"	25
Daniel H.	177
Daniel Howard	48
Darrel Douglas	113
Darrell Waldo Irving	child of 59
David Chipman	182
David Chipman	child of 182
David Emerson	child of 74
David Roy	175
David Scott	child of 175
Deborah Doreen	child of 127
Deborah Jean	child of 184
Dennis Walter Raymond	child of 59
Dennis Wayne	child of 181
Diana J.	185
Diane Jean Cox	child of 113
Diane Louise	child of 127
Donald Alan	child of 182

Long Family of Annapolis County, NS

Donald E.	child of 101
Donald Fletcher	child of 179
Dorothy Maisie	child of 101
Dorothy Myrtle	child of 103
Edna Winifred	107
Edward Lee	child of 126
Effie	33
Eleanor Marie	child of 104
Eliza Jane Perkins	child of 16
Elizabeth	child of 30
Elizabeth Ann	child of 179
Elizabeth Gertrude	child of 111
Elizabeth R.	child of 101
Ella	child of 31
Ella S.	34
Elmer R.	child of 18
Elmore Summerville	child of 59
Ena Louise	child of 45
Ephraim Daniels	6
Estella Maude	80
Ethel Viola	child of 59
Etta May	116
Eugene Arthur	110
Eva May	child of 17
Evelyn Viola	child of 104
Everett	child of 24
Ezekiel Chipman	child of 4
Faye	child of 125
Fletcher	child of 2
Florence	child of 30
Florence	child of 58
Florence Louise	child of 62
Francis Lorraine	115
Rev. Fred Burton	103
Fred Burton	179
Fred Burton	child of 179
Fred Chipman	49
Fred Watson	child of 53
Garnett Densmore	114
Garry	child of 119
George Dexter	child of 2
George E.	child of 68
George Edward	68
George Hines	31
George Wallace	56
George "Warren"	child of 68
Gerald	child of 58
Gerald Parker	125
Gilbert	child of 6
Gilbert	child of 65
Gladys	child of 31

Long Family of Annapolis County, NS

Gladys Lorena	57
Glen David	child of 114
Glenford Roscoe	child of 59
Glenn Thompson	child of 175
Goldie Vivian	70
Goldie Vivian	spouse of 71
Gordon Albert	child of 68
Gordon Marsters	child of 51
Grace Elizabeth	72
Graham Rae	child of 189
Guy Laverne	child of 73
H. Meredith	child of 52
Hannah Maria Faith	child of 3
Harold Hastings	63
Harold Jason	child of 63
Harold Martin	child of 31
Harry Burton	112
Harry Sufferin	52
Hartford Thorold	spouse of 70
Hartford Thorold	71
Heather Ann	child of 175
Heather Jean	child of 179
Helen Marion	79
Henry F.	child of 2
Henry "Fletcher"	23
Henry "Fletcher"	parent of spouse of 71
Hilda Marie	123
Howard Thellwell	58
Howard Wallace	child of 58
Irene Francis	78
Jacob	3
Jacob	parent of spouse of 22
Jacob Allen	child of 3
Jacob Whitman	20
James H.	child of 45
James "Leonard"	62
James "Milledge"	13
James "Parker"	66
James W.	child of 9
James Walter	child of 178
Janet Anne	child of 114
Janette	29
Janice	child of 121
Jasper Veloice	child of 17
Jean I.	child of 63
Jeffrey David	child of 176
Jeffrey Lawrence	child of 181
Jennie Emma	child of 4
Jimmy Derrel	child of 120
Jo-Ann Lucinda	child of 109
Joanne	child of 177

Long Family of Annapolis County, NS

Joanne Frances	child of 112
Joel	child of 2
Joel Daniel	24
Joel Daniel	parent of spouse of 70
Joey Thane	187
John	child of 65
John	child of 115
John Bennett ("Ben")	26
John Clark	child of 26
John Douglas	child of 179
John Henry	9
Joseph "Warren"	child of 4
Joseph Warren	73
Joshua Freeman	30
Judy Ann	child of 111
Karen Louise	child of 178
Karen Mae	child of 183
Kate	child of 6
Katherine	child of 65
Katherine Lois	child of 25
Kathleen	child of 70
Kathleen	child of 71
Kerry	child of 177
Kevin Joseph	child of 176
Kevin Willard	child of 127
Kristin	child of 184
Lawrence Edward	child of 68
Lena Gertrude	child of 20
Leon Marsters	child of 48
Leslie Catherine	child of 110
Lester Durant	126
Lewis "Mortimer"	45
Lewis Otto	122
Lilly Beatrice	child of 15
Lindsay Eugene	119
Lisa Marie	child of 187
Lottie	child of 12
Lottie	child of 22
Lucinda Bradford	child of 110
Lydia Jane	7
Lydia Jane	parent of spouse of 43
Mabel	child of 126
Mabel Estella	child of 45
Mabel Gertrude	child of 15
Mabel Millicent	117
Mabel Sophronia	106
Margaret Ann	5
Margaret Jane	child of 110
Marie	118
Marion Dorothy	67
Martha	10

Long Family of Annapolis County, NS

Martha B.	spouse of 12
Martha B.	22
Martha B.	child of 11
Martha B.	spouse of 21
Martha Beatrice	child of 52
Mary	child of 125
Mary Amert (Ammie)	54
Mary Lavinia	14
Matthew Holbrook	child of 184
Maureen	child of 177
Melanie Ruth	child of 175
Melinda	28
Melvin "Freeman"	child of 31
Meredith	child of 45
Michael	child of 187
Michael Wilfred	child of 179
Mildred	child of 58
Mildred Freda	100
Milledge C.	child of 21
Millicent Beulah	child of 56
Milton	65
Murray Clayton	child of 111
Myrna Ann Atricia	child of 122
Myrtle Meredith	child of 49
Nancy Jean	child of 183
Nellie F.	child of 26
Norman Alfa	child of 15
Ormond Richard	104
Ormond Richard	183
Oscar Edward	child of 12
Oscar Edward	child of 22
Otto	64
Patricia Ann	child of 112
Patricia Louise	child of 124
Paul Anthony	190
Pearl Elizabeth	child of 17
Pearl Jeanette	77
Peter	2
Peter Ormond	child of 182
Peter Rodney	child of 189
Priestley	17
Ralph Watson	59
Raymond	child of 66
Rebecca Anna	child of 104
Rebecca Lucinda	child of 3
Reginald Clayton	51
Reginald Nelson	124
Richard	child of 65
Richard Emerson	child of 73
Richard James	child of 124
Robert G.	child of 63

Long Family of Annapolis County, NS

Robert James	child of 176
Robert Lee	176
Roberta Cindy	child of 175
Roberta Harris	180
Rodney Corey	child of 120
Rodney Leigh	189
Roger Lewis	188
Rose Ladia	child of 189
Roy Lorimer	101
Ruth Alicia	child of 103
Sadie L.	child of 53
Sandra Joyce	child of 181
Sarah	32
Scott Roger	child of 188
Sharon Lee	child of 114
Sheila-Beth	child of 177
Stephen David	child of 182
Susan	child of 124
Susan L.	child of 45
Susan Sharon	child of 178
Tami Elizabeth	186
Teresa	child of 121
Tessa	child of 119
Thane V.	121
Thomas	child of 18
Thomas Roby	18
Timothy Allen	child of 181
Tracey Ann	child of 176
Valentine Augustus	53
Valerie	child of 115
Vera Eileen	child of 59
Vera May	108
Veronica Lee	child of 177
Virginia	child of 182
Waldo Emerson	74
Wallace Ewart	child of 17
Walter	child of 20
Walter Purdy	102
Walter Purdy	178
Wesley "Manning"	27
Willard Wallace	127
William Bennett	4
William Bennett	parent of spouse of 12
William Bennett	50
William Dennison	11
William Dennison	parent of spouse of 21
William Erington	child of 45
William "Harris"	15
William Lovett	109
Winola	child of 58
Wylie Gordon	child of 59

Long Family of Annapolis County, NS

Zuriah Elizabeth	child of 3
Longley	
Rosamond Leona	spouse of 179
Lovell	
Mabel C.	spouse of 85
Lutz	
Ella	spouse of 81
Lynch	
Nettie May	parent of spouse of 172
MacAndrews	
Marie	spouse of 137
MacDonald	
Jodeine	spouse of 219
Machum	
Donal Geoffrey	child of 139
George Grant	child of 139
Lauren Emily	child of 139
Lawrence Gregory	child of 139
Lawrence Merritt	spouse of 139
Maclean	
Gavin Charles	child of 170
Jaiden	child of 225
Jeffery	spouse of 225
Karleigh Della	child of 225
Logan Angus Benson	child of 225
Maria Jane	child of 170
Nicholas Scott	child of 170
Russel Robert	spouse of 170
MacLeod	
Margaret Edith	parent of spouse of 171
MacQuarrie	
Marilyn	spouse of 197
Mahan	
Ruth	spouse of 101
Mailing	
Sadie Lee	spouse of 68
Matheson	
Florence Bell	parent of spouse of 169
McCarthy	
Karen Ann	203
Paul Martin	spouse of 152
McDormand	
Joan Ernestine	child of 117
Joseph Ernest	spouse of 117
McDougall	
Martha Jane	parent of spouse of 95
McKenzie	
Lewis John Robbie	child of 224

Long Family of Annapolis County, NS

Madilyn Jane Rosie	child of 224
Stephen Edward Percy	spouse of 224
McSwain	
Minnie	spouse of 27
Metts	
Harold Henry	spouse of 105
June Amelia Mary	child of 105
Reederick Harold	child of 105
Meuse	
Elizabeth Ann	spouse of 25
Michie	
Ann Lamb	spouse of 109
Milbury	
Fletcher	parent of spouse of 15
Geneva Ethel	spouse of 144
Jane "Jennie"	spouse of 18
Mabel	spouse of 68
Mary L.	spouse of 17
Saphronia Ann	spouse of 15
Miller	
Ida Beatrice	parent of spouse of 98
Milner	
Elche	parent of spouse of 3
Elche	parent of spouse of 7
Hannah (Anna)	parent of spouse of 8
Joshua	parent of spouse of 16
Maria Melissa	spouse of 16
Melvina	parent of spouse of 24
Morgan	
Frances Amelia	spouse of 49
Morine	
Austin Howard	spouse of 196
Dawn Della Mae	child of 196
Howard Austin	child of 196
Morse	
Avis Adeline	child of 76
Frederick Arthur	child of 76
Frederick Irving	spouse of 76
Murdock	
Arthur Frederick	parent of spouse of 173
Lorraine Carol	spouse of 173
Nauss	
Helen Louise	spouse of 99
Nicholson	
Bertha	spouse of 181
O'Brien	
Ian Davis	209
James "Hubert"	spouse of 165

Long Family of Annapolis County, NS

Kathleen Jean	child of 165
Patrick	child of 209
Oickle	
Viola	spouse of 143
Oldenburgh	
Chilson Edward	child of 108
Edward T.	spouse of 108
James Edward	child of 108
Olsen	
Eric Alfred Lucien	child of 191
Harry	spouse of 191
Jeffrey Parker	child of 191
Jerrald Phillip	child of 191
Robin Lyndon Herbert	child of 191
Russell Harry	child of 191
O'Mara	
Gladys Jeanette	spouse of 52
O'Neill	
Josephine T.	spouse of 112
Ord	
Flora Jane	spouse of 23
Orde	
Elizabeth (Brotha)	spouse of 2
Peck	
Adney Willard	child of 29
Arabelle	child of 29
Archibald	child of 29
Charlotte	child of 34
Daisy	child of 34
Enoch	81
Enoch	child of 81
Esther Lindy	child of 34
Freman	child of 29
George	child of 29
Homer	child of 34
Ida May	child of 29
John	spouse of 34
Lillian	child of 29
Lulu	child of 34
Margaret J.	child of 29
Mary	child of 34
Orland Harry	child of 34
Samuel	spouse of 29
Ulysses	child of 29
Vernon	child of 34
Willard	child of 34
Penny	
Christopher Scott	child of 212
Ian Douglas	child of 212

Long Family of Annapolis County, NS

Kevin Clifford	child of 212
Kimberly	child of 212
Terry	spouse of 212
Perkins	
Harriett (Hattie) Louise	spouse of 51
Podwinski	
Burt	spouse of 130
Potter	
Allister Ira	192
Ann Mary	child of 116
Barbara Beatrice	191
Betty Levone	133
Carrie Marie	child of 192
Ezra Dimmock	parent of spouse of 180
Flora Annie	132
Frances Lillian	131
Geneva Marie	child of 192
Gertrude	child of 134
Gladys Mae	130
Greg William	child of 192
Harley Oberlyn	spouse of 82
Harry	child of 134
Helen Lucille	spouse of 136
John Douglas	parent of spouse of 82
Kevin Donald	child of 180
Loran Dalton	134
Marguerite Dolene	child of 128
Marie Elizabeth	parent of spouse of 192
Maurice Alfred	spouse of 116
Michael Douglas	child of 180
Murray Eldon	129
Ralph Nelson	parent of spouse of 136
Ray Douglas	spouse of 180
Rebecca	parent of spouse of 19
Robert Jefferson	parent of spouse of 69
Robert Jefferson	parent of spouse of 116
Ross	child of 134
Russell Devernett	128
Sabra Ann	parent of spouse of 82
Trueman Oscar	child of 69
William Howard	spouse of 69
Powers	
Jonathan Wright	child of 146
Kathy	child of 146
Mr.	spouse of 146
Timothy	child of 146
Prime	
Carolyn Cecelia	spouse of 194
Pyne	
Marjorie	spouse of 124

Long Family of Annapolis County, NS

Ramsay

Charles William child of 54
Margaret J. spouse of 36
Marion Lee child of 54
William L. spouse of 54

Regimbal

Lise Marie Louise Madeline parent of spouse of 206

Rice

Shelley spouse of 190

Ritchie

Izetta J. spouse of 20

Robar

Hilda Pyne spouse of 119

Rogers

Edith Bernice parent of spouse of 180

Rondeau

Leah spouse of 218

Roxanna

UNNAMED spouse of 30

Sabean

Lucinda Arbuthnot spouse of 50

Sanford

Clarence Higgins 61
Clifford James spouse of 67
Clifford Otis child of 67
Doris Althea child of 60
Herman Incas child of 19
Hobart Albertus 60
Isabel child of 19
James Hobart child of 60
Jane Sophronia spouse of 17
Mabel B. child of 19
Norma Isabel child of 60
Richard Ainsley child of 61
Richard Harding parent of spouse of 19
Ruth Waterman child of 60
Thomas Ansley spouse of 19

Sangster

Edith Marsha spouse of 171
Marshall parent of spouse of 171

Saulnier

Christine spouse of 198

Scheffer

Lillian Frances spouse of 23
Lillian Frances parent of spouse of 71

Scott

Mabel parent of spouse of 96

Secord

Long Family of Annapolis County, NS

Catherine "Michelle" Lloyd Douglas	spouse of 206 parent of spouse of 206
Selig Gertrude	spouse of 111
Shea Joan T.	spouse of 176
Shute Gary Katherine Sharon Robert	child of 210 child of 210 spouse of 210
Simmons Rachel Ann Rachel Ann	spouse of 3 parent of spouse of 22
Simpson Esther Maude	parent of spouse of 136
Sinclair Elizabeth Ann	spouse of 188
Skerry Carol Jane Elizabeth Merle Dorothy Merle	child of 135 child of 135 spouse of 135
Smith Barbara Ann Beverley Clifford Colleen Diane Douglas Jim Larry Leo Jeremiah Xarver Leo Xavier Margaret (Peggy) Pat	child of 87 child of 145 child of 159 child of 159 child of 159 child of 159 child of 159 spouse of 159 spouse of 87 145 parent of spouse of 205 child of 159
Son UNNAMED	child of 190
Sproul Lydia A.	spouse of 46
Sproule Bertha Selina Bessie Eva Beulah Waldon Caroline Amelia George Edward Sarah Jane Sarah Jane Sarah Jane	spouse of 38 spouse of 84 spouse of 144 spouse of 9 parent of spouse of 38 spouse of 11 parent of spouse of 15 parent of spouse of 21
St. George Jean	spouse of 199

Long Family of Annapolis County, NS

Stewart

Marion spouse of 174
Sandra Lynn spouse of 172

Stoten

Hazel Erin child of 221
Sawyer Michael child of 221
Trevor spouse of 221

Sullen

Joan spouse of 182

Swan

Annie Lucinda spouse of 97
John David parent of spouse of 97

Sweeney

Marie spouse of 138

Therens

Grant Douglas child of 155
Henry spouse of 155

Thompson

Alice Lucy spouse of 175

Tingley

Jean spouse of 158

Toner

Valerie spouse of 213

Trawinski

Helen spouse of 115

Trimper

Alice Martha child of 35
Anne M. spouse of 3
Catherine child of 36
Charles Wallace child of 7
Clinton Allen 136
Dani Sue child of 138
David Ernest child of 35
Dean Milton 138
Deborah Marie child of 138
Edith child of 35
Elena child of 37
Elena child of 43
George "Fletcher" child of 7
George Wickup 83
Glenna Rae child of 136
Hallett Ray 36
Harland Clark child of 35
Huldah child of 37
Huldah child of 43
Huldah Pauline 135
Ivan Carroll child of 35
John child of 35
John Conrad parent of spouse of 3

Long Family of Annapolis County, NS

John Conrad	parent of spouse of 7
John Edward	35
John Henry	spouse of 7
John Henry	parent of spouse of 43
Judy Ann	child of 136
Lee Mary	child of 36
Leota Gladys	child of 35
Lydia	child of 36
Lynne	child of 137
Marilyn Joyce	139
Miriam Ann	82
Myrtle Ulanda	child of 35
Pamela	child of 137
Ralph Raymond	137
Robert Leroy	child of 83
Susan	child of 137
Thomas Henry	37
Thomas Henry	spouse of 43
Viola	spouse of 122
Turner	
Sharon	spouse of 200
Vaughn	
Madeline Rosalie	spouse of 166
Vienneau	
Derek	child of 201
Jacques	spouse of 201
Tanya Renee Lynn	child of 201
Vroom	
Christine Katherine	child of 193
Edwin Bruce	spouse of 193
Marilyn Joyce	child of 193
Theresa Mae	child of 193
Wallace	
Ella	spouse of 17
Wamboldt	
David Mason	child of 118
Mason Lawrence	spouse of 118
Nancy Eliza	child of 118
Timothy John	child of 118
Waterman	
Mary B.	spouse of 60
Watt	
Eva I.	parent of spouse of 142
Weiland	
Jacob	parent of spouse of 24
Weilant	
Margaret	spouse of 24
Margaret	parent of spouse of 70
Whidden	

Long Family of Annapolis County, NS

Doris Jean	spouse of 163
Harry Eldridge	parent of spouse of 163
White	
Fannie Elizabeth	spouse of 48
Shirley	spouse of 183
Whynott	
Colleen	child of 123
Esmond (Jr.)	spouse of 123
Glenda	child of 123
Wilson	
Bertha	spouse of 140
Winchester	
Beulah	parent of spouse of 2
Witham	
Elizabeth	child of 92
Frederick Saunders	spouse of 92
Wright	
Deacon Aaron	parent of spouse of 59
Alberta Maude	child of 41
Allison Chipman	156
Amanda Leanne	226
Amy	child of 38
Amy May	222
Annie Milner	parent of spouse of 69
Annie Milner	parent of spouse of 116
Ashley Ren'e	child of 218
Barbara	child of 158
Barbara Jean	child of 86
Benson Oliver	173
Bessie Olivia	spouse of 46
Beulah Jane	child of 98
Beverly	child of 154
Brenda	child of 143
Brian Eugene	child of 144
Bryan Allison	child of 204
Burton St. Clair	child of 44
Carl "Devon"	219
Catherine Harriet	child of 85
Charles	child of 86
Charles Elkaneh	39
Charles H.	child of 85
Charles Howard	88
Christine	149
Christine Jacqueline	child of 197
Clarence "Alden"	158
Clarence Bertram	44
Clarence Edgar	90
Clayton Bailey	child of 44
Corey Fletcher	140
Cynthia Ann	215

Long Family of Annapolis County, NS

Daniel Kevin	child of 199
Darrell Chesley	child of 144
David	child of 200
David Harding	169
David Royce	child of 144
Dawn	child of 144
Della "Erin"	221
Dexter William	child of 98
Donald	child of 86
Donald Howard	child of 44
Doris	child of 86
Dorithea (Dorothy) Buler	89
Dorothy Carlton	child of 85
Dorothy Lorraine	147
Dylan James Reid	child of 223
Edna "Bernice" (Sadie)	child of 44
Elena Jane	spouse of 37
Elena Jane	43
Elizabeth Deborah	224
Elizabeth "Mae"	141
Ellen	child of 158
Eva May	child of 39
Flora Elliott	child of 41
Florence Elizabeth	child of 85
Florence "Flossie" B.	91
Florence Jean	96
Frank St. Clair	143
Gary	child of 143
George Davenport	42
George Devonport	171
Georgia Mileah	child of 219
Gerald	child of 140
Geraldine Gladys	155
Gladys Annie	94
Glen	child of 158
Gordon	child of 158
Grace Mabel	child of 39
Harding Lawrence	97
Harold Eugene	144
Hartley Haven	child of 84
Harvey Hammond	151
Harvey Samuel	child of 39
Harvey W.	40
Howard Seymour	child of 42
Rev. Howard St. Clair	child of 8
Jack	child of 140
Jamee Christine Dawn	child of 198
James Edgar	child of 8
James Edward	200
Jean Florence	170
John	child of 86

Long Family of Annapolis County, NS

John	197
John Everett	parent of spouse of 134
Josephine Alexandra	child of 42
Justin Deal Alexander	child of 223
Kashton Laithe	child of 219
Keith	child of 143
Keith "Charles"	223
Keith Francis	98
Kelly Elizabeth	217
Kelsi Elizabeth Davidson	child of 223
Kenneth Lester	child of 44
Kevin Ernest	218
Krista "JoAnne"	220
Laura Chrsitine	child of 156
Leafy Hilda	child of 44
Leander "Alonzo"	38
Leigh Keith	child of 98
Lena Belle	child of 41
Leonard Haven	84
Lewis Charles	172
Lillian Mabel	87
Linda Faye	child of 156
Lisa Dawn	225
Lisa Marie	202
Lloyd Allison	204
Lorne Evander	child of 39
Lorraine (Lorrie) May	152
Mabel Luella	child of 44
Mabel Sanford	159
Malcolm	child of 86
Margaret Anne	child of 156
Margaret Violet	92
Marion Joyce	child of 84
Mark	child of 200
Michael Harold	child of 144
Mildred Gertrude	spouse of 134
Nicholas Steven	child of 216
Palmer W.	child of 44
Patricia Ann	148
Paul Kenneth	child of 85
Peter Elsworth	41
Phillip Francis	child of 44
Phyllis Shaw	child of 44
Reginald Freeman	85
Richard	198
Robert	child of 158
Robert F.	child of 44
Roberta Florence	spouse of 192
Ruth	146
Ruth E.	child of 44
Ruth Elizabeth	child of 85

Long Family of Annapolis County, NS

Sarah "Hazel"	95
Sean Albert	child of 204
Shelley Lynne	child of 204
Shirley Ann	child of 140
Son	child of 97
Stanley Freeman	child of 85
Steven	199
Steven David	216
Sylvia	child of 154
Thelma Fortier	child of 44
Tony	child of 143
Tyler David	child of 218
Valerie Marion Mary	201
Velma Winnifred	157
Vernon Harold	parent of spouse of 192
Vernon James Edward	142
Wallace Albert	parent of spouse of 46
Walter Colin	86
Walter Francis	child of 85
Ward Sneden	parent of spouse of 8
Wayne Douglas	child of 144
Wendy Lorraine	child of 173
William D.	child of 86
William Howard	93
William Malcolm	154
William Oliver	spouse of 8
William Oliver	parent of spouse of 37
William Oliver	child of 44
Zeddie Viola	spouse of 59
Wright-McKenzie	
Madison Lynn Adel	child of 224
Zwicker	
Carrie Anna	spouse of 129
Gertrude Rebecca	spouse of 128